

Survey in the Southeast Quarter of Section 4, Township 34 North, Range 2 East, W.M.
City of Anacortes, Washington

LEGAL DESCRIPTIONS

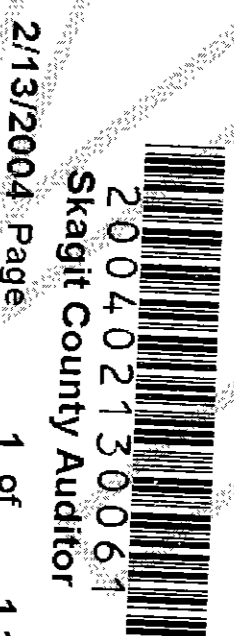

Parcel "A": The Southeast Quarter of the Northwest Quarter of the Southeast Quarter of Section 4, Township 34 North, Range 2 East, W.M., LESS the East 264 feet thereof AND LESS that portion conveyed to the State of Washington for highway purposes by deed recorded under Auditor's File No. 806881, Records of Skagit County, Washington.

Parcel "B": The East 264 feet of the Southeast Quarter of the Northwest Quarter of the Southeast Quarter, LESS County road, of Section 4, Township 34 North, Range 2 East, W.M.

Parcel "C": The Southwest Quarter of the Northwest Quarter of the Southeast Quarter of Section 4, Township 34 North, Range 2 East, W.M., EXCEPT the North 416 feet thereof, ALSO EXCEPT County roads.

All situate in the City of Anacortes, Skagit County, Washington.

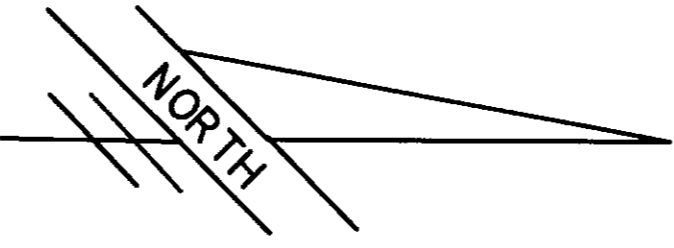

1"=100'

LEGEND

- Found mons in c/l SR 20
- Found MMA rebars set on prior short plat
- Found rebar/cap LS # 19645.
- Set rebar/cap "Mower-#21,520"

Located in NW/SE, Sec. 4, Twn 34 N., Rng 2 E., W.M.

Record of Survey For			
Golden Age Investments, LLC			
Scale: 1"=100'	Date: Feb, 2004	Job No: 04-02	
Drawn by: CHM	Chk'd by: MTM	Sheet 1 of 1	

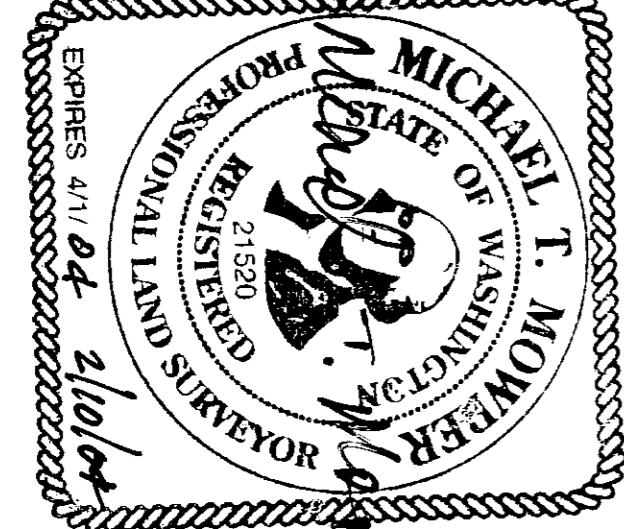

Survey Notes and Procedures
This survey was performed by standard field traverse with a 02" electronic total station and complies with the minimum required survey precision of 1:10,000 per WAC 130-130-090.
Basis of Bearings: Short Plat # ANA 03-04; AF# 200306200023
Survey references: Short plats # ANA 03-04; ANA 02-004; Surveys filed under AF# 200003240012, and 200009130101.
The triangle shaped portion of short plat # ANA 03-04 south of the highway may have been purchased by Golden Age and/or their partners. The area of said tract is not included in the areas shown for parcel A & B.
The South line of this survey was computed from the asbuilt location of Stevenson Road.
This survey relied upon control points established on prior surveys. Monuments were visited on 2/15/03. Corners were set 2/08/04.

Filed for record this 13 day of Feb 2004, at 11:38 AM
at the request of Mike Mower, Records of County, Wa.
MICHAEL T. MOWER
County Auditor or Deputy Auditor

This map correctly represents a survey made by me or under my direction in conformance with the requirements of the Survey Recording Act of the request of: Michael T. Mower in Feb 2004
MICHAEL T. MOWER
SURVEYOR'S CERTIFICATE

MICHAEL MOWER & ASSOCIATES
PROFESSIONAL SURVEYING SERVICES
17424 Mallard Cove Lane, Mount Vernon, Wa. 98274
(360) 422-6097

Record of Survey For			
Golden Age Investments, LLC			
Scale: 1"=100'	Date: Feb, 2004	Job No: 04-02	
Drawn by: CHM	Chk'd by: MTM	Sheet 1 of 1	