

Survey in Gov't Lot 1, (the NW1/4 of the NW1/4), of Section 18, Twp. 35 N., Rng. 5 E., W.M.

FOUND 2" IRON PIPE
WITH PLUG & TACK IN
CASE & COVER ON
FEBRUARY 18, 1992.

S89°10'10"W 2372.32'

1016.71'

1355.61'

FOUND CONCRETE
MONUMENT ON
NOVEMBER 12, 1980.

3.74 Acres

Legal Description

PARCEL A:

A portion of the North one third of Government Lot 1 in Section 18, Township 35 North, Range 5 East of the Willamette Meridian, less one half of county road along the West line thereof, described as follows:
Commencing at the Northwest corner of said Tract; Thence South along the West line thereof, 150 feet to point of beginning; Thence South along West line thereof, 125 feet; Thence East 346 feet; Thence North 125 feet; Thence West 346 feet, to the point of beginning.

PARCEL B:

The South 165 feet of the North 315 feet of the North one third of Government Lot 1 in Section 18, Township 35 North, Range 5 East of the Willamette Meridian;
EXCEPT the following described property:
A portion of the North one Third of Lot 1 of Section 18, Township 35 North, Range 5 East of the Willamette Meridian, less one half of county road along the West line thereof, described as follows:
Commencing at the Northwest corner of said Tract; Thence South along the West line thereof, 150 feet to point of beginning; Thence South along West line thereof, 125 feet; Thence East 346 feet; Thence North 125 feet; Thence West 346 feet, to the point of beginning.
ALSO EXCEPT State Highway 9 along the West boundary thereof.

Notes

1. Basis-of-bearings - Assumed S89°10'10"W on the north line of the northwest quarter of section 18.
2. This survey was accomplished by field traverse using: 3 second or better digital electronic total station, and meets or exceeds the standards contained in WAC 332-130-090.

Legend

- Set 1/2" x 18" reinforcing rod with yellow plastic cap marked "SKA SURV 17651" and white 2" x 2" witness stake, except as noted.

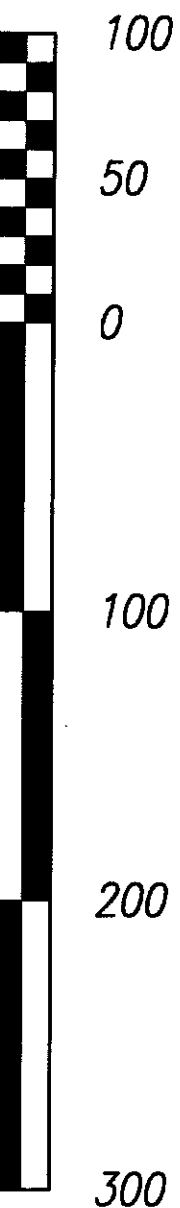

Scale in Feet

DATE

REVISION

BY

JOB#

203117

DRAWN

SRM

CHECKED

MMW

DATE

12DEC03

SCALE

1" = 100'

SHEET

1 OF 1

Survey for Ben Zomak

COPYRIGHT 2003 SKAGIT SURVEYORS, INC.

Skagit
Surveyors & Engineers

806 Metcalf St., Sedro-Woolley, WA 98284 Phone: (360) 855-2121 FAX: (360) 855-1658

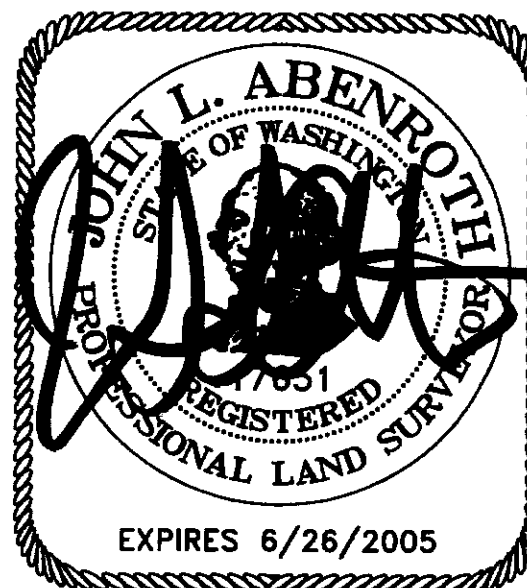

SURVEYOR'S CERTIFICATE

This map correctly represents a survey made by me or under my direction in conformance with the Survey Recording Act in December 2003 at the request of Ben Zomak

John L. Abenroth CERT#17651
Date 1/8/04

AUDITOR'S CERTIFICATE



200402040056
Skagit County Auditor

2/4/2004 Page 1 of 1 11:18AM

County Auditor of Deputy Auditor