

Return to:



200401090099
Skagit County Auditor

1/9/2004 Page 1 of 2 2:47PM

PROTECTED CRITICAL AREA SITE PLAN

Page 1 of 2

Grantor/Owner: Daniel & Linda Ballard

Grantee: PUBLIC

Site Address: 14313 Jura Drive

Property ID #: P 73620 Assessors Tax Account #: 4110-000-006-0003

Legal Description: Sec. 17 Twp. 34 Rng. 2 / Plat Name _____ Lot _____

Permit/Activity #: BP03-1518

The PROTECTED CRITICAL AREA (PCA) is to be left undisturbed in its natural state. "With the exception of activities identified as Allowed without Standard review under SCC 14.24.100, any land-use activity that can impair the functions and values of critical areas or their buffers through a development activity or by disturbance of the soil or water, and/or by removal of, or damage to, existing vegetation shall require critical areas review and written authorization pursuant to SCC 14.24." SCC 14.24.060 No clearing, grading, filling, logging or removal of woody material, building, construction or road construction of any kind, planting of non-native vegetation or grazing of livestock is allowed within the PCA areas except as specifically permitted by Skagit County on a case-by-case basis consistent with SCC 14.24.

Representations on this site plan may be approximations only and should not be used for purposes other than for determining general locations of critical areas. Development activities beyond the scope of this plan may require additional studies and approvals.

The above references to "Grantor" and "Grantee" shall not be construed as a transfer of property ownership and are used solely for filing with the County Auditor.

Owner: Daniel Ballard Date: 1/9/04

On this day personally appeared before me Daniel Ballard known to be the individual described herein and acknowledged to me that he signed the same as his free and voluntary act and deed for the uses and purposes therein mentioned.

Mary Mearns, Notary Public in and for the State of Washington, residing at Mount Vernon Date: 4th Jan 9 2004

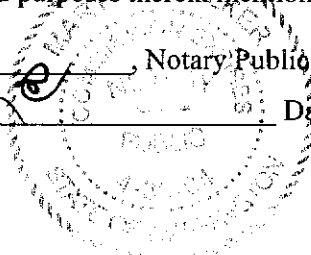

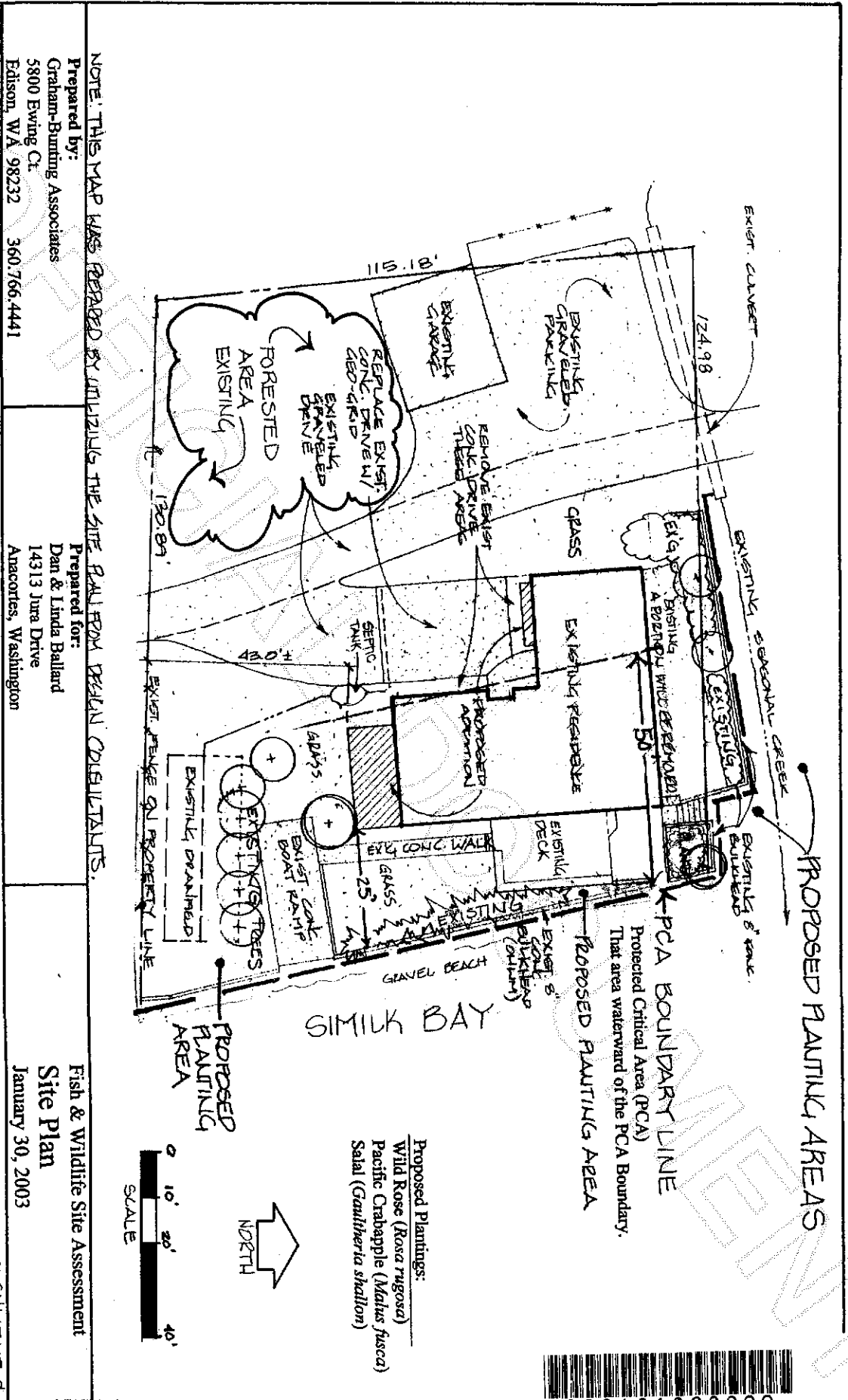

- Proposed Plantings:
- Wild Rose (*Rosa rugosa*)
 - Pacific Crabapple (*Malus fusca*)
 - Sisal (*Gaultheria shallon*)



NOTE: THIS MAP WAS PREPARED BY UTILIZING THE SITE PLAN FROM DEKIN CONSULTANTS.
 Prepared by:
 Graham-Bunting Associates
 5800 Ewing Ct
 Edison, WA 98232 360.766.4441

Prepared for:
 Dan & Linda Ballard
 14313 Jura Drive
 Anacortes, Washington

Fish & Wildlife Site Assessment
 Site Plan
 January 30, 2003

OAD Approved 12/17/03 Leah Fisher

ATTACHMENT C



200401090099
 Skagit County Auditor