



200312100098
Skagit County Auditor

12/10/2003 Page 1 of 2 1:33PM

Return to:

Martha Summers
14928 Summers Ln
Mt. Vernon WA 98273

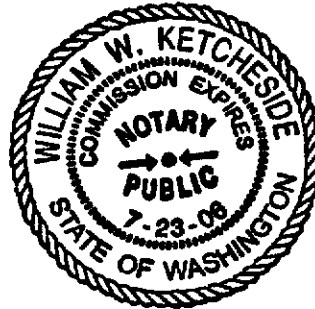

PROTECTED CRITICAL AREA SITE PLAN

Page 1 of 2

Grantor/Owner: Martha Summers

Grantee: PUBLIC

Site Address: 14928 Summers Lane

Property ID #: P 82411 Assessors Tax Account #: 4437.000.003.0002

Legal Description: Sec. 9 Twp. 33 Rng. 3 / Plat Name Summers Ridge Lot 3

Permit/Activity #: BPO3-1223

The PROTECTED CRITICAL AREA (PCA) is to be left undisturbed in its natural state. "With the exception of activities identified as Allowed without Standard review under SCC 14.24.100, any land-use activity that can impair the functions and values of critical areas or their buffers through a development activity or by disturbance of the soil or water, and/or by removal of, or damage to, existing vegetation shall require critical areas review and written authorization pursuant to SCC 14.24." SCC 14.24.060 No clearing, grading, filling, logging or removal of woody material, building, construction or road construction of any kind, planting of non-native vegetation or grazing of livestock is allowed within the PCA areas except as specifically permitted by Skagit County on a case-by-case basis consistent with SCC 14.24.

Representations on this site plan may be approximations only and should not be used for purposes other than for determining general locations of critical areas. Development activities beyond the scope of this plan may require additional studies and approvals.

The above references to "Grantor" and "Grantee" shall not be construed as a transfer of property ownership and are used solely for filing with the County Auditor.

Owner: Martha Summers Date: Dec 5, 2003

On this day personally appeared before me MARTHA SUMMERS known to be the individual described herein and acknowledged to me that SHE signed the same as her free and voluntary act and deed for the uses and purposes therein mentioned.

William W. Ketcheside, Notary Public in and for the State of Washington,

residing at MOUNT VERNON Date: 12-5-03

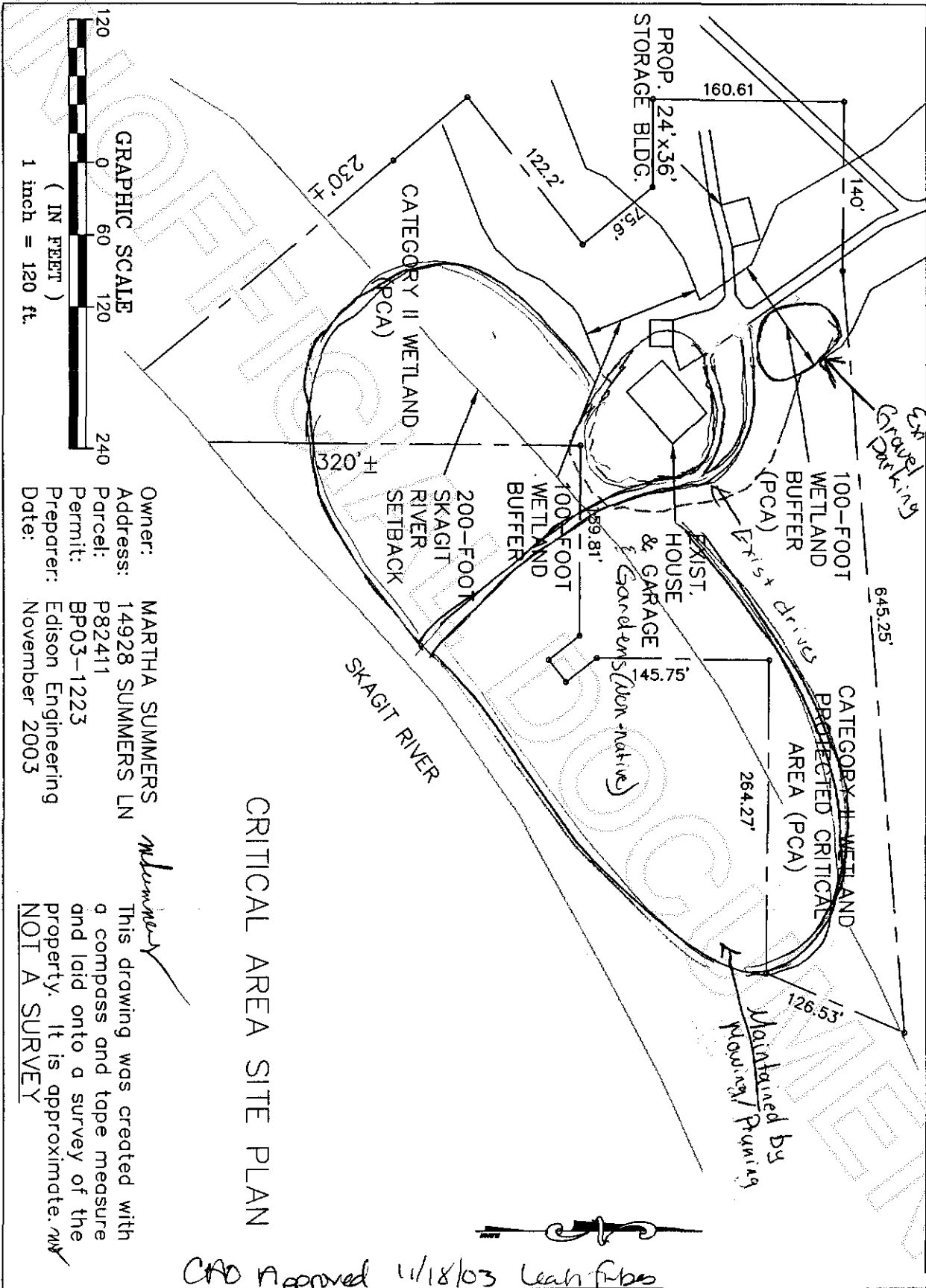

GRAPHIC SCALE
 (IN FEET)
 1 inch = 120 ft.

Owner: MARTHA SUMMERS
 Address: 14928 SUMMERS LN
 Parcel: P82411
 Permit: BP03-1223
 Preparer: Edison Engineering
 Date: November 2003

CRITICAL AREA SITE PLAN

This drawing was created with a compass and tape measure and laid onto a survey of the property. It is approximate. *mw*
 NOT A SURVEY

CAD Approved 11/18/03 Leah Fries



200312100098
 Skagit County Auditor