

Return to:



200310020159  
Skagit County Auditor

10/2/2003 Page 1 of 2 10:43AM

**PROTECTED CRITICAL AREA SITE PLAN**

Page 1 of 2

Grantor/Owner: Melita Townsend

Grantee: PUBLIC

Site Address: 5119 Guemes Island Road

Property ID #: P 61710 Assessors Tax Account #: 3855000.005.0005

Legal Description: Sec. 36 Twp. 36 Rng. 1 / Plat Name Alverson's Camp Lot 5

Permit/Activity #: BPO3-1065 Trs

The PROTECTED CRITICAL AREA (PCA) is to be left undisturbed in its natural state. "With the exception of activities identified as Allowed without Standard review under SCC 14.24.100, any land-use activity that can impair the functions and values of critical areas or their buffers through a development activity or by disturbance of the soil or water, and/or by removal of, or damage to, existing vegetation shall require critical areas review and written authorization pursuant to SCC 14.24." SCC 14.24.060 No clearing, grading, filling, logging or removal of woody material, building, construction or road construction of any kind, planting of non-native vegetation or grazing of livestock is allowed within the PCA areas except as specifically permitted by Skagit County on a case-by-case basis consistent with SCC 14.24.

Representations on this site plan may be approximations only and should not be used for purposes other than for determining general locations of critical areas. Development activities beyond the scope of this plan may require additional studies and approvals.

The above references to "Grantor" and "Grantee" shall not be construed as a transfer of property ownership and are used solely for filing with the County Auditor.

Owner: Melita Townsend Date: 2 Oct 03

On this day personally appeared before me Melita Townsend the individual described herein and acknowledged to me that she signed the same as a free and voluntary act and deed for the uses and purposes therein mentioned.

Mary E. Kief, Notary Public in and for the State of Washington,  
residing at Anacortes, WA Date: 10/2/03

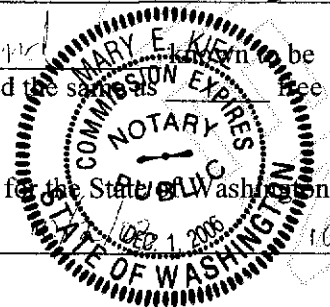

Fish and Wildlife Assessment



Sept 24, 2003

Melita Townsend

Property Address: 5119 Guemes Island Road

Guemes Island, WA 98221

Rupert Schmitt, consultant, 802-C 24<sup>th</sup> Street, Anacortes, WA 98221

Scale: 1 inch=30 feet

30

79.3 foot Critical Area Setback(buffer)

Staff Signature *Leah Jones 9/30/03*

*CHO Approved*

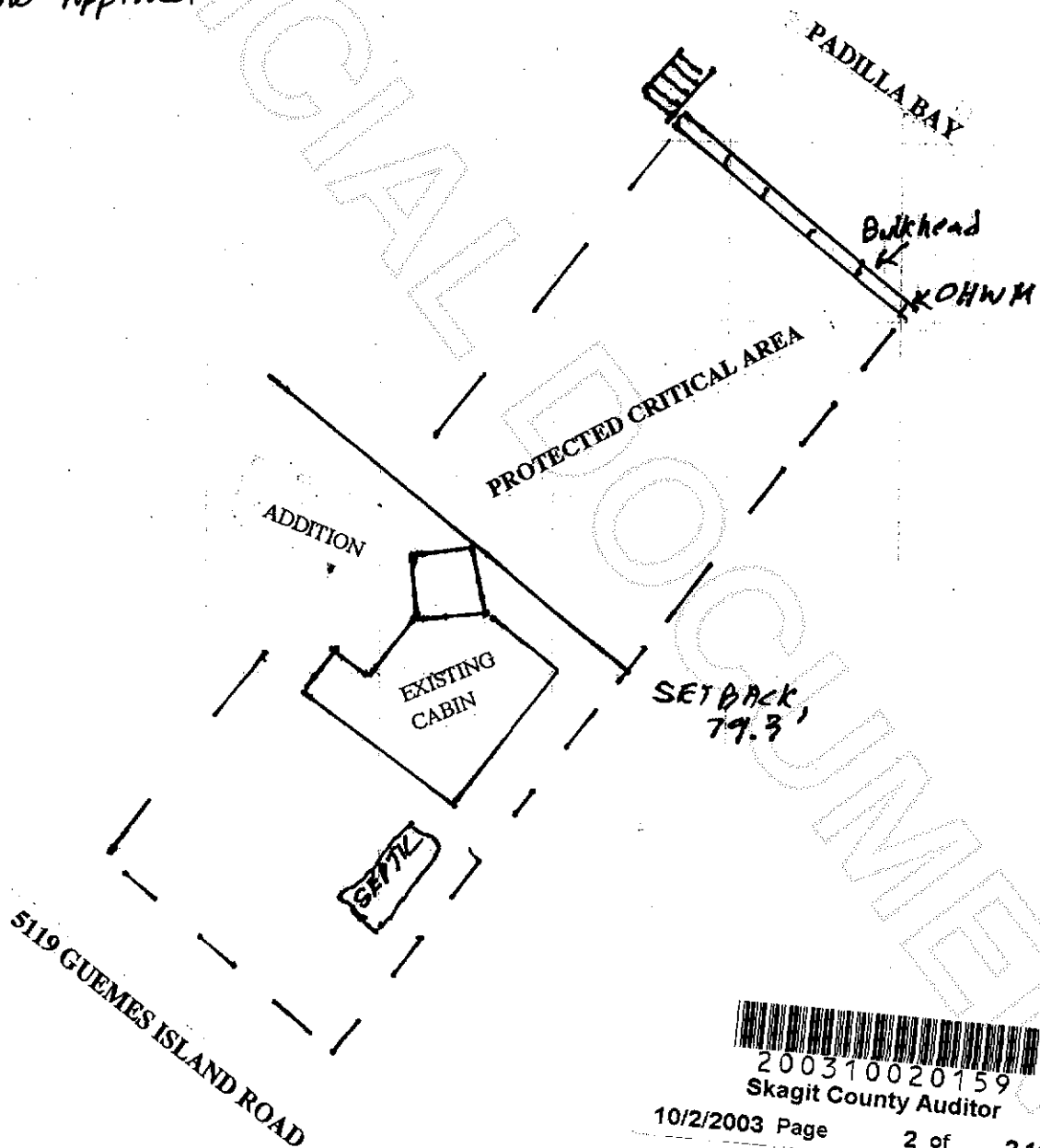

200310020159  
Skagit County Auditor