

LEGEND:  
 ⊕ EXISTING 1/4 CORNER MONUMENT IN CASE  
 ⊕ EXISTING MONUMENT IN CASE  
 ● REBAR WITH PLASTIC CAP SET  
 ○ FOUND IRON PIPE

NOTES:  
 1. ALL DISTANCES IN PARENTHESIS ARE OF RECORD DATA.

REFERENCES:

1. ROS, POR. OF GOV. LOT 2, (NE 1/4) SECTION 21, T. 34 N., R. 2 E., W.M. AF #9503090035, PREPARED BY LEONARD, BOUDINOT AND SKODJE INC.
2. ASSESSOR'S PLAT OF KIKET VIEW, PTN. GOVT. LOT 2, SEC. 21, T. 34 N., R. 2 E. W.M., AF #740101, PREPARED BY WAYNE D. LEGRON.
3. ROS, PTN. GOVT. LOT 3, SEC. 21, T. 34 N., R. 2 E. W.M., AF #8308020003, PREPARED BY LEGRON & JUDY.

LEGAL DESCRIPTION:

LOT B, "ASSESSOR'S PLAT OF KIKET VIEW," AS PER PLAT RECORDED IN VOLUME 9 OF PLATS, PAGE 95, RECORDS OF SKAGIT COUNTY, WASHINGTON.

TOGETHER WITH A NON-EXCLUSIVE EASEMENT FOR INGRESS AND EGRESS OVER THE SOUTH 25 FEET OF TRACTS B, D, E, F, G AND H IN SAID PLAT AND OVER TRACT C, IN SAID PLAT.

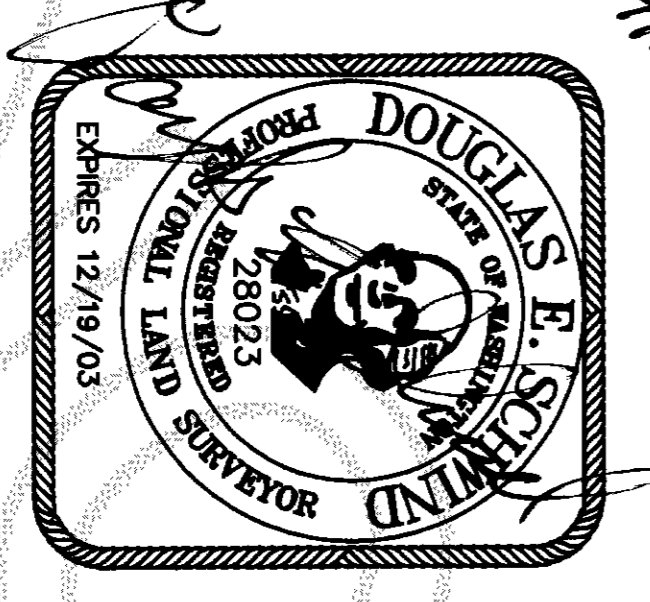

**SURVEYOR'S CERTIFICATE**  
 THIS MAP CORRECTLY REPRESENTS A SURVEY MADE BY ME OR UNDER MY DIRECTION IN CONFORMANCE WITH THE REQUIREMENTS OF THE SURVEY RECORDING ACT AT THE REQUEST OF:  
 WAYNE JOHNSTON  
 IN SEPT., 2003  
 CERTIFICATE NO. 28023

**SURVEYOR INSTRUMENTATION**  
 THEODOLITE: GEODIMETER 610  
 SERIAL 61010236, STD DEV 3",  
 EDM ± (5MM + 5PPM)  
**SURVEYING PROCEDURE**  
 FIELD TRAVERSE:  
 LINEAR AND ANGULAR MEASUREMENTS MEET OR EXCEED STANDARDS SET IN WAC 352-130-090

**BASIS OF BEARING**  
 EAST LINE OF THE NE 1/4 OF SECTION 21,  
 TOWNSHIP 34 NORTH, RANGE 02 EAST W.M.,  
 AS SHOWN IN ASSESSOR'S PLAT OF KIKET VIEW,  
 AF #740161, RECORDS OF SKAGIT CO.

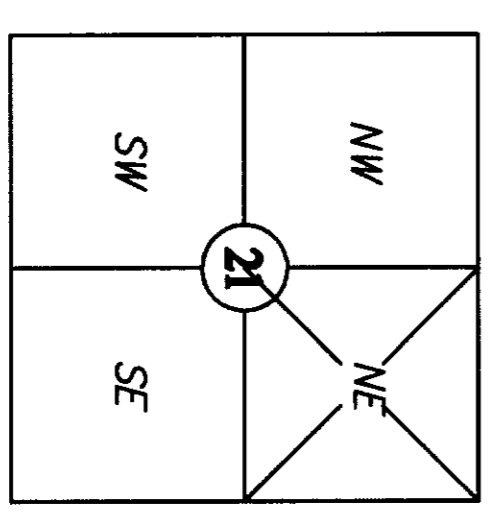

**RECORDING CERTIFICATE**

FILED FOR RECORD AT THE REQUEST OF Wayne Johnston & Design  
 THIS 11 DAY OF Sept 2003 AT 9:08 AM AND RECORDED  
 UNDER AUDITOR'S FILE NO. 280309110015 RECORDS OF  
 SKAGIT COUNTY, WASHINGTON.  
 DEPUTY Wayne Johnston COUNTY AUDITOR



**NORTHWEST DATUM & DESIGN**  
 CIVIL ENGINEERING AND SURVEYING SOLUTIONS

160 CASCADE PLACE, SUITE 102  
 BURLINGTON, WASHINGTON 98233  
 PH: (360) 404-2020 FAX: (360) 404-2021

**RECORD OF SURVEY**

Lot B of Assessor's Plat of Kiket View  
 SURVEY in a portion of the NE 1/4 of  
 Section 21, T. 34 N., R. 2 E. WM  
 for:  
**WAYNE JOHNSTON**  
 in LaConner, Washington

PROJECT	03086
DRAWING	03086.dwg
DRAWN BY	fsb
CHECKED BY	des
DATE	8/9/2003
<b>SHEET 1 OF 1</b>	