

Return to:



200210280191
Skagit County Auditor

10/28/2002 Page 1 of 3 1:52PM

PROTECTED CRITICAL AREA SITE PLAN

Page 1 of 2

Grantor/Owner: Phyllis Woolworth

Grantee: PUBLIC

Site Address: 4217 Forest Lane

Property ID #: P 108024 Assessors Tax Account #: 360126-1-001-0600

Legal Description: Sec. 24 Twp. 36 Rng. 1 / Plat Name _____ Lot _____

Permit/Activity #: PL00-0397

PROTECTED CRITICAL AREA (PCA) is to be left undisturbed in a natural state. No clearing, grading, filling, logging or removal of woody material, building, construction or road construction of any kind or planting of non-native vegetation is allowed within the PCA areas except as specifically permitted by Skagit County on a case-by-case basis consistent with Skagit County Code 14.24.

Representations on this site plan may be approximations only and should not be used for purposes other than for determining general locations of critical areas. Development activities beyond the scope of this plan may require additional studies and approvals.

The above references to "Grantor" and "Grantee" shall not be construed as a transfer of property ownership and are used solely for filing with the County Auditor.

Owner: Phyllis A Woolworth Date: 7-26-02

On this day personally appeared before me _____ known to be the individual described herein and acknowledged to me that _____ signed the same as _____ free and voluntary act and deed for the uses and purposes therein mentioned.

_____, Notary Public in and for the State of Washington,
residing at _____ Date: _____

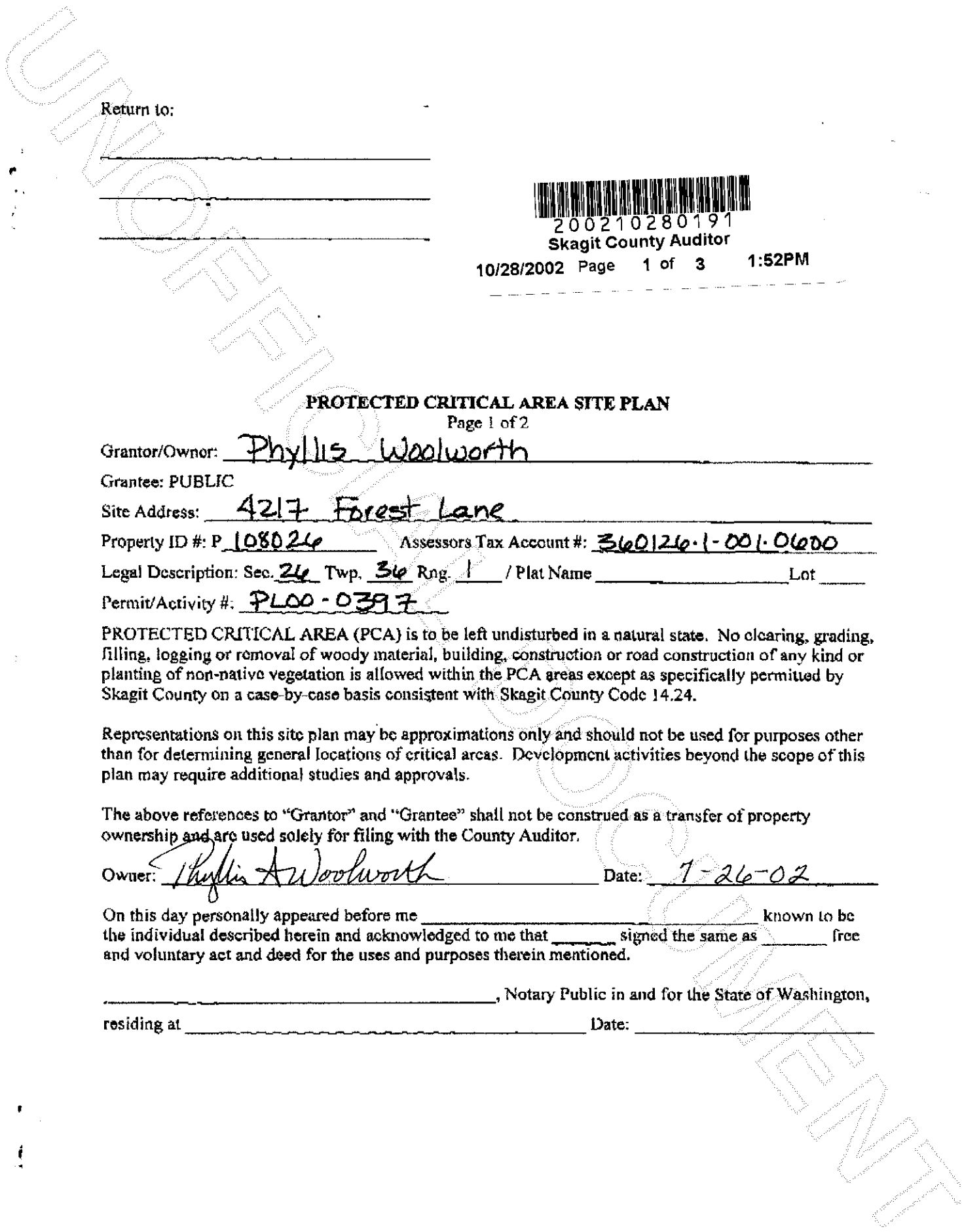

CALIFORNIA ALL-PURPOSE ACKNOWLEDGMENT

State of California }
County of Monterey } ss.

On July 26, 2002 before me, Ramona J. Mason
Date Name and Title of Officer (e.g., "Jane Doe, Notary Public")
personally appeared Phyllis Ann Washworth
Name(s) of Signer(s)

personally known to me
 proved to me on the basis of satisfactory evidence

to be the person(s) whose name(s) is/are subscribed to the within instrument and acknowledged to me that he/she/they executed the same in his/her/their authorized capacity(ies), and that by his/her/their signature(s) on the instrument the person(s), or the entity upon behalf of which the person(s) acted, executed the instrument.

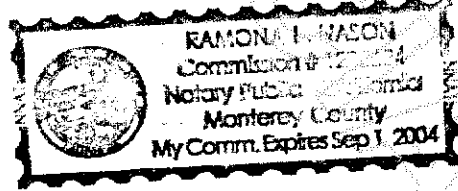

WITNESS my hand and official seal.
Ramona J. Mason
Signature of Notary Public

OPTIONAL

Though the information below is not required by law, it may prove valuable to persons relying on the document and could prevent fraudulent removal and reattachment of this form to another document.

Description of Attached Document

Title or Type of Document: Protected Critical Area Site Plan
Document Date: 7/26/02 Number of Pages: 1
Signer(s) Other Than Named Above: _____

Capacity(ies) Claimed by Signer

Signer's Name: _____
 Individual
 Corporate Officer — Title(s): _____
 Partner — Limited General
 Attorney-in-Fact
 Trustee
 Guardian or Conservator
 Other: _____

Signer Is Representing: _____

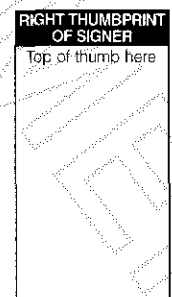

UNCLASSIFIED

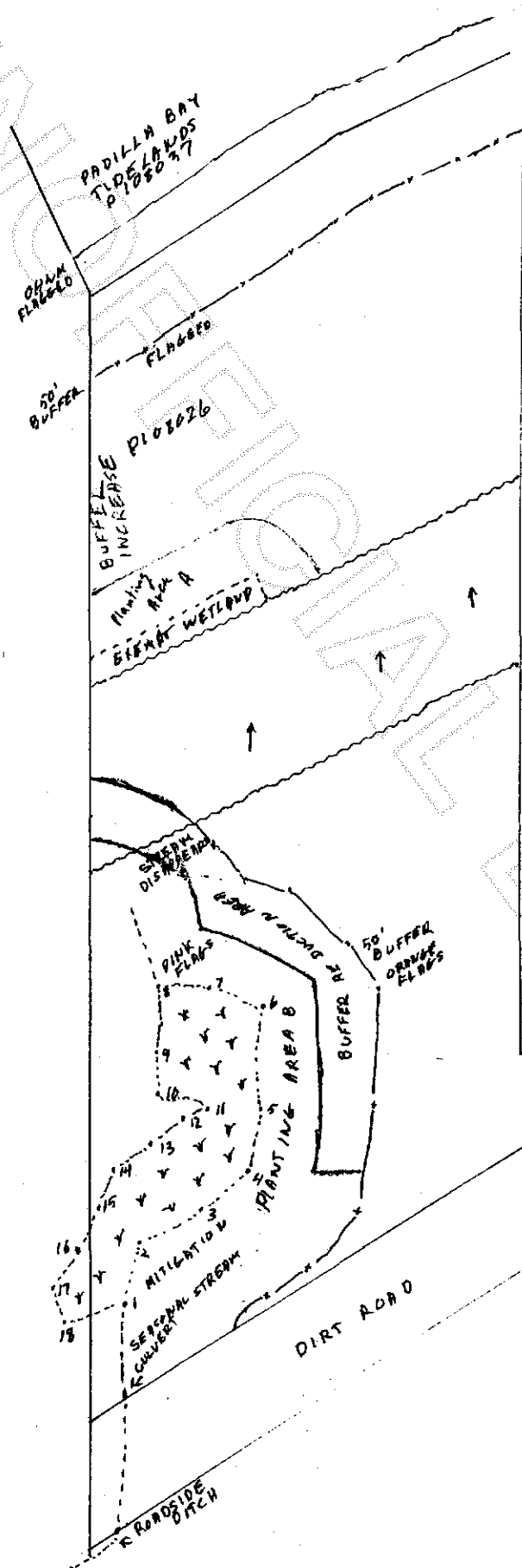

WETLAND DELINEATION & F & W ASSESSMENT
 MAY 7, 2002
 PHYLLIS A. WOOLWORTH, 2857 Congress Road,
 Pebble Beach, CA 93953
 Property Address: GUEMES ISLAND ROAD
 P108026 & P 108037
 Anacortes, WA
 Rupert Schmitt, consultant, 802-C 24th Street,
 Anacortes, WA 98221
 Scale: 1 inch=40 feet

* * * * * 50 foot Setback(buffer)
 wetland edge
 Map hand measured. Not accurate to 5 feet. Dirt road location estimated
 Staff Signature *Phyllis Woolworth* 10/18/02

