

Return to:

PETER JONES
3701 E. HOWE
SEATTLE WA. 98112



200209030134

Skagit County Auditor

9/3/2002 Page 1 of 2 3:38PM

PROTECTED CRITICAL AREA SITE PLAN

Page 1 of 2

Grantor/Owner: Peter & Robin Jones

Grantee: PUBLIC

Site Address: 34787 South Shore Drive

Property ID #: P 66502 Assessors Tax Account #: 3938-001-020-0005

Legal Description: Sec. 24 Twp. 33 Rng. 6 / Plat Name Lk Cav Sub Div 2 Lot 20

Permit/Activity #: PL02-0404 B1K1

PROTECTED CRITICAL AREA (PCA) is to be left undisturbed in a natural state. No clearing, grading, filling, logging or removal of woody material, building, construction or road construction of any kind or planting of non-native vegetation is allowed within the PCA areas except as specifically permitted by Skagit County on a case-by-case basis consistent with Skagit County Code 14.24.

Representations on this site plan may be approximations only and should not be used for purposes other than for determining general locations of critical areas. Development activities beyond the scope of this plan may require additional studies and approvals.

The above references to "Grantor" and "Grantee" shall not be construed as a transfer of property ownership and are used solely for filing with the County Auditor.

Owner: Peter Jones / Robin Jones Date: 8/30/02

On this day personally appeared before me PETER AND ROBIN JONES known to be the individual described herein and acknowledged to me that they signed the same as THEIR free and voluntary act and deed for the uses and purposes therein mentioned.

Warren G. Otteson, Notary Public in and for the State of Washington,
residing at Mount Vernon, Wa Date: 8/30/02

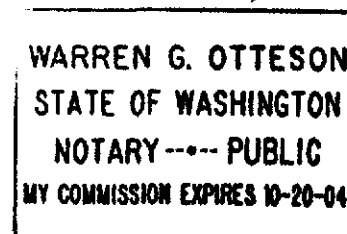
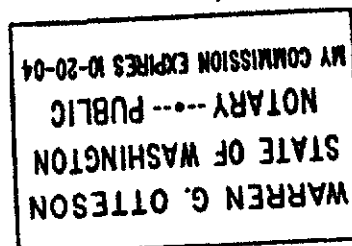

CRITICAL AREA SITE PLAN

LAKE CAVANAUGH

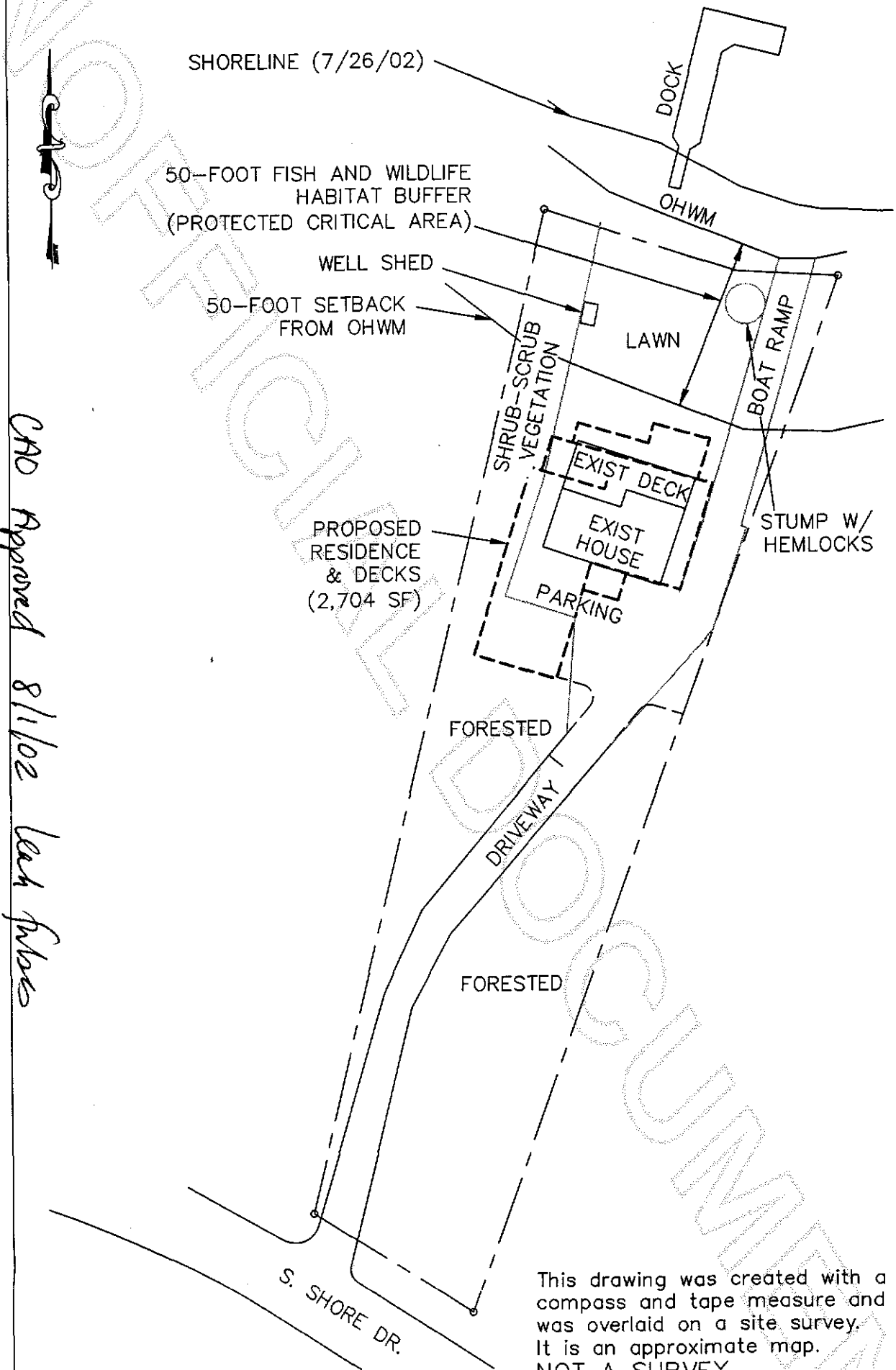

CAD Approved 8/1/02 Leah Jones

This drawing was created with a compass and tape measure and was overlaid on a site survey. It is an approximate map.
NOT A SURVEY

Owners: Peter Jones
Address: 34787 S. Shore Dr.
Parcel: P66502
Permit: PL02-0404
Preparer: Edison Engineering
Date: July, 2002

