

**LEGEND:**

- = SET 1/2" REBAR WITH YELLOW CAP MARKED "B.V. 37549"
- = FOUND SURVEY MARKER AS NOTED
- X—X— = EXISTING FENCE LINE
- IR = IRON ROD

**BASIS OF BEARING:**

THE BASIS OF BEARING IS THE LINE BETWEEN THE FOUND MONUMENTS AT THE EAST 1/4 CORNER AND THE CENTER OF SECTION 31 AS S 88° 53' 22" E.

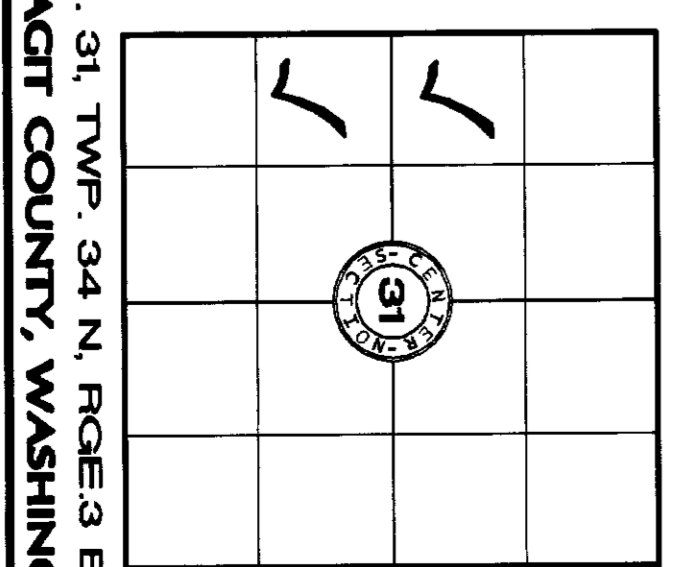

SEC. 31, TWP. 34 N., RGE. 3 E., W.M. SKAGIT COUNTY, WASHINGTON

**SURVEYORS CERTIFICATE**

THIS MAP CORRECTLY REPRESENTS A SURVEY MADE BY ME OR UNDER MY DIRECTION IN CONFORMANCE WITH THE REQUIREMENTS OF THE SURVEY RECORDING ACT, AT THE REQUEST OF CITY OF LA CONNER

RICK L. HOLT, P.L.S.  
 DATE 7/31/02

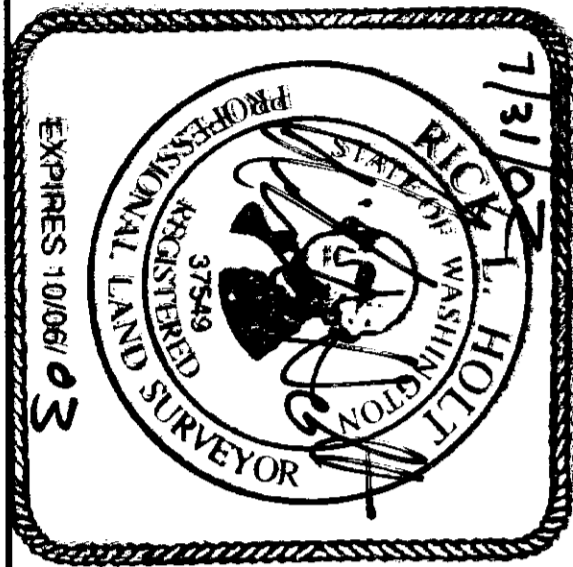

**AUDITORS CERTIFICATE**

FILED FOR RECORD THIS 14 DAY OF August 2002, AT 8:50 A.M. AT THE REQUEST OF BAYVIEW SURVEYING INC. UNDER AUDITOR'S FILE NO. 200208070013

Norma Blummett  
 SKAGIT COUNTY AUDITOR

**RECORD OF SURVEY**

**CITY OF LA CONNER**

A PORTION OF THE SOUTHWEST 1/4 OF SECTION 31, TOWNSHIP 34 NORTH, RANGE 3 EAST, W.M.  
 DWN BY: KVC DATE: JULY 29, 2002  
 FIELD BOOK: 12 PAGE: 55 & 57  
 BAYVIEW SURVEYING INC.  
 130 SHARON AVENUE, BURLINGTON, WA 98233  
 (360) 707-2580 FAX (360) 757-3976  
 SCALE: 1" = 100'  
 JOB NO. 2002-01

**LEGAL DESCRIPTION:**  
 (AUDITOR'S FILE NO. 20011280062)

TRACT 1, ACCORDING TO THE MAP TITLED "PLATE NO. 20, TIDE AND SHORE LANDS OF SECTIONS 6 & 31, TOWNSHIP 33 AND 34 NORTH, RANGE 3 EAST W.M. 'LA CONNER HARBOR' DATED APRIL, 1893, BEING THE OFFICIAL PLAT OF SAID TIDELANDS ON FILE IN THE OFFICE OF THE COMMISSIONER OF PUBLIC LANDS AT OLYMPIA, WASHINGTON,

TOGETHER WITH TRACT 2, AS SHOWN ON SAID MAP.

TOGETHER WITH ALL THAT PORTION OF TRACT NO. 3, AS SHOWN ON SAID MAP, LYING SOUTHERLY OF THE SOUTH RIGHT-OF-WAY OF CHILBERG ROAD.

ALL BEING A PORTION OF GOVERNMENT LOT 2, SECTION 31, TOWNSHIP 34 NORTH, RANGE 3 EAST W.M.

SITUATE IN SKAGIT COUNTY, WASHINGTON.

**OCCUPATIONAL INDICATORS & EXISTING FENCELINE NOTE:**

THIS SURVEY DEPICTS EXISTING FENCE LINES AND OTHER LINES OF OCCUPATION IN ACCORDANCE WITH W.A.C. 33.2130. THESE OCCUPATIONAL INDICATORS MAY INDICATE POTENTIAL FOR CLAIMS OF UNWRITTEN LEGAL OWNERSHIP. LEGAL OWNERSHIP BASED UPON UNWRITTEN TITLE CLAIMS HAS NOT BEEN ADDRESSED BY THIS BOUNDARY SURVEY.

**NOTES:**

1. THIS SURVEY WAS PERFORMED IN THE FIELD USING A LEICA TOTAL STATION (ELECTRONIC DISTANCE MEASURING THEODOLITE).
2. A CURRENT TITLE REPORT WAS NOT USED FOR THE REPORT OF THIS SURVEY. THIS SURVEY DOES NOT PURPORT TO SHOW AETS OR CONDITIONS WHICH MAY AFFECT THE PARCELS SHOWN HEREON.

**REFERENCE SURVEYS:**

1. MAP TITLED EXHIBIT OF SULLIVAN SLOUGH TIDELANDS, LA CONNER, WA FOR THE PORT OF SKAGIT COUNTY BY LEONARD, BOUNDNOT AND SKODJE INC. DATED SEPTEMBER 1995.
2. MAP TITLED EXHIBIT OF SULLIVAN SLOUGH LEASE AREA AND EASEMENT FOR THE PORT OF SKAGIT COUNTY BY LEONARD, BOUNDNOT AND SKODJE INC.
3. RECORD OF SURVEY RECORDED IN BOOK 1 OF SURVEYS, PAGE 64, AUDITOR'S FILE NO. 803204, RECORDS OF SKAGIT COUNTY.
4. RECORD OF SURVEY RECORDED IN VOLUME 9 OF SHORT PLATS, PAGE 277 & 278, RECORDS OF SKAGIT COUNTY.