

Survey in the NW1/4 of the SE1/4 and in the NE1/4 of the SE1/4 of Section 7, Twp. 36 N., Rng. 4 E., W.M.

Legal Description

COMPUTED FROM SURVEY
RECORDED IN VOLUME 8
OF SURVEYS AT PAGE 71.

NEW LOT 4 AFTER BOUNDARY LINE ADJUSTMENT AT #200104180092.
THAT PORTION OF LOT 4, LOT 5 AND LOT 6, PLAT OF ALGER, SKAGIT COUNTY WASHINGTON, FILED IN VOLUME 4 OF PLATS AT PAGE 9, DESCRIBED AS FOLLOWS: COMMENCING AT THE INTERSECTION OF THE NORTH LINE OF SAID LOT 6 AND THE NORTHEASTERLY RIGHT OF WAY LINE OF OLD HIGHWAY 99 AS SHOWN ON SURVEY FILED IN VOLUME 19 OF SURVEYS AT PAGE 190, UNDER SKAGIT COUNTY AUDITOR'S FILE NUMBER 9710150048, THENCE S35°55'58"E ALONG SAID RIGHT OF WAY, A DISTANCE OF 34.80 FEET TO THE POINT OF BEGINNING OF THIS DESCRIPTION; THENCE N89°04'51"E PARALLEL WITH THE NORTH LINE OF SAID LOT 6, A DISTANCE OF 80.64 FEET; THENCE S22°49'40"E, A DISTANCE OF 163.00 FEET TO THE SOUTH LINE OF THE PROPERTY SHOWN ON SAID SURVEY; THENCE S88°54'18"W ALONG SAID SOUTH LINE, A DISTANCE OF 265.11 FEET TO THE POINT OF BEGINNING OF THIS DESCRIPTION; THENCE S88°54'18"W ALONG SAID SOUTH LINE, A DISTANCE OF 131.45 FEET TO THE NORTHEASTERLY RIGHT OF WAY LINE OF SAID OLD HIGHWAY 99, THENCE N35°55'58"W ALONG SAID RIGHT OF WAY LINE, A DISTANCE OF 265.11 FEET TO THE POINT OF BEGINNING OF THIS DESCRIPTION, SUBJECT TO A NON-EXCLUSIVE EASEMENT FOR INGRESS, EGRESS AND UTILITIES OVER, UNDER AND THROUGH THAT PORTION OF THE ABOVE DESCRIBED PREMISES LYING WITHIN THE NORTH 35 FEET OF SAID LOT 6.

NEW LOT 5 AFTER BOUNDARY LINE ADJUSTMENT AT #200104180092.
THAT PORTION OF LOT 4, LOT 5 AND LOT 6, PLAT OF ALGER, SKAGIT COUNTY WASHINGTON, FILED IN VOLUME 4 OF PLATS AT PAGE 9, DESCRIBED AS FOLLOWS: BEGINNING AT THE INTERSECTION OF THE NORTH LINE OF SAID LOT 6 AND THE NORTHEASTERLY RIGHT OF WAY LINE OF OLD HIGHWAY 99 AS SHOWN ON SURVEY FILED IN VOLUME 19 OF SURVEYS AT PAGE 190, UNDER SKAGIT COUNTY AUDITOR'S FILE NUMBER 9710150048, THENCE S35°55'58"E ALONG SAID RIGHT OF WAY, A DISTANCE OF 34.80 FEET; THENCE N89°04'51"E PARALLEL WITH THE NORTH LINE OF SAID LOT 6, A DISTANCE OF 195.62 FEET; THENCE S36°40'43"E, A DISTANCE OF 80.64 FEET; THENCE S22°49'40"E, A DISTANCE OF 163.00 FEET TO THE SOUTH LINE OF THE PROPERTY SHOWN ON SAID SURVEY; THENCE N88°54'18"W ALONG SAID SOUTH LINE, A DISTANCE OF 185.64 FEET; THENCE N35°55'59"W, A DISTANCE OF 298.65 FEET TO THE NORTH LINE OF SAID LOT 6; THENCE S89°04'51"E ALONG SAID NORTH LINE, A DISTANCE OF 337.81 FEET TO THE POINT OF BEGINNING OF THIS DESCRIPTION. TOGETHER WITH A NON-EXCLUSIVE EASEMENT FOR INGRESS, EGRESS AND UTILITIES OVER, UNDER AND THROUGH THAT PORTION OF THE NORTH 35 FEET OF SAID LOT 6 LYING OUTSIDE OF AND ON THE WEST SIDE OF THE ABOVE DESCRIBED PARCEL. SUBJECT TO A NON-EXCLUSIVE EASEMENT FOR INGRESS, EGRESS AND UTILITIES OVER, UNDER AND THROUGH THAT PORTION OF THE NORTH 35 FEET OF THE ABOVE DESCRIBED PARCEL.

NEW LOT 6 AFTER BOUNDARY LINE ADJUSTMENT AT #200104180092.
THAT PORTION OF LOT 4, LOT 5 AND LOT 6, PLAT OF ALGER, SKAGIT COUNTY WASHINGTON, FILED IN VOLUME 4 OF PLATS AT PAGE 9, LYING EASTERLY OF THE FOLLOWING DESCRIBED LINE: COMMENCING AT THE INTERSECTION OF THE NORTH LINE OF SAID LOT 6 AND THE NORTHEASTERLY RIGHT OF WAY LINE OF OLD HIGHWAY 99 AS SHOWN ON SURVEY FILED IN VOLUME 19 OF SURVEYS AT PAGE 190, UNDER SKAGIT COUNTY AUDITOR'S FILE NUMBER 9710150048, THENCE S35°55'58"E ALONG SAID RIGHT OF WAY, A DISTANCE OF 34.80 FEET; THENCE N89°04'51"E PARALLEL WITH THE NORTH LINE OF SAID LOT 6, A DISTANCE OF 195.62 FEET; THENCE S36°40'43"E, A DISTANCE OF 80.64 FEET; THENCE S22°49'40"E, A DISTANCE OF 163.00 FEET TO THE SOUTH LINE OF THE PROPERTY SHOWN ON SAID SURVEY; THENCE N88°54'18"W ALONG SAID SOUTH LINE, A DISTANCE OF 185.64 FEET; THENCE N35°55'59"W, A DISTANCE OF 298.65 FEET TO THE NORTH LINE OF SAID LOT 6 AND TERMINUS OF THIS LINE DESCRIPTION, TOGETHER WITH A NON-EXCLUSIVE EASEMENT FOR INGRESS, EGRESS AND UTILITIES OVER, UNDER AND THROUGH THAT PORTION OF THE NORTH 35 FEET OF SAID LOT 6 LYING WESTERLY OF THE ABOVE DESCRIBED LINE.

127°7' S86°58'30"E
2872.75'

N00°30'36"W
2718.66'

1263.40'

S86°58'30"E
2526.79'

1263.40'

1191.66'

#	LINE	BEARING	DISTANCE
L1	N89°04'51"E	6.00'	
L2	S36°40'43"E	6.00'	
L3	S88°54'18"W	1.45'	
L4	N35°55'58"W	34.80'	
L5	N89°04'51"E	22.81'	
L6	S88°54'18"W	22.09'	
L7	S88°54'18"W	24.37'	

Notes

1. BASIS-OF-BEARINGS - ASSUMED N00°47'30"W ON THE EAST LINE OF THE SOUTHEAST QUARTER OF SECTION 7.
2. THIS SURVEY WAS ACCOMPLISHED BY FIELD TRAVERSE USING 3 SECOND OR BETTER DIGITAL ELECTRONIC TOTAL STATION, 320 METERS OR EXCEEDS THE STANDARDS CONTAINED IN WAC 332-130-090.
3. FOR ADDITIONAL INFORMATION SEE SURVEY RECORDED IN VOLUME 19 OF SURVEYS AT PAGE 190 UNDER SKAGIT COUNTY AUDITOR'S FILE NUMBER 9710150048.

COMPUTED POSITION USING
RECORD ANGLE AND
DISTANCE FROM FOUND
IRON PIPE AT THE EAST
1/16 CORNER OF THE
SOUTHEAST 1/4 PER
SHORT PLAT NO. 13-82
SET CONCRETE MONUMENT
ON 12/13/83.

Legend

SET 1/2" x 18" REINFORCING
ROD WITH YELLOW PLASTIC CAP
MARKED "SKA SURV. 17651" AND
WHITE 2" x 2" WITNESS STAKE.
EXCEPT AS NOTED.

SET 1/2" x 18" REINFORCING
ROD WITH YELLOW PLASTIC CAP
MARKED "SKA SURV. 17651"
DURING SURVEY FILED IN VOLUME
19 OF SURVEYS AT PAGE 190.

ACCEPTED CONCRETE
PAVEMENT CENTERLINE AS
RIGHT OF WAY CENTERLINE.

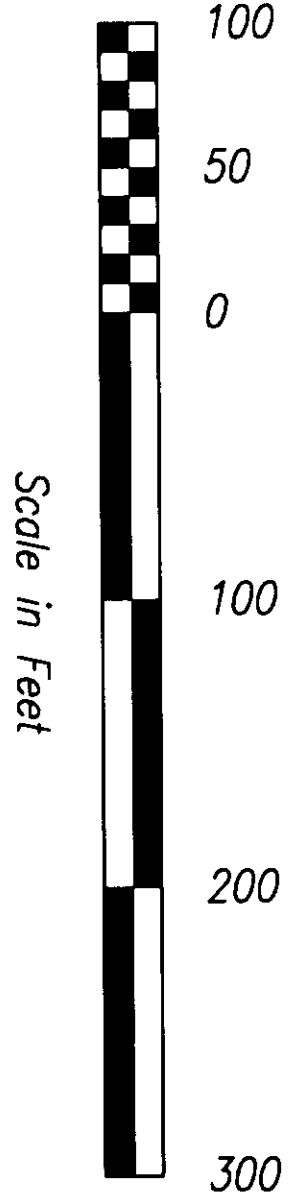

Scale in Feet

FOUND 2" IRON PIPE WITH
ALUMINUM CAP SET BY
DENNY DEMETER L.S.#21423
ON 9/29/87.

S87°20'44"E
1266.00'

1268.65'

SET PLASTIC CAP L.S.#17651 IN
NOTCH IN 10" ALDER TREE FOR
SECTION CORNER ON 1/24/84.
SEE SURVEY FILED IN VOLUME 13
OF SURVEYS AT PAGE 46.

DATE

REVISION

BY

JOB#

96220B

DRAWN

STW

CHECKED

JLO

DATE

01FEB02

SCALE

1" = 100'

SHEET

1 OF 1

Survey for James Ross

Skagit
Surveyors & Engineers

806 Metcalf St., Sedro-Woolley, WA 98284 Phone: (360) 855-2121 FAX: (360) 855-1658

COPYRIGHT 2001 SKAGIT SURVEYORS, INC.

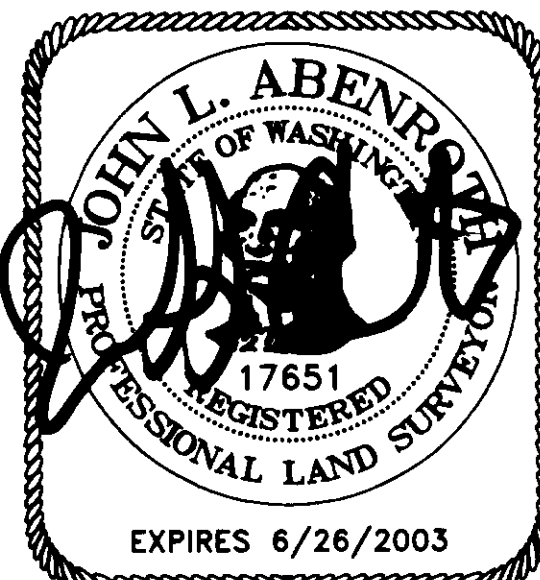

SURVEYOR'S CERTIFICATE

This map correctly represents a
survey made by me or under my
direction in conformance with the
Survey Recording Act in January
2002 at the request of James Ross.

John L. Abenroth CERT#17651

Date

7/9/2002

AUDITOR'S CERTIFICATE



200207240001
Skagit County Auditor

7/24/2002 Page 1 of 1 8:31AM

Norma Brunnett by Melody Demoss
County Auditor or Deputy Auditor