

AUDITORS CERTIFICATE FILED FOR RECORD AT THE
REQUEST OF SCHEMMER ENGINEERING INC.

200207090083

Skagit County Auditor

7/9/2002 Page 1 of 1 3:25PM

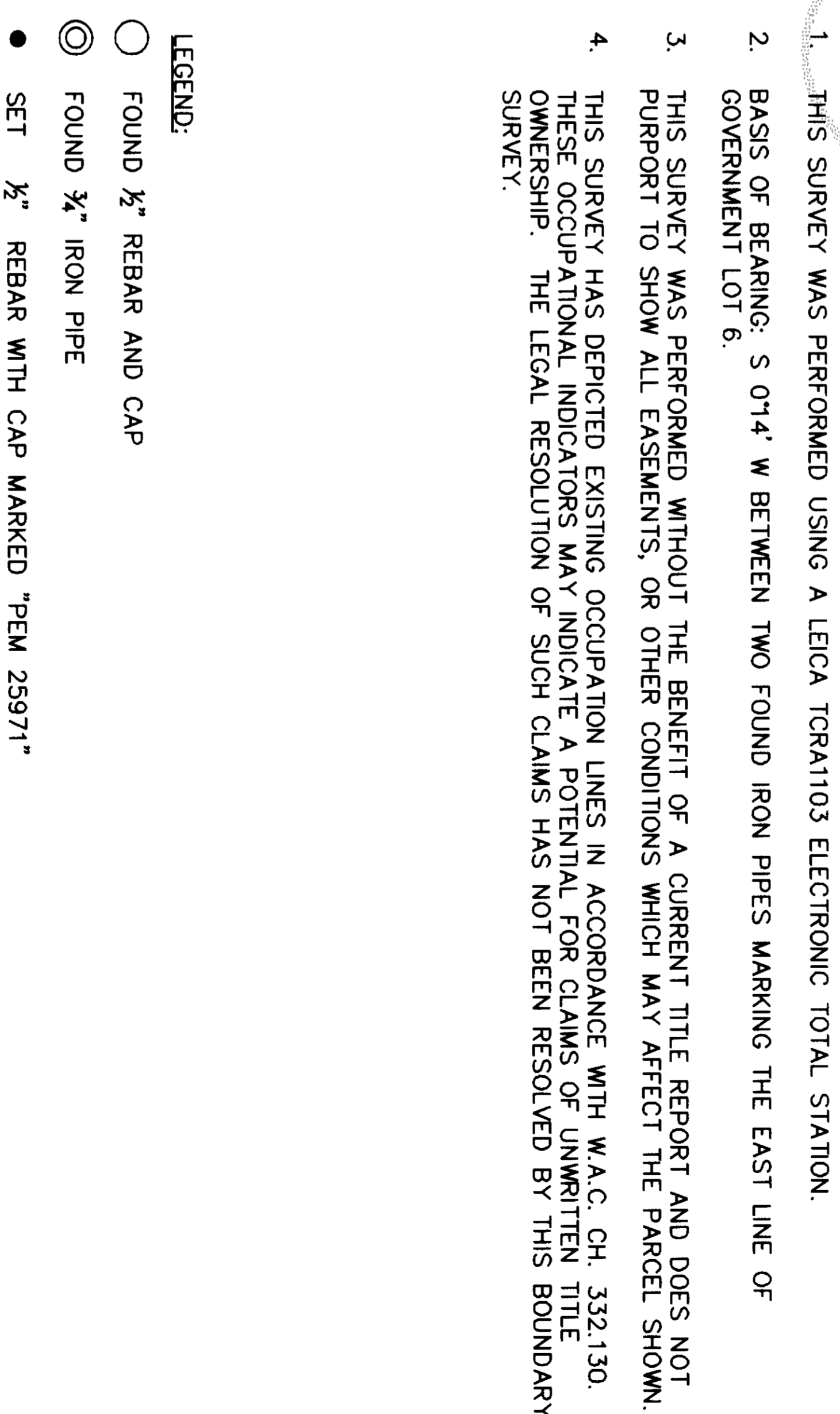

- FOUND ½" REBAR AND CAP
- ◎ FOUND ¾" IRON PIPE
- SET ½" REBAR WITH CAP MARKED "PEW 25971"

LOT 1 AND THE SOUTH 60 FEET OF LOT 2, RANCHO SAN JUAN DEL MAR, SUBDIVISION NO. 2, ACCORDING TO THE PLAT THEREOF RECORDED IN VOLUME 5 OF PLATS, PAGE 30, RECORDS OF SKAGIT COUNTY, WASHINGTON;
TOGETHER WITH THAT PORTION OF MARINE DRIVE NO. 378 DESCRIBED IN AMENDED VACATION RECORDED JULY 19, 1978 UNDER AUDITOR'S FILE NO. 883795 AS WOULD ATTACH BY OPERATION OF LAW;
EXCEPT THAT PORTION CONVEYED TO SKAGIT COUNTY FOR ROAD BY DEED RECORDED JULY 5, 1972 UNDER AUDITOR'S FILE 770666.
SUBJECT TO: RESTRICTIONS, RESERVATIONS, AND EASEMENTS OF RECORD.

1. THIS SURVEY WAS PERFORMED USING A LEICA TCRA1103 ELECTRONIC TOTAL STATION.

2. BASIS OF BEARING: S 014° W BETWEEN TWO FOUND IRON PIPES MARKING THE EAST LINE OF GOVERNMENT LOT 6.
3. THIS SURVEY WAS PERFORMED WITHOUT THE BENEFIT OF A CURRENT TITLE REPORT AND DOES NOT PURPORT TO SHOW ALL EASEMENTS, OR OTHER CONDITIONS WHICH MAY AFFECT THE PARCEL SHOWN.
4. THIS SURVEY HAS DEPICTED EXISTING OCCUPATION LINES IN ACCORDANCE WITH W.A.C. CH. 332.130. THESE OCCUPATIONAL INDICATORS MAY INDICATE A POTENTIAL FOR CLAIMS OF UNWRITTEN TITLE OWNERSHIP. THE LEGAL RESOLUTION OF SUCH CLAIMS HAS NOT BEEN RESOLVED BY THIS BOUNDARY SURVEY.

SHEET
SUR 1
1 OF 1

SCHEMMER ENGINEERING INC.

1610 COMMERCIAL AVENUE, SUITE A
ANACORTES, WA 98221 (360) 293-9006



a survey made by me or I
under my direction in
in conformance with the Survey
Recording Act.

Paul E. Monohon CERT#25971

Date July 8, 2002

DESIGNED	PEM
DRAWN	PEM
CHECKED	
	BY
DATE	BY APP
7/2/02	

APP	REVISIONS

7/2/05

2			
---	--	--	--

CAD FILE: WALGAMOTT.DWG	PLOT DATE:
-------------------------	------------