

Return to:

MARC AND MARY SHEMES
17110 N.E. 733rd ST.
REDMOND, WA. 98052



200204190118

Skagit County Auditor

4/19/2002 Page 1 of 2 11:43AM

PROTECTED CRITICAL AREA SITE PLAN

Page 1 of 2

Grantor/Owner: Mark & Mary Shemesh

Grantee: PUBLIC

Site Address: 34131 South Shore Drive

Property ID #: P 66564 Assessors Tax Account #: 3938-001-086-0006

Legal Description: Sec. 26 Twp. 33 Rng. 6 / Plat Name Lk Cav Div 2 Lot 86

Permit/Activity #: BP02-0338 31K 1

PROTECTED CRITICAL AREA (PCA) is to be left undisturbed in a natural state. No clearing, grading, filling, logging or removal of woody material, building, construction or road construction of any kind or planting of non-native vegetation is allowed within the PCA areas except as specifically permitted by Skagit County on a case-by-case basis consistent with Skagit County Code 14.24.

Representations on this site plan may be approximations only and should not be used for purposes other than for determining general locations of critical areas. Development activities beyond the scope of this plan may require additional studies and approvals.

The above references to "Grantor" and "Grantee" shall not be construed as a transfer of property ownership and are used solely for filing with the County Auditor.

Owner: Marc Shemesh Date: 4/15/02

On this day personally appeared before me MARC SHEMES known to be the individual described herein and acknowledged to me that HE signed the same as his free and voluntary act and deed for the uses and purposes therein mentioned.

Warren G. Otteson, Notary Public in and for the State of Washington,
residing at 34207 So. Shore Dr. Date: 4/15/02

WARREN G. OTTESON
STATE OF WASHINGTON
NOTARY ---- PUBLIC
MY COMMISSION EXPIRES 10-20-04

WARREN G. OTTESEN
STATE OF WASHINGTON
NOTARY PUBLIC
MY COMMISSION EXPIRES 12-31-64

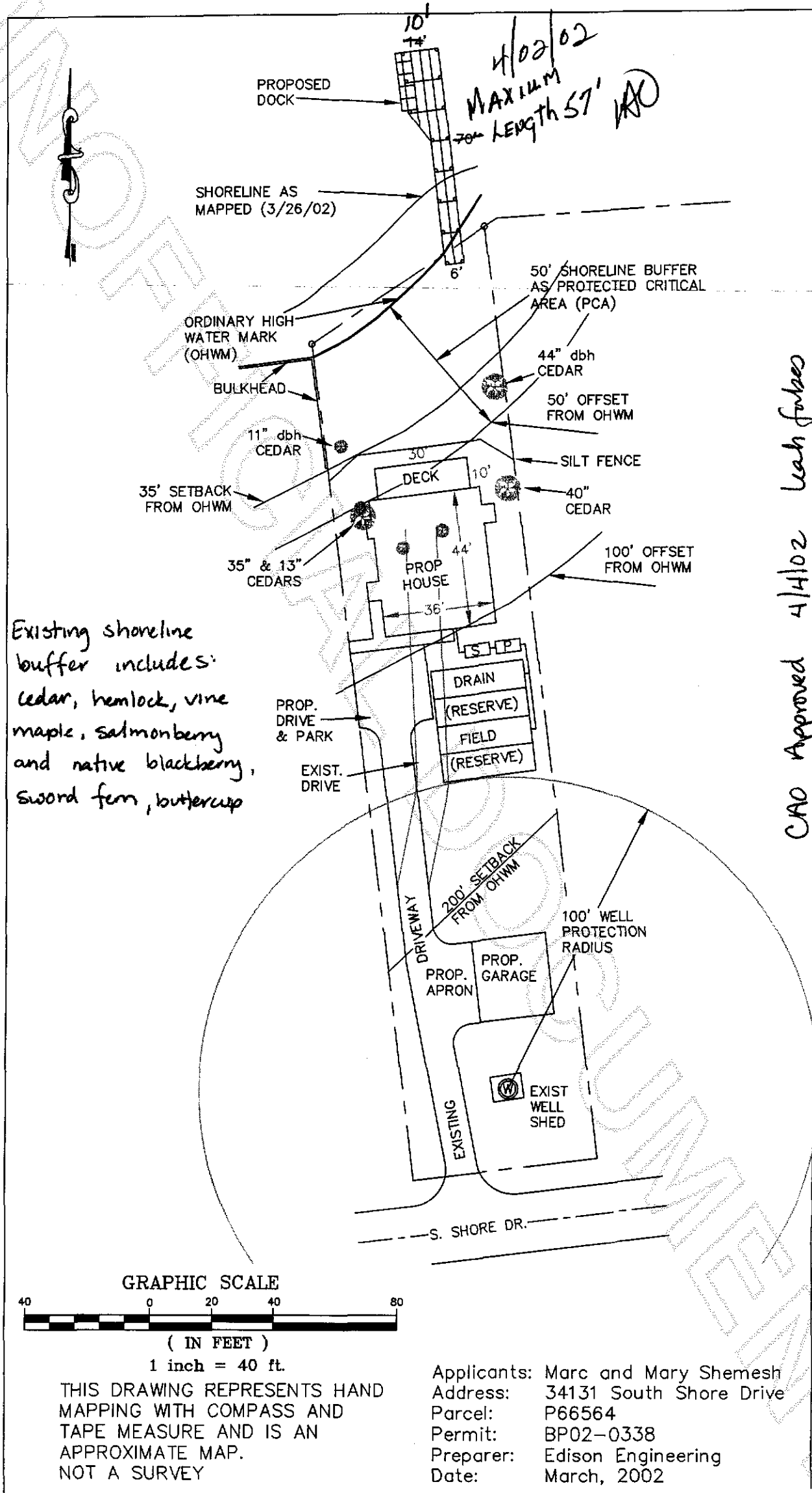

200204190118

Skagit County Auditor