

LINE TABLE

#	BEARING	DISTANCE
L1	N89°36'04\"E	2.46'
L2	N58°27'39\"E	30.00'
L3	N58°27'39\"E	7.46'
L4	S31°32'22\"E	20.00'
L5	N58°27'39\"E	10.00'
L6	N58°27'39\"E	18.44'
L7	S31°32'22\"E	30.00'

- Addresses**
- Lot 1 = 517 Marshall Avenue
 - Lot 2 = 513 & 515 Marshall Avenue
 - Lot 3 = 509 & 511 Marshall Avenue
 - Lot 4 = 505 & 507 Marshall Avenue

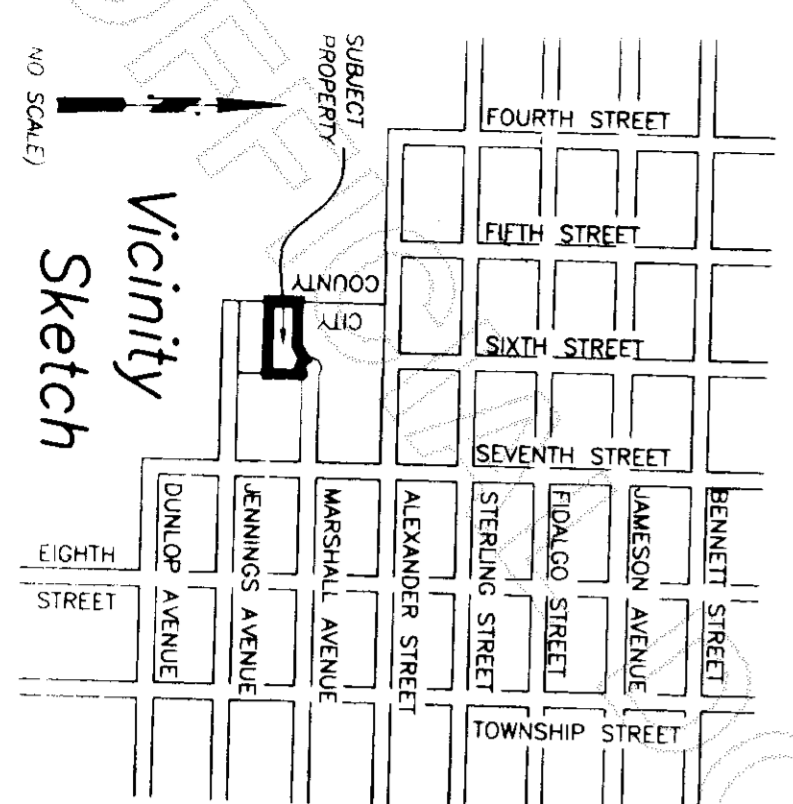

Legend

- Set 1/2" x 18" reinforcing rod with yellow plastic cap marked "SKA SURV 17651" and white 2" x 2" witness stake, except as noted.
- Reinforcing rod as shown on "Plat of Metcalfe Meadows" filed in Volume 16 of Plats at page 204.
- Set concrete monument with brass cap marked L.S.#17651, in case and cover, on "Plat of Metcalfe Meadows" filed in Volume 16 of Plats at page 204.

Legal Description

Lot 10, "Plat Of Metcalfe Meadows," as per plat recorded in Volume 16 of Plats, page 204, records of Skagit County, Washington. TOGETHER WITH That portion of Lot 9, "Plat Of Metcalfe Meadows" as per plat recorded in Volume 16 of Plats, Page 204, records of Skagit County, Washington, lying Southeasterly of the following described line: Commencing at the corner between Lot 8 and Lot 9 on the cul-de-sac right of way line for Marshall Avenue as shown on said plat; thence Southerly along said cul-de-sac right of way line through a central angle of 30°57'49" and an arc length of 24.32 feet to the initial point of this line description; thence S58°27'39"W, a distance of 95.28 feet to a point on the South line of said Lot 9 which lies 143.92 feet Easterly of the Southwest corner thereof and terminus of this line description.

Utility Easement

An easement is hereby reserved for and granted to the following: The City of Sedro-Woolley, Public Utility District No. 1 of Skagit County, Puget Sound Energy, Cascade Natural Gas, GTE of the Northwest, TCI Cablevision, and their respective successors and assigns, under and upon those areas marked as utility easements hereon, and the exterior seven (7) feet of all lots, tracts and spaces within the subdivision lying parallel with and adjoining all street(s) in which to construct, operate, maintain, repair, replace and enlarge underground pipes, conduits, cables, wires and all necessary or convenient underground or ground mounted appurtenances thereto for the purpose of serving this subdivision and other property with sewer, water, electricity, gas, telephone service, television cable service and other utility services, together with the right to enter upon said private street(s), if any, all lots, tracts and spaces at all times for the purposes herein stated.

Notes

1. Basis-of-bearings - Assumed according to the "Plat Of Metcalfe Meadows", recorded in Volume 16 of Plats at page 204 as A.F.#9801161182.
2. Zoning - S-F1
3. Sewer - City of Sedro-Woolley
4. This survey was accomplished by field traverse using: 2 Second Digital Electronic Total Station, and meets or exceeds the standards contained in WAC 332-130-090.
5. Water - Public Utility District No. 1 of Skagit County.
6. A waiver of protest for future LID or ULID formation is filed under A.F.# 200112140119
7. Impact fees will be required prior to the issuance of building permits.

Consent

Know all men by these presents that we the undersigned subdividers hereby certify that this short plat is made as our free and voluntary act and deed.

Stu J. Metcalfe *Stu J. Metcalfe* Teresa L. Grage *Teresa L. Grage*
Washington Federal Savings *Wendy Burch Steel*

Acknowledgments

State of Washington, County of SKAGIT
I certify that I know or have satisfactory evidence that Stu J. Metcalfe and Teresa L. Grage, h/w, signed this instrument and acknowledged it to be their free and voluntary act for the uses and purposes mentioned in the instrument.

Notary signature *Sonia G. Lopez* Title Notary
Date 11/29/01 My appointment expires July 1, 2002

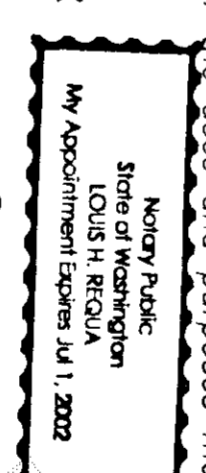

State of Washington, County of SKAGIT
I certify that I know or have satisfactory evidence that Dee Russell signed this instrument, on oath SR. VICE PRESIDENT of Washington Federal Savings to be the free and voluntary act of such party for the uses and purposes mentioned in the instrument.

Notary signature *Sonia G. Lopez* Title Notary
Date 11/29/01 My appointment expires July 1, 2002

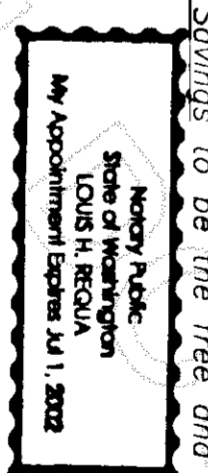

Treasurer's Certificate

This is to certify that all taxes heretofore levied and which have become a lien on the lands herein described have been fully paid and discharged according to the records of my office up to and including the year 2001.

Approvals

Skagit County Treasurer *Philip J. Jorgensen* Date 12-14-01
The within and foregoing short plat is approved in accordance with the provisions of the Sedro-Woolley Sub-division Ordinance. This 11 day of November, 2001.

Debbie Hickey City Planner
Carissa Bryant City Engineer

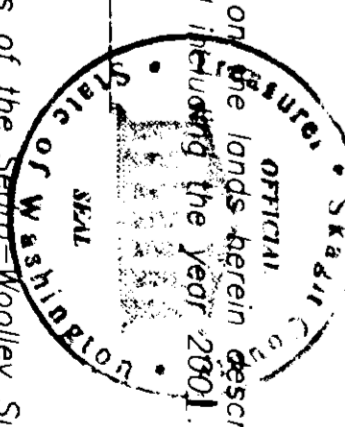

Skagit Surveyors & Engineers
806 Metcalf St., Sedro-Woolley, WA 98284 Phone: (360) 855-2121 FAX: (360) 855-1658

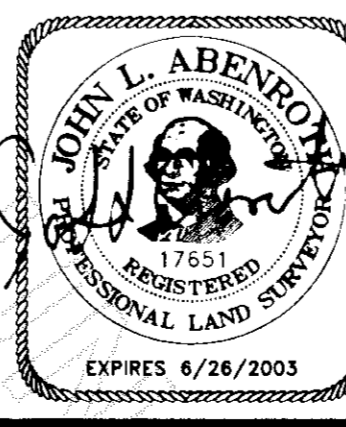

SURVEYOR'S CERTIFICATE
This map correctly represents a survey made by me or under my direction in conformance with the Survey Recording Act in July 2001 at the request of Stu Metcalfe
John L. Abenroth CERT#17651
Date 12/5/2001

AUDITOR'S CERTIFICATE
Filed for record this 14 day of Dec, 2001 at 3:16 minutes past 2 o'clock, P.M.,
as A.F.# 200112140118
Norma Brummett by *Melinda Denosoff*
County Auditor or Deputy Auditor