



200109100148

, Skagit County Auditor

9/10/2001 Page 1 of 3 3:45:42PM

Parcel No.: 340436-0-073-0006/P29950  
Legal Desc.: Ptn Gov. Lot 6, 26-34-4

m12992  
LAND TITLE COMPANY OF SKAGIT COUNTY

**QUIT CLAIM DEED**

**THE GRANTOR**, Big Lake Community Church of the Nazarene, a Washington non-profit corporation, for and in consideration of NO MONETARY CONSIDERATION, boundary line adjustment purposes only, conveys and quit claims to Norma L. Everett, a single woman, as her separate property, **THE GRANTEE**, the following described real estate, situated in the County of Skagit, State of Washington, together with all after acquired title of the Grantor therein:

**As attached hereto and by reference made a part hereof**

The above described property will be combined or aggregated with contiguous property owned by the grantee and legally described on Exhibit "B" attached hereto. This boundary adjustment is not for the purposes of creating an additional building lot.

DATED this 23 day of August, 2001.

Big Lake Community Church of the Nazarene  
By: Dennis G. Spinnie, Pastor

42819

SKAGIT COUNTY WASHINGTON  
Notary Public

SEP 10 2001

STATE OF WASHINGTON }  
County of Skagit } ss

Amount Paid \$ 22.95  
Skagit Co. Treasurer  
By: LP Deputy

I hereby certify that I know or have satisfactory evidence that Dennis G. Spinnie is the person who personally appeared before me, and said person acknowledged that he signed this instrument, on oath stated that he was authorized to execute the instrument and acknowledged it as the Pastor of Big Lake Community Church of the Nazarene, to be the free and voluntary act of such party for the uses and purposes mentioned in this instrument.

Dated this 23rd day of August, 2001.

SHARON R. ANTHONY  
STATE OF WASHINGTON  
NOTARY ---- PUBLIC  
My Commission Expires 9-6-2005

Notary Public in and for the  
State of Washington, residing at  
Mount Vernon  
My appointment expires 9-6-2005

**Skagit**  
**Surveyors & Engineers**

806 Metcalf St., Sedro-Woolley, WA 98284 Phone: (360) 855-2121 FAX: (360) 855-1658

BOUNDARY LINE ADJUSTMENT  
LEGAL DESCRIPTION  
FOR  
NORMA EVERETT  
OF

A PORTION OF ASSESSOR'S PARCEL NUMBER P29950  
TO BE AGGREGATED WITH ASSESSOR'S PARCEL P29954

August 8, 2001

That portion of the Government Lot 6 of Section 36, Township 34 North,  
Range 4 East, W.M. described as follows:

Commencing at the southeast corner of Tract B as shown on survey for  
Timothy and Chikita McGarrah recorded under Auditor's File Number  
200011220092; thence S74°52'01"W along the south line of said Tract B,  
a distance of 70.00 Feet to the point of beginning of this  
description; thence S47°04'35"W, a distance of 25.74 feet; thence  
S74°52'01"E, a distance of 50.00 feet; thence N83°20'19"W, a distance  
of 32.32 feet to the south line of said Tract B; thence N74°52'01"E  
along said south line, a distance of 102.78 feet to the point of  
beginning.

Situated in Skagit County, Washington.

Containing 917 square feet.

**BOUNDARY ADJUSTMENT**  
Reviewed and approved  
in accordance with S.C.  
Code Chapter 14.18  
*Greg Roeder*  
SKAGIT CO. PLANNING & PERMIT CNTR  
Date: 9/5/2001

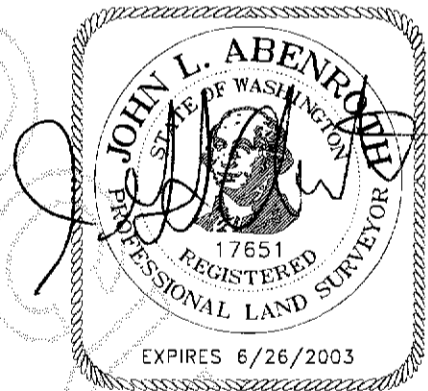

Skagit County Auditor

**Exhibit "B"**

The Northerly 60 feet of that portion of the following described property in the Southeast  $\frac{1}{4}$  of the Northeast  $\frac{1}{4}$  and in Government Lot 6 of Section 36, Township 34 North, Range 4 East, W.M., lying Northerly and Easterly of a private road as it lies on the ground; Commencing at the Southeast corner of the Northeast  $\frac{1}{4}$  of said Section 36;

thence South  $89^{\circ}25'43''$  West, along the South line of said Northeast  $\frac{1}{4}$ , a distance of 1208.46 feet to a point;

thence continue South  $89^{\circ}25'43''$  West, a distance of 514.21 feet, more or less, to the Easterly line of State Highway No. 1-A;

thence Northerly along said Easterly line, a distance of 184 feet to the TRUE POINT OF BEGINNING;

thence continue Northerly along said Easterly line a distance of 328 feet, more or less, to the Southwest corner of those premises contracted to be conveyed to Ervin A. Taylor, et al, by instrument dated May 31, 1961, recorded June 27, 1961, in Volume 317 of Deeds, page 126, under Auditor's File No. 609310, records of Skagit County, Washington;

thence North  $74^{\circ}16'52''$  East to the Southeast corner of said Taylor premises;

thence South  $17^{\circ}05'32''$  East to a point which lies North  $74^{\circ}16'52''$  East from the true point of beginning;

thence South  $74^{\circ}16'52''$  West to the TRUE POINT OF BEGINNING.

TOGETHER WITH that portion of Parcel A described in Statutory Warranty Deed to Timothy J. McGarrah and Chikita McGarrah under Auditor's File No. 8609100047, records of Skagit County, Washington, lying in the Northeast  $\frac{1}{4}$  of Section 36, Township 34 North, Range 4 East, w.M., described as follows:

Commencing at the Southwest corner of said Parcel A;

thence North  $74^{\circ}52'01''$  East along the South line of said Parcel A, a distance of 222.69 feet to the TRUE POINT OF BEGINNING;

thence North  $23^{\circ}54'02''$  East, a distance of 14.16 feet;

thence North  $74^{\circ}52'01''$  East, a distance of 183.51 feet to the Easterly line of said Parcel A;

thence South  $16^{\circ}30'23''$  East along said Easterly line, a distance of 11.00 feet to the Southeast corner of said Parcel A;

thence South  $74^{\circ}52'01''$  West along the Southerly line of said Parcel A, a distance of 192.70 feet to the TRUE POINT OF BEGINNING.

EXCEPT that portion of Parcel B described in Statutory Warranty Deed to Timothy J. McGarrah and Chikita McGarrah under Auditor's File No. 8609100047, records of Skagit County, Washington, lying in the Northeast  $\frac{1}{4}$  of Section 36, Township 34 North, Range 4 East, W.M., lying Westerly of the following described line:

Commencing at the Northwest corner of said Parcel B;

thence North  $74^{\circ}52'01''$  East along the North line of said Parcel B, a distance of 222.69 feet to the initial point;

thence South  $23^{\circ}54'01''$  West, a distance of 77.24 feet to the South line of said Parcel B and the TERMINUS.



200109100148

, Skagit County Auditor