

AFTER RECORDING MAIL TO:  
Grandview, Inc.  
P.O. Box 159  
Arlington, WA 98223



200107110129  
Skagit County Auditor

7/11/2001 Page 1 of 2 12:03:29PM

Filed for Record at Request of  
Land Title Company of Skagit County  
Escrow Number: JENNIFER  
LAND TITLE COMPANY OF SKAGIT COUNTY

**QUIT CLAIM DEED**

Grantor(s): Grandview, Inc.  
Grantee(s): Grandview, Inc.  
Abbreviated Legal: Lot 25, Spring Meadows Div. II  
Additional legal(s) on page:  
Assessor's Tax Parcel Number(s): 4735-000-025-0000

THE GRANTOR Grandview, Inc.  
for and in consideration of Boundary Line Adjustment  
conveys and quit claims to Grandview, Inc.  
the following described real estate, situated in the County of State of Washington, together with all after  
acquired title of the grantor(s) therein:  
See Attached Exhibit A

#41814  
SKAGIT COUNTY WASHINGTON  
Real Estate Excise Tax

JUL 11 2001

Amount Paid \$  
Skagit Co. Treasurer  
By Deputy

Dated July 9, 2001  
Scott Wammack

[Signature]

STATE OF Washington }  
County of Skagit } SS:

I certify that I know or have satisfactory evidence that Scott Wammack  
signed this instrument, on oath stated that he authorized to  
execute the instrument and acknowledged it as the President  
of Grandview, Inc. to be the free and voluntary act of such  
party for the uses and purposes mentioned in this instrument.

Dated: July 9, 2001

[Signature]  
Jennifer J. Lind  
Notary Public in and for the State of Washington  
Residing at Bow  
My appointment expires: 10/01/2002

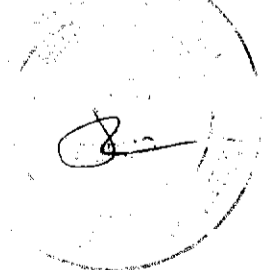



806 Metcalf St., Sedro-Woolley, WA 98284 Phone: (360) 855-2121 FAX: (360) 855-1658

LEGAL DESCRIPTION  
FOR  
GRANDVIEW INC.  
OF  
NEW LOT 25 AFTER BOUNDARY LINE ADJUSTMENT

June 13, 2001

Lot 25 in the Plat of SPRING MEADOWS - DIVISION II filed in Volume 17 of Plats at Pages 75 and 76 under Auditor's File Number 9906220076;

TOGETHER WITH that portion of Lot 24 of said plat described as follows: Beginning at the northwest corner of said Lot 24; thence N69°46'22"E along the north line thereof, a distance of 89.50 feet to the northeast corner of said Lot 24; thence S58°50'29"W, a distance of 34.23 feet; thence S68°06'44"W, a distance of 41.74 feet; thence N81°41'49"W, a distance of 16.12 feet to the point of beginning of this description.

Situated in Skagit County, Washington.

Containing 5,161 square feet.

CITY OF SEDRO-WOLLEY  
PLANNING DEPARTMENT  
APPROVED *Freddie Halber*  
6-14-01

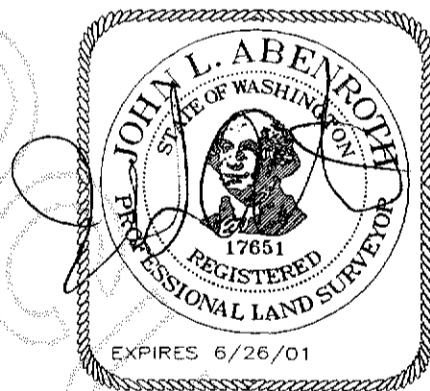

6/14/01



200107110129  
Skagit County Auditor

UNOFFICIAL DOCUMENT