

AFTER RECORDING MAIL TO:
Grandview, Inc.
P.O. Box 159
Arlington, WA 98223

200107110128
Skagit County Auditor
7/11/2001 Page 1 of 2 12:03:18PM

Filed for Record at Request of
Land Title Company of Skagit County
Escrow Number:

LAND TITLE COMPANY OF SKAGIT COUNTY **QUIT CLAIM DEED**

Grantor(s): Grandview, Inc.
Grantee(s): Grandview, Inc.
Abbreviated Legal: Lot 24, Spring Meadows Div. II
Additional legal(s) on page:
Assessor's Tax Parcel Number(s): 4735-000-024-0000/R116070

THE GRANTOR Grandview, Inc.
for and in consideration of Boundary Line Adjustment
conveys and quit claims to Grandview, Inc.
the following described real estate, situated in the County of State of Washington, together with all after
acquired title of the grantor(s) therein:
See Attached Exhibit A

#41813
SKAGIT COUNTY WASHINGTON
Real Estate Excise Tax

JUL 11 2001

Amount Paid \$
Skagit Co. Treasurer
By Deputy

Dated July 9, 2001
Scott Wammack

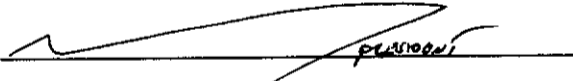

President

STATE OF Washington }
County of Skagit } SS:

I certify that I know or have satisfactory evidence that Scott Wammack
signed this instrument, on oath stated that he authorized to
execute the instrument and acknowledged it as the President
of Grandview, Inc. to be the free and voluntary act of such
party for the uses and purposes mentioned in this instrument.

Dated: July 9, 2001

Jennifer J. Lind
Notary Public in and for the State of Washington
Residing at Bow
My appointment expires: 10/01/2002

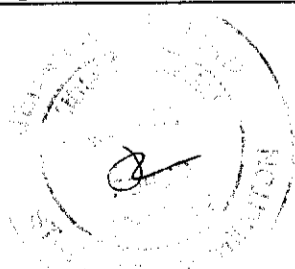



806 Metcalf St., Sedro-Woolley, WA 98284 Phone: (360) 855-2121 FAX: (360) 855-1658

LEGAL DESCRIPTION
FOR
GRANDVIEW INC.
OF

NEW LOT 24 AFTER BOUNDARY LINE ADJUSTMENT

June 13, 2001

Lot 24 in the Plat of SPRING MEADOWS - DIVISION II filed in Volume 17 of Plats at Pages 75 and 76 under Auditor's File Number 9906220076;

EXCEPT beginning at the northwest corner of said Lot 24; thence N69°46'22"E along the north line thereof, a distance of 89.50 feet to the northeast corner of said Lot 24; thence S58°50'29"W, a distance of 34.23 feet; thence S68°06'44"W, a distance of 41.74 feet; thence N81°41'49"W, a distance of 16.12 feet to the point of beginning of this description.

Situated in Skagit County, Washington.

Containing 4,517 square feet.

CITY OF SEDRO-WOOLLEY
PLANNING DEPARTMENT
APPROVED *Jerridine Halbey*
6-14-01

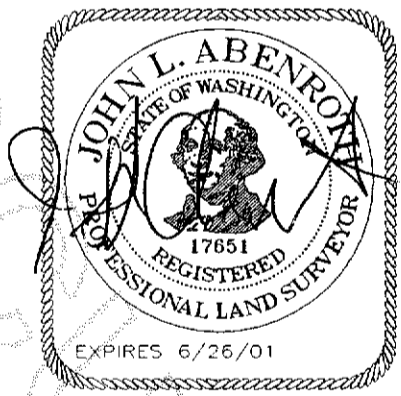

6/14/01



200107110128

Skagit County Auditor