

Return to:

Jeremy Mast
29772 Lyman Hamilton
SW Wa 98284



200104100002

Skagit County Auditor

4/10/2001 Page 1 of 2 8:31:30AM

PROTECTED CRITICAL AREA SITE PLAN

Page 1 of 2

Grantor/Owner: Jeremy Mast

Grantee: PUBLIC

Site Address: 29772 Lyman Hamilton Hwy SW Wa 98284

Property ID #: P 38981 Assessors Tax Account #: 350513-0-022-0102

Legal Description: Sec. 13 Twp. 35 Rng. 05 / Plat Name S/P 70-79 Lot 1

Permit/Activity #: BPO1-0320

PROTECTED CRITICAL AREA (PCA) is to be left undisturbed in a natural state. No clearing, grading, filling, logging or removal of woody material, building, construction or road construction of any kind or planting of non-native vegetation is allowed within the PCA areas except as specifically permitted by Skagit County on a case-by-case basis consistent with Skagit County Code 14.24.

Representations on this site plan may be approximations only and should not be used for purposes other than for determining general locations of critical areas. Development activities beyond the scope of this plan may require additional studies and approvals.

The above references to "Grantor" and "Grantee" shall not be construed as a transfer of property ownership and are used solely for filing with the County Auditor.

Owner: Jeremy Mast

On this day personally appeared before me Josh Campbell known to be the individual described herein and acknowledged to me that he signed the same as his free and voluntary act and deed for the uses and purposes therein mentioned.

Josh Campbell, Notary Public for the State of Washington,
residing at Mount Vernon Date: 04/10/01

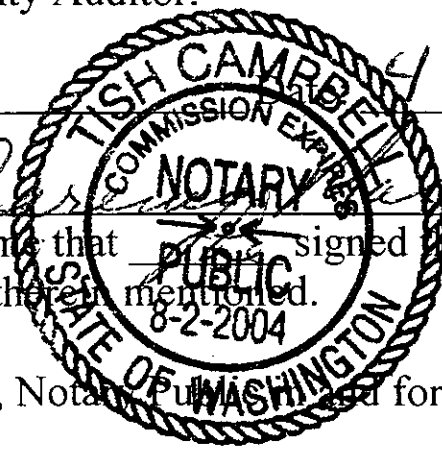

PROTECTED CRITICAL AREA SITE PLAN

Page 2 of 2

Applicant: Jeremy Mast

Permit #:

Parcel #: 1#

Site Address: 29272 Lyman Hamilton Hwy SW
98224

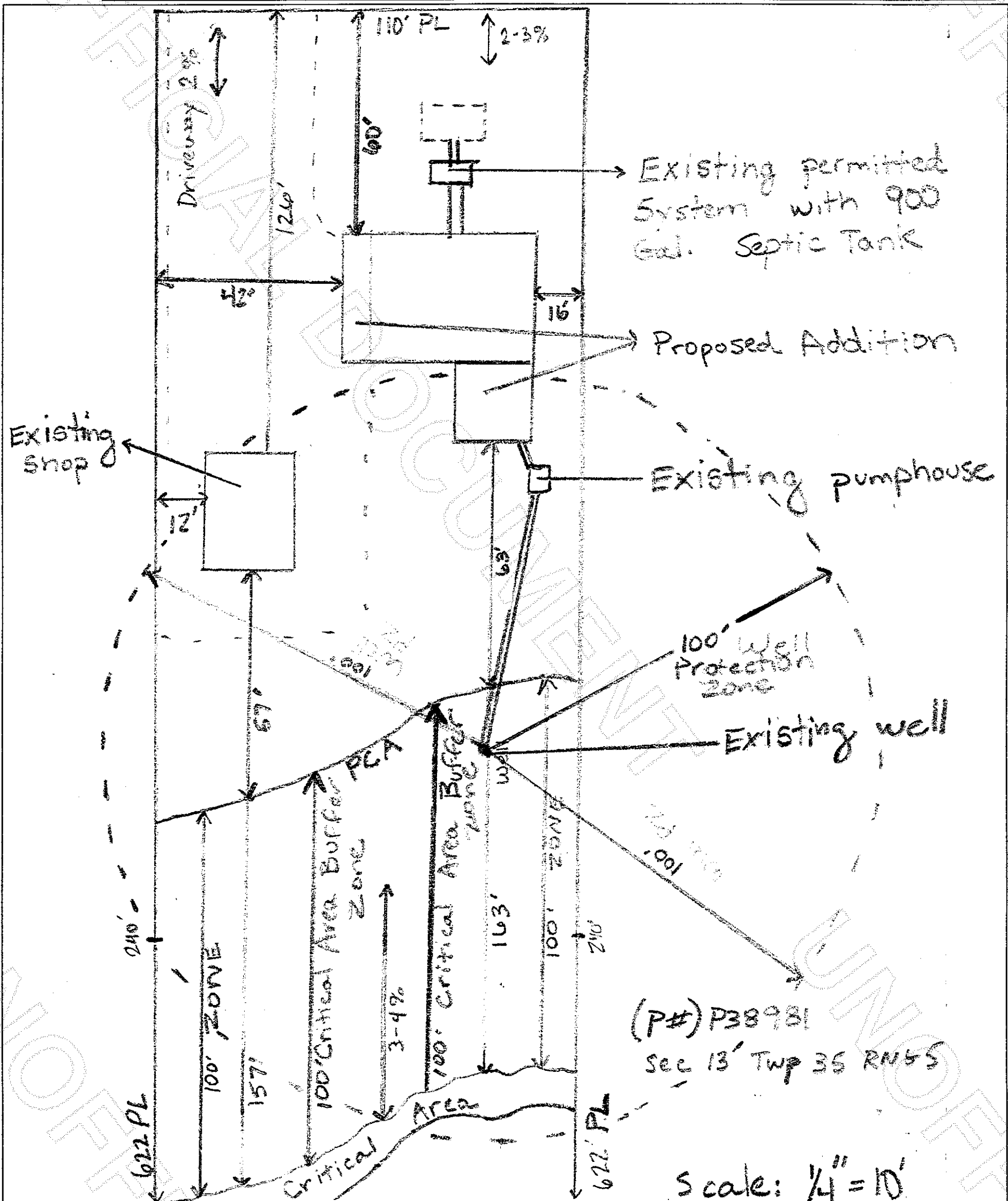

Skagit County CAO Staff Signature

Date: _____

Apr¹

Date



200104100002

, Skagit County Auditor