

Return to:

\_\_\_\_\_  
\_\_\_\_\_  
\_\_\_\_\_



200104040010  
Skagit County Auditor

4/4/2001 Page 1 of 2 9:46:39AM

**PROTECTED CRITICAL AREA SITE PLAN**

Page 1 of 2

Grantor/Owner: James L. Jensen & Kathryn A. Jensen, husband & wife,

Grantee: PUBLIC

Site Address: 15210 Channel Drive, La Conner WA.

Property ID #: P 6943D Assessors Tax Account #: \_\_\_\_\_

Legal Description: Sec. \_\_\_\_\_ Twp. \_\_\_\_\_ Rng. \_\_\_\_\_ / Plat Name \_\_\_\_\_ Lot \_\_\_\_\_

Permit/Activity #: PL00-0689

PROTECTED CRITICAL AREA (PCA) is to be left undisturbed in a natural state. No clearing, grading, filling, logging or removal of woody material, building, construction or road construction of any kind or planting of non-native vegetation is allowed within the PCA areas except as specifically permitted by Skagit County on a case-by-case basis consistent with Skagit County Code 14.24.

Representations on this site plan may be approximations only and should not be used for purposes other than for determining general locations of critical areas. Development activities beyond the scope of this plan may require additional studies and approvals.

The above references to "Grantor" and "Grantee" shall not be construed as a transfer of property ownership and are used solely for filing with the County Auditor.

Owner: James L. Jensen Date: April 4, 2001

On this day personally appeared before me James L. Jensen known to be the individual described herein and acknowledged to me that he signed the same as his free and voluntary act and deed for the uses and purposes therein mentioned.

Mary [Signature], Notary Public in and for the State of Washington, residing at Burlington Date: 4/4/01

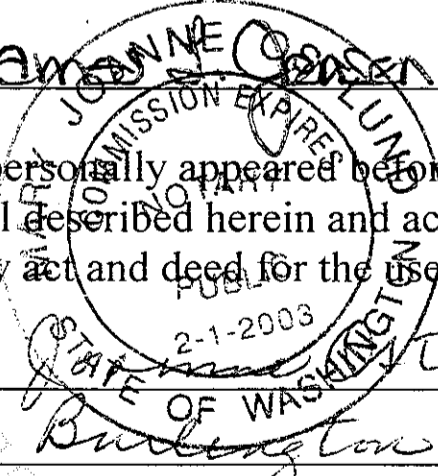

**ATTACHMENT:**

**REQUEST: SHORELINE SETBACK VARIANCE & LOT COVERAGE VARIANCE**

**TYPICAL LANDSCAPE PLAN**

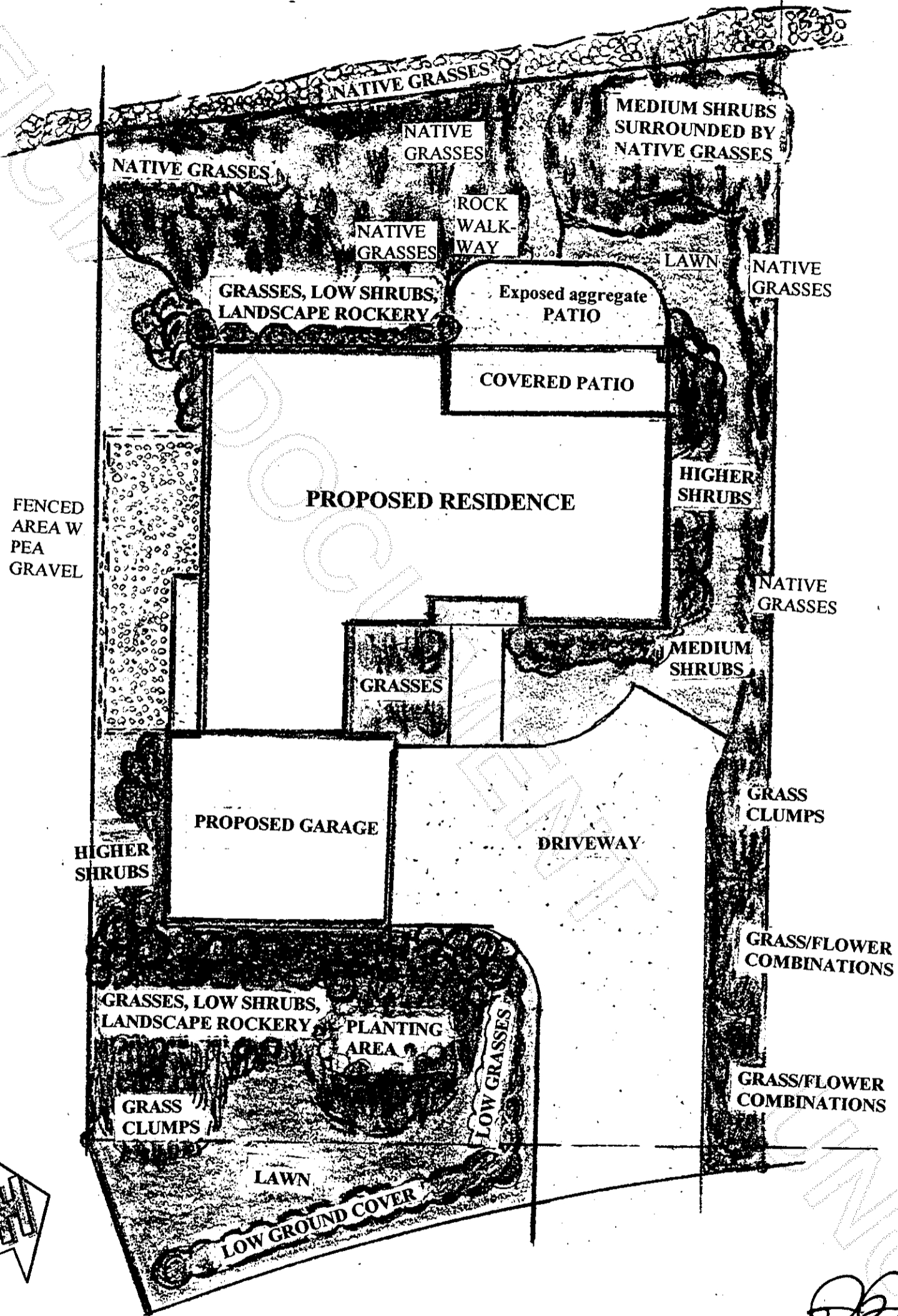

**RESUBMITTAL TO ANSWER OBJECTIONS FROM DEPARTMENT OF ECOLOGY  
JANUARY 4, 2001**

**SCALE: 1"=20'**

James L. & Kathryn A. Jensen  
Subject Property: 15210 Channel Drive, LaConner, Washington  
S 1/2 of Lot 12, Skagit Beach Division #1 & that portion



200104040010  
Skagit County Auditor