

Return to:



200103050192
, Skagit County Auditor

3/5/2001 Page 1 of 2 12:47:46PM

PROTECTED CRITICAL AREA SITE PLAN

Page 1 of 2

Grantor/Owner: Jerry Shull

Grantee: PUBLIC

Site Address: 35148 North Shore Drive

Property ID #: P 64028 Assessors Tax Account #: 3875-000-008-0008

Legal Description: Sec. 25 Twp. 33 Rng. 6 / Plat Name _____ Lot _____

Permit/Activity #: BPO1-0044

PROTECTED CRITICAL AREA (PCA) is to be left undisturbed in a natural state. No clearing, grading, filling, logging or removal of woody material, building, construction or road construction of any kind or planting of non-native vegetation is allowed within the PCA areas except as specifically permitted by Skagit County on a case-by-case basis consistent with Skagit County Code 14.24.

Representations on this site plan may be approximations only and should not be used for purposes other than for determining general locations of critical areas. Development activities beyond the scope of this plan may require additional studies and approvals.

The above references to "Grantor" and "Grantee" shall not be construed as a transfer of property ownership and are used solely for filing with the County Auditor.

Owner: Jerry P Shull Date: 3-5-01

On this day personally appeared before me Jerry P. Shull known to be the individual described herein and acknowledged to me that me signed the same as his free and voluntary act and deed for the uses and purposes therein mentioned.

Cheryl D Lanier My comm. expires 11-15-04
_____, Notary Public in and for the State of Washington,
residing at Sedro Woolley Date: 03-05-01

108'

NORTH SHORE DRIVE

Fish and Wildlife Assessment
 February 15, 2001
 Mr and Mrs Jerry Shull
 Property Address: 35148 North Shore Drive
 Mount Vernon, WA 98274
 Rupert Schmitt, consultant, 809 37th, (Anacortes, WA 98221
 Scale: 1 inch=40 feet

40

50 foot Critical Area Setback

Staff Signature *Leah Forbes* 2/21/01

EXIST SHED

EXISTING HOUSE

PROPOSED ADDITION

Setback
EXISTING DECK

PLA SETBACK
50 FT. CRITICAL AREA

SETBACK AREA
LOW bulkhead

OHWM

OHWM

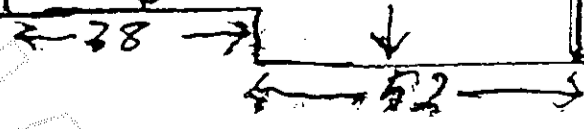

200103050192

, Skagit County Auditor