



200010130006
 , Skagit County Auditor

10/13/2000 Page 1 of 4 8:45:01AM

Parcel No.: 340436-0-075-0004/P29954
 Legal Desc.: Ptn Gov. Lot 6, 36-34-4

EASEMENT

m-12623
 LAND TITLE COMPANY OF SKAGIT COUNTY

THE GRANTORS, Timothy J. McGarrah and Chikita McGarrah, husband and wife, for and in consideration of Granting of Easement rights and no other consideration, convey to Timothy J. McGarrah and Chikita McGarrah, husband and wife, their heirs, successors and assigns in ownership of the property described on Exhibit "B" attached hereto, a non-exclusive easement place, construct, repair and maintain an electric service/power line over, under and across the following described tract:

As attached hereto as Exhibit "A"

This Easement Agreement is executed the 12 day of October, 2000.

Timothy J. McGarrah

Chikita McGarrah

STATE OF WASHINGTON }
 County of Skagit } ss

I hereby certify that I know or have satisfactory evidence that Timothy J. McGarrah and Chikita McGarrah are the persons who personally appeared before me, and said persons acknowledged that they signed this instrument and acknowledged it to be their free and voluntary act for the uses and purposes mentioned in this instrument.

Dated this 12 day of October, 2000.

SKAGIT COUNTY WASHINGTON
 Real Estate Excise Tax

OCT 13 2000

Amount Paid \$ 0
 Skagit Co. Treasurer
 By DC Deputy

Notary Public in and for the State
 of Washington, residing at Burlington

My appointment expires 3-1-01



806 Metcalf St., Sedro-Woolley, WA 98284 Phone: (360) 855-2121 FAX: (360) 855-1658

LEGAL DESCRIPTION
FOR
TIM AND CHIKITA MCGARRAH
OF
A UTILITY EASEMENT ACROSS
ASSESSOR'S PARCEL No. P29954
TO ASSESSOR'S PARCEL No. P29956

September 12, 2000

A non-exclusive utility easement 15 feet wide over, under, and through a portion of the northeast quarter of Section 36, Township 34 North, Range 4 East, W.M. described as follows:

Commencing at the southeast corner of Parcel B described in Statutory Warranty Deed to Timothy J. McGarrah and Chikita McGarrah under Auditor's File Number 8609100047; thence S74°52'01"W along the south line of said Parcel B, a distance of 176.62 feet to the initial point of this centerline description; thence N16°00'59"W, a distance of 71.01 feet to the north line of the south 11 feet of Parcel A described in Statutory Warranty Deed to Timothy J. McGarrah and Chikita McGarrah under Auditor's File Number 8609100047 and the terminus of this centerline description.

Situated in Skagit County, Washington.

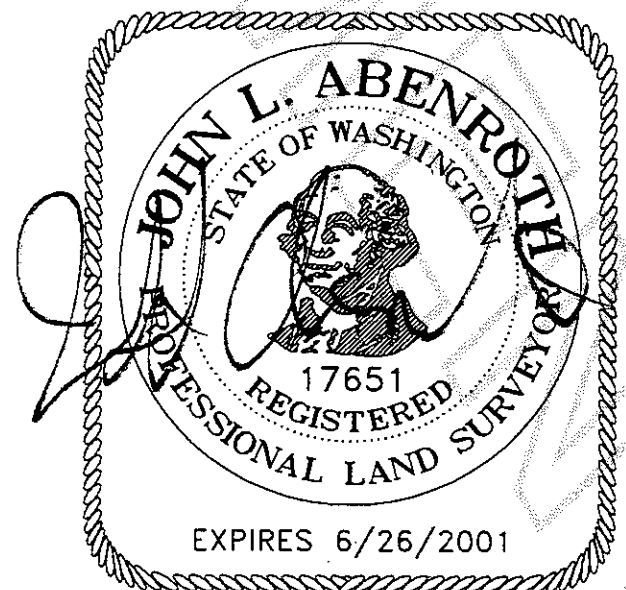

10/4/00



200010130006
Skagit County Auditor

Exhibit "B"

PARCEL "A":

The East 230 feet of the North 130 feet AND the South 160 feet of the North 290 feet of that portion of the Southeast $\frac{1}{4}$ of the Northeast $\frac{1}{4}$ and of Government Lot 6, Section 36, township 34 North, Range 4 East, W.M., described as follows:

Beginning at the Southeast corner of the Northeast $\frac{1}{4}$ of said Section 36;

thence South $89^{\circ}25'43''$ West, along the South line of said Northeast $\frac{1}{4}$, a distance of 1208.46 feet to the TRUE POINT OF BEGINNING of this description;

thence North $17^{\circ}05'32''$ West, a distance of 930.67 feet;

thence South $74^{\circ}16'52''$ West, a distance of 508.04 feet, more or less, to a point on the East right-of-way line State Highway 1-A; thence in a Southerly direction, along said East right-of-way line of State Highway 1-A, on a curve to the right, to a point on the South line of the Northeast $\frac{1}{4}$ of said Section 36;

thence North $89^{\circ}25'43''$ East, along said South line of the Northeast $\frac{1}{4}$, a distance of 514.21 feet, more or less, to the TRUE POINT OF BEGINNING.

PARCEL "B":

That portion of Parcel "B" described in Statutory Warranty Deed to Timothy J. McGarrah and Chikita McGarrah under Auditor's File Number 8609100047 lying in the Northeast $\frac{1}{4}$ of Section 36, Township 34 North, Range 4 East, W.M. lying Westerly of the following described line:

Beginning at the Northwest corner of said Parcel "B";

thence North $74^{\circ}52'01''$ East along the North line of said Parcel "B", a distance of 222.69 feet to the initial point of this line description;

thence South $23^{\circ}54'01''$ West, a distance of 77.24 feet to the South line of said Parcel "B" and terminus of this line description.

All situate in the County of Skagit, State of Washington



BOUNDARY LINE ADJUSTMENT
EXHIBIT MAP
FOR
TIM & CHIKITA MCGARRAH
IN THE NORTHEAST QUARTER OF
SECTION 36, TOWNSHIP 34 NORTH,
RANGE 4 EAST, W.M.

P29957

PORTION OF
P29956 TO BE
AGGREGATED
WITH P29954

P29956

PORTION OF
P29954 TO BE
AGGREGATED
WITH P29956

P29954

P29950

STATE ROUTE 9

DALACY
LANE



SCALE: 1"=100'
September 1, 2000



200010130006
Skagit County Auditor

10/13/2000 Page 4 of 4 8:45:01AM

GOVERNMENT
LOT - 6

EAST - WEST CENTERLINE SECTION 36