



200010130003
2
, Skagit County Auditor
10/13/2000 Page 1 of 2 8:45:16AM

Parcel No.: 340436-1-077-0002/P29956
Legal Desc.: Ptn Gov. Lot 6, 36-34-4

M-12623
LAND TITLE COMPANY OF SKAGIT COUNTY

QUIT CLAIM DEED

THE GRANTORS, Timothy J. McGarrah and Chikita McGarrah, husband and wife, for and in consideration of NO MONETARY CONSIDERATION, boundary line adjustment purposes only, conveys and quit claims to Timothy J. McGarrah and Chikita McGarrah, husband and wife, THE GRANTEES, the following described real estate, situated in the County of Skagit, State of Washington, together with all after acquired title of the Grantor therein:

As attached hereto and by reference made a part hereof

The above described property will be combined or aggregated with contiguous property owned by the grantee and legally described on Exhibit "B" attached hereto. This boundary adjustment is not for the purposes of creating an additional building lot.

DATED this 12 day of October, 2000.

Timothy J. McGarrah

Chikita McGarrah

STATE OF WASHINGTON }
County of Skagit } ss

I hereby certify that I know or have satisfactory evidence that Timothy J. McGarrah and Chikita McGarrah are the persons who personally appeared before me, and said persons acknowledged that they signed this instrument and acknowledged it to be their free and voluntary act for the uses and purposes mentioned in this instrument.

Dated this 12 day of October, 2000.

37724
SKAGIT COUNTY WASHINGTON
Real Estate Excise Tax

OCT 13 2000

Amount Paid \$
Skagit Co. Treasurer
By  Deputy

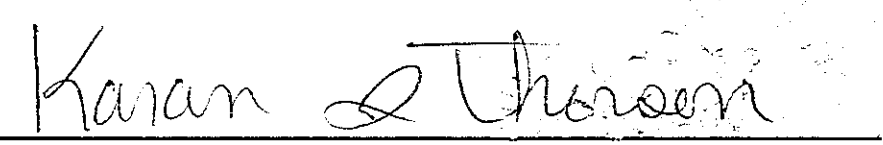
Notary Public in and for the State
of Washington, residing at
Burlington

My appointment expires 3-1-01



806 Metcalf St., Sedro-Woolley, WA 98284 Phone: (360) 855-2121 FAX: (360) 855-1658

BOUNDARY LINE ADJUSTMENT
LEGAL DESCRIPTION
FOR
TIM AND CHIKITA MCGARRAH
OF
A PORTION OF ASSESSOR'S PARCEL No.P29956
TO BE AGGREGATED WITH
ASSESSOR'S PARCEL No.P29954

September 12, 2000

That portion of Parcel A described in Statutory Warranty Deed to Timothy J. McGarrah and Chikita McGarrah under Auditor's File Number 8609100047 lying in the northeast quarter of Section 36, Township 34 North, Range 4 East, W.M. described as follows:

Commencing at the southwest corner of said Parcel A; thence N74°52'01"E along the south line of said Parcel A, a distance of 222.69 feet to the point of beginning of this description; thence N23°54'01"E, a distance of 14.16 feet; thence N74°52'01"E, a distance of 183.51 feet to the easterly line of said Parcel A; thence S16°30'23"E along said easterly line, a distance of 11.00 feet to the southeast corner of said Parcel A; thence S74°52'01"W along the southerly line of said Parcel A, a distance of 192.70 feet to the point of beginning of this description.

Situated in Skagit County, Washington.

Containing 0.05 acres.

BOUNDARY ADJUSTMENT

Reviewed and approved
in accordance with S.C.
Code Chapter 14.12.

Joel Rode
SKAGIT CO. PLANNING DEPT.
Date: 10/10/2000

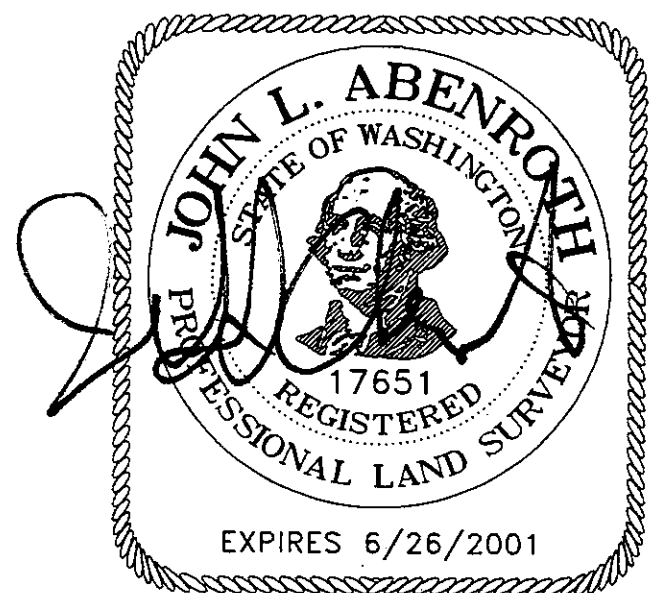

10/4/00



200010130003
Skagit County Auditor
10/13/2000 Page 2 of 2 8:45:16AM