

AFTER RECORDING RETURN TO:

Name Patrick Lisherness
Address 27389 Minkler Road
City, State, Zip Sedro-Woolley, WA 98284



200008280069

Kathy Hill, Skagit County Auditor
8/28/2000 Page 1 of 8 1:09:36PM

Abbrev. Leg. Ptn NW1/4, Sec. 15, T35N, R5E, WM
Tax Parcel Nos. 350515-0-009-0008; 350515-0-010-005

QUIT CLAIM DEED

RECITALS

Patrick Albert Lisherness, an unmarried man, is owner of the real property currently described as Parcels A, B, and C on EXHIBIT I, which is attached hereto and by this reference incorporated herein.

He now wants to adust the boundaries of his property into a different configuration, described as Tracts A and B on EXHIBIT II, which is attached hereto and by this reference incorporated herein.

THEREFORE:

THE GRANTOR, Patrick Albert Lisherness, an unmarried man, for and in consideration of boundary line adjustment with no monetary consideration, conveys and quitclaims to himself, Patrick Albert Lisherness, an unmarried man, as GRANTEE, those parcels of real property described as Tracts A and B on EXHIBIT II, which is attached hereto and by this reference incorporated herein, together with all after acquired title of the grantor therein.

Dated 8-24, 2000.

BOUNDARY ADJUSTMENT

Reviewed and approved
in accordance with S.C.
Code Chapter 14.12.

Patrick Albert Lisherness
Patrick Albert Lisherness

Joe Roeder
SKAGIT CO. PLANNING DEPT.

36988
SKAGIT COUNTY WASHINGTON
Real Estate Excise Tax

Date: 8/24/2000

AUG 28 2000

Amount Paid \$
By Skagit Co. Treasurer Deputy

LishernessBLAdeed

STATE OF WASHINGTON)
) ss
COUNTY OF SKAGIT)

I certify that I know or have satisfactory evidence that PATRICK ALBERT LISHERNESS is/are the person(s) who appeared before me, and said person(s) acknowledged that he/she/they signed this instrument and acknowledged it to be his/her/their free and voluntary act for the uses and purposes mentioned in this instrument.

Dated Aug 24, 2000

Typed/printed notary name

Residing at

My appointment expires

Linda C Massingale

Linda C Massingale

Sedro Woolley

10-1-00

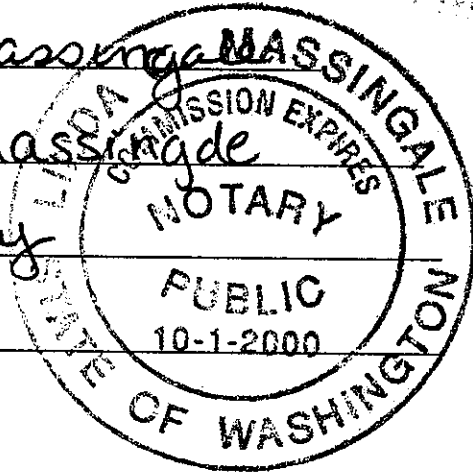

EXHIBIT I

PARCEL A:

That portion of the East Half of the East Half of the Northwest Quarter of Section 15, Township 35 North, Range 5 East of the Willamette Meridian, lying Northerly of SR-20 (formerly State Highway No. 17-A), described as follows:

Beginning at a point on the North and South centerline of said Section, 620 feet North line of said SR-20;
thence West a distance of 20 feet;
thence South 30° West to a point 490 feet North of the North line of said highway, and the true point of beginning of this description;
thence West parallel with the North line of said highway right of way a distance of 490 feet;
thence South parallel with the North and South centerline of said Section a distance of 490 feet, more or less, to the North line of said highway right of way;
thence Easterly along said highway right of way to the Southwest corner of that certain tract conveyed to Carol M. Hardin by deed dated February 20, 1967 and recorded February 21, 1967, under Auditor's File No. 695123, records of Skagit County, Washington;
thence North 08° East along the Westerly line of said Hardin Tract a distance of 103 feet to the Northwest corner thereof;
thence Easterly along the Northerly line of said Hardin Tract a distance of 80 feet to the Westerly line of that certain tract conveyed to Norman Eugene Mitchell, et ux, by deed dated April 15, 1960, recorded April 19, 1960, under Auditor's File No. 593387, records of Skagit County, Washington;
thence Northerly and Easterly along the West line of said Mitchell tract to the true point of beginning;

EXCEPT the right of way of Puget Sound and Baker River Railway Company;

ALSO EXCEPT the following described tract:

continued



Exhibit I, cont'd

Parcel A continued

That portion of the Northwest Quarter of Section 15, Township 35 North, Range 5 East of the Willamette Meridian, described as follows:

Beginning at a point on the North and South centerline of said Section 620 feet North of the North line of State Highway No. 17-A;

thence West a distance of 20 feet;

thence South 30° West to a point 490 feet North of the North line of said highway, said point being the Northeast corner of that certain tract of land deeded to Carol Hardin by Quit Claim Deed recorded under Auditor's File No. 777684, records of Skagit County, Washington, being also the true point of beginning;

thence South 86°15' West along the North line of said Hardin Tract a distance of 490 feet to the Northwest corner of said Hardin Tract;

thence South along the West boundary of said Hardin Tract a distance of 13.6 feet;

thence South 83°49'37" East a distance of 412.5 feet to the East line of said Hardin Tract;

thence North 52° East a distance of 62.2 feet;

thence North 30° East a distance of 59.7 feet to the true point of beginning.

continued



Exhibit I, cont'd

PARCEL B:

That portion of the East Half of the East Half of the Northwest Quarter of Section 15, Township 35 North, Range 5 East of the Willamette Meridian, lying Northerly of State Highway No. 17-A, described as follows:

Commencing at the intersection of the North line of State Highway No. 17-A and the North and South centerline of said Section;

thence North along said centerline a distance of 620 feet;

thence West a distance of 20 feet;

thence South 30° West a distance of 216 feet;

thence South 52° West a distance of 330 feet;

thence South 08° West to the North line of said highway and the true point of beginning of the tract herein described;

thence North 08° East a distance of 103 feet;

thence Westerly parallel with the North line of said highway 80 feet;

thence South 08° West a distance of 103 feet to the North line of said highway;

thence Easterly along said North line a distance of 80 feet to the true point of beginning;

EXCEPT Puget Sound and Baker River Railway right of way.

continued

Exhibit I, cont'd

PARCEL C:

That portion of the Northwest Quarter of Section 15, Township 35 North, Range 5 East of the Willamette Meridian, described as follows:

Beginning at a point on the North and South centerline of said Section 620 feet North of the North line of State Highway No. 17-A;

thence West a distance of 20 feet;

thence South 30° West to a point 490 feet North of the North line of said State Highway, said point being the Northeast corner of that certain tract of land deeded to Carol Hardin by Quit Claim Deed recorded under Auditor's File No. 777684, records of Skagit County, Washington;

thence South $86^{\circ}15'$ West along the North line of said Hardin Tract a distance of 490.0 feet to the Northwest corner of said Hardin Tract;

thence South along the West boundary of said Hardin Tract a distance of 13.6 feet to the true point of beginning;

thence North $83^{\circ}49'37''$ West a distance of 85.0 feet;

thence South $00^{\circ}41'52''$ West a distance of 442.4 feet to a point 50 feet (at right angles to the centerline of said State Highway) North of the North boundary of said State Highway No. 17-A;

thence North $86^{\circ}15'$ East a distance of 90.1 feet to the West line of said Hardin Tract;

thence North along the West boundary of said Hardin Tract a distance of 427.3 feet to the true point of beginning.

ALL situated in Skagit County, Washington.

- END OF EXHIBIT "I" -

EXHIBIT II
Description for
TRACT A
350515-0-009-0008

That portion of the east half of the east half of the northwest quarter of Section 15, Township 35 North, Range 5 East, W.M. described as follows:

Commencing at a point on the north and south centerline of said Section 15 which is 620 feet north of the north line of Minkler Road, (formerly State Highway 17-A); thence west, a distance of 20 feet; thence S 30° W to a point 490 feet north of the north line of said highway; thence S 86°15'W, a distance of 490 feet to the northwest corner of that certain tract of land described in deed to Carol Hardin by Quit Claim Deed recorded under Auditor's File No. 777684, records of Skagit County, Washington; thence south along the west boundary of said Hardin Tract a distance of 13.6' to the point of beginning of this description; thence N 83°49'37"W, a distance of 85.0 feet; thence S 00°41'52"W, a distance of 442.4 feet to a point 50 feet, (when measured at right angles), north of the north line of said highway; thence N 86°15'E parallel with said highway a distance of 90.1 feet to the west line of said Hardin tract; thence south parallel with the north and south centerline of said Section 15, a distance of 50 feet to the north line of said highway; thence N 86°15'E, along the north line of said highway, a distance of 21.84 feet; thence N 07°04'42"E, a distance of 103.79 feet; thence N 10°25'24"E, a distance of 103.30 feet; thence N 15°55'27"W, a distance of 60.63 feet; thence N 01°35'15"E, a distance of 208.57 feet to at point which bears S 83°49'37"E, a distance of 42.92 feet from the point of beginning of this description; thence N 83°49'37"W, a distance of 42.92 feet to the point of beginning of this description.

Containing 1.29 acres.

Situate in Skagit County, Washington

The above described property will be combined with contiguous property owned by the purchaser. This boundary adjustment is not for the purpose of creating an additional building lot.

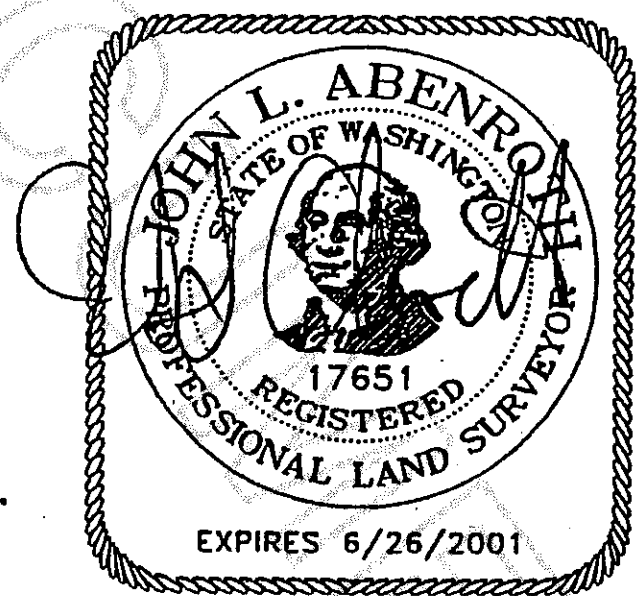

7/23/00



EXHIBIT II, cont'd
Description for
TRACT B
350515-0-010-0005

That portion of the east half of the east half of the northwest quarter of Section 15, Township 35 North, Range 5 East, W.M. described as follows:

Commencing at the southwest corner of that certain tract described in deed to Carol Hardin dated June 3, 1970 and filed in AF#777684 which point is on the north line of Minkler Road, (formerly State Highway 17-A); thence N 86°15'E along the north line of Minkler Road, a distance of 21.84 feet to the point of beginning of this description; thence N 07°04'42"E, a distance of 103.79 feet; thence N 10°25'24"E, a distance of 103.30 feet; thence N 15°55'27"W, a distance of 60.63 feet; thence N 01°35'15"E, a distance of 208.57 feet, thence S 83°49'37"E, a distance of 369.59 feet to a point on the east line of said Hardin tract; thence S 52°W along the east line of said Hardin tract, a distance of 267.80 feet to an angle point in said east line; thence S 08°W along the east line of said Hardin tract a distance of 259.87 feet to the north line of Minkler Road; thence S 86°15'W along the north line of Minkler Road, a distance of 141.41 feet to the point of beginning of this description.

EXCEPT the Puget Sound and Baker River Railway right of way to the extent excepted in quit claim deed to Carol Hardin dated February 20, 1967, and filed in AF#695123.
Containing 2.03 acres.

Situate in Skagit County, Washington.

The above described property will be combined with contiguous property owned by the purchaser. This boundary adjustment is not for the purpose of creating an additional building lot.

