

Return to:

\_\_\_\_\_  
\_\_\_\_\_  
\_\_\_\_\_



200008080091

Kathy Hill, Skagit County Auditor  
8/8/2000 Page 1 of 2 4:23:14PM

**PROTECTED CRITICAL AREA SITE PLAN**

Page 1 of 2

Grantor/Owner: Neal & Linda Harvey

Grantee: PUBLIC

Site Address: 8630 Turners Bay Place

Property ID #: P 114776 Assessors Tax Account #: 4721-000-003-0000

Legal Description: Sec. 9 Twp. 34 Rng. 2 / Plat Name Summit PK Lot 3

Permit/Activity #: SW00-0366 / BP00-0939 Div 3

PROTECTED CRITICAL AREA (PCA) is to be left undisturbed in a natural state. No clearing, grading, filling, logging or removal of woody material, building, construction or road construction of any kind or planting of non-native vegetation is allowed within the PCA areas except as specifically permitted by Skagit County on a case-by-case basis consistent with Skagit County Code 14.06.

Representations on this site plan may be approximations only and should not be used for purposes other than for determining general locations of critical areas. Development activities beyond the scope of this plan may require additional studies and approvals.

The above references to "Grantor" and "Grantee" shall not be construed as a transfer of property ownership and are used solely for filing with the County Auditor.

Owner: Neal L. Harvey Date: \_\_\_\_\_

On this day personally appeared before me Neal Harvey to be the individual described herein and acknowledged to me the he signed the same as he free and voluntary act and deed for the uses and purposes therein mentioned.

Dish Campbell, Notary Public in and for the State of Washington,  
residing at Mount Vernon Date: 8/8/00

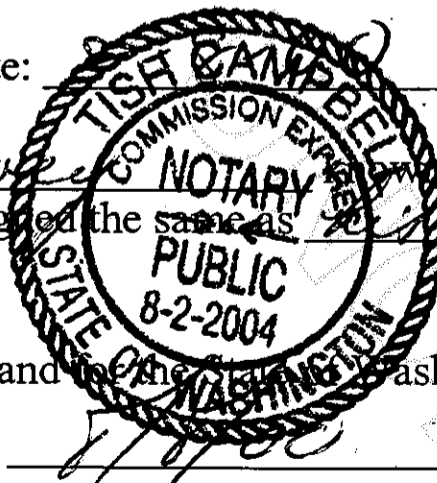
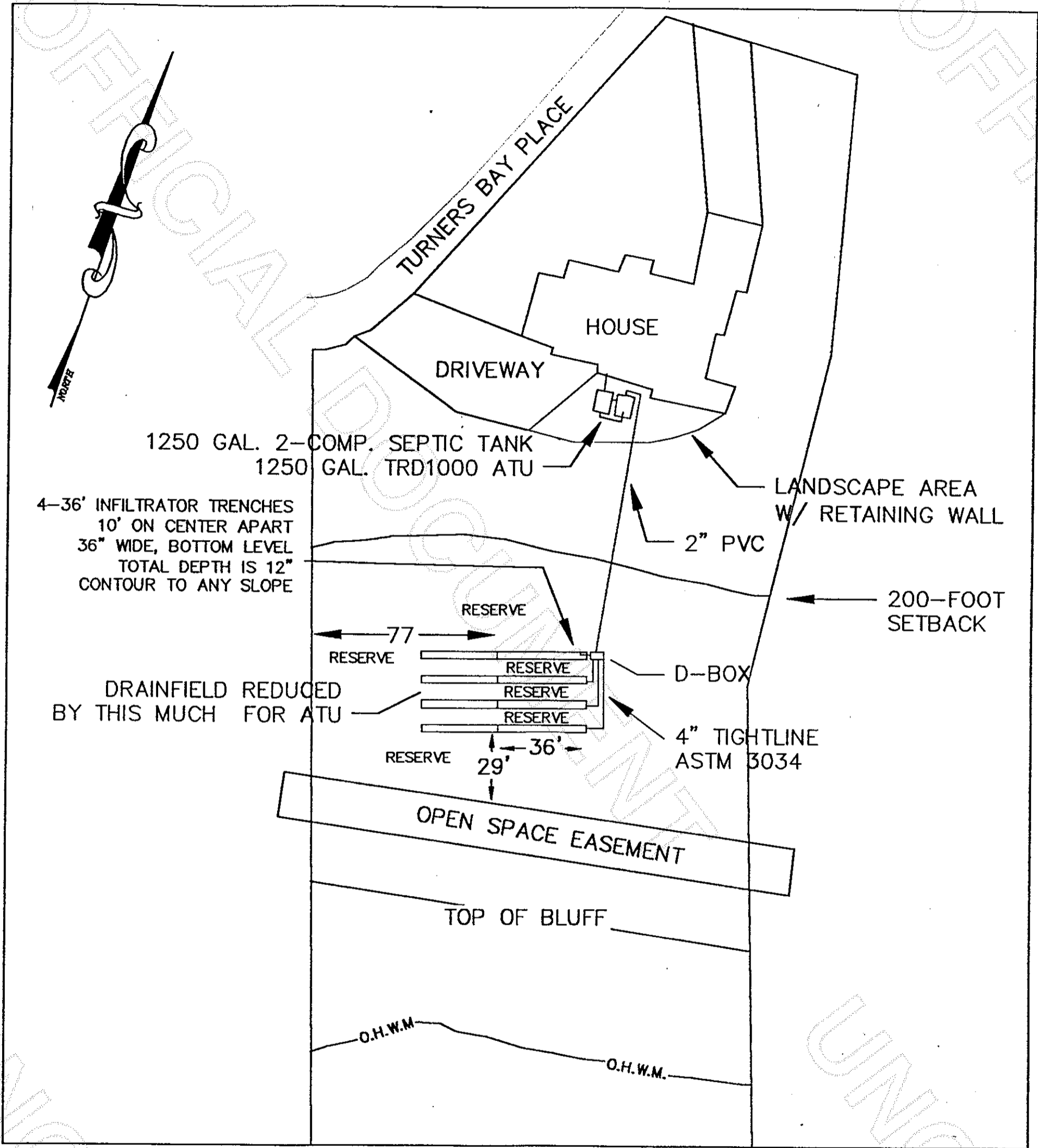

FIGURE 2: SITE VICINITY MAP



SITE PLAN PROVIDED BY SKAGIT SEPTIC SYSTEMS

drawn and prepared by  
NORTHWEST WETLAND SOLUTIONS  
1515 SOUTH 6TH  
MOUNT VERNON, WA 98273

GRAPHIC SCALE

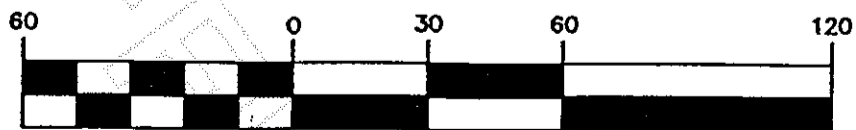

1 inch = 60 ft.

HARVEY PROPERTY  
TURNER BAY PLACE  
SKAGIT COUNTY, WASHINGTON  
AUGUST, 2000



200008080091

Kathy Hill, Skagit County Auditor