

Return to:



200006020091

Kathy Hill, Skagit County Auditor

6/2/2000 Page 1 of 2 2:55:33PM

PROTECTED CRITICAL AREA SITE PLAN

Page 1 of 2

Grantor/Owner: Robert Mount

Grantee: PUBLIC

Site Address: 5109 Guemes Island Road

Property ID #: P 61711 Assessors Tax Account #: 3855-000-006-0004

Legal Description: Sec. 36 Twp. 36 Rng. 1 / Plat Name Alverson's Camp Lot 6

Permit/Activity #: SW00-0136/BP00-0362

PROTECTED CRITICAL AREA (PCA) is to be left undisturbed in a natural state. No clearing, grading, filling, logging or removal of woody material, building, construction or road construction of any kind or planting of non-native vegetation is allowed within the PCA areas except as specifically permitted by Skagit County on a case-by-case basis consistent with Skagit County Code 14.06.

Representations on this site plan may be approximations only and should not be used for purposes other than for determining general locations of critical areas. Development activities beyond the scope of this plan may require additional studies and approvals.

The above references to "Grantor" and "Grantee" shall not be construed as a transfer of property ownership and are used solely for filing with the County Auditor.

Owner: Robert Mount

Date: 6/2/2000

On this day personally appeared before me Robert Mount the individual described herein and acknowledged to me the he signed the same as a free and voluntary act and deed for the uses and purposes therein mentioned.

Sherrell Walker

, Notary Public in and for the State of Washington

residing at Lake Stevens WA Date: 6-20-03

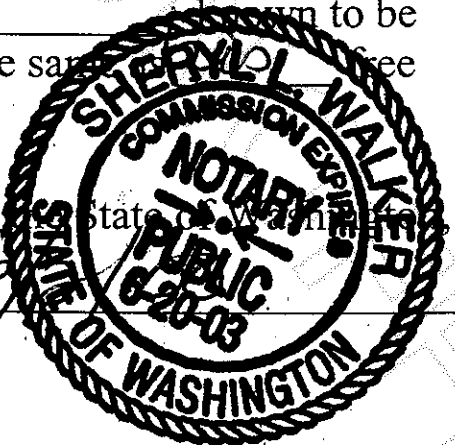

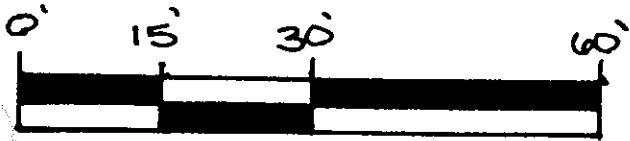

Scale: 1" = 30'



NORTH

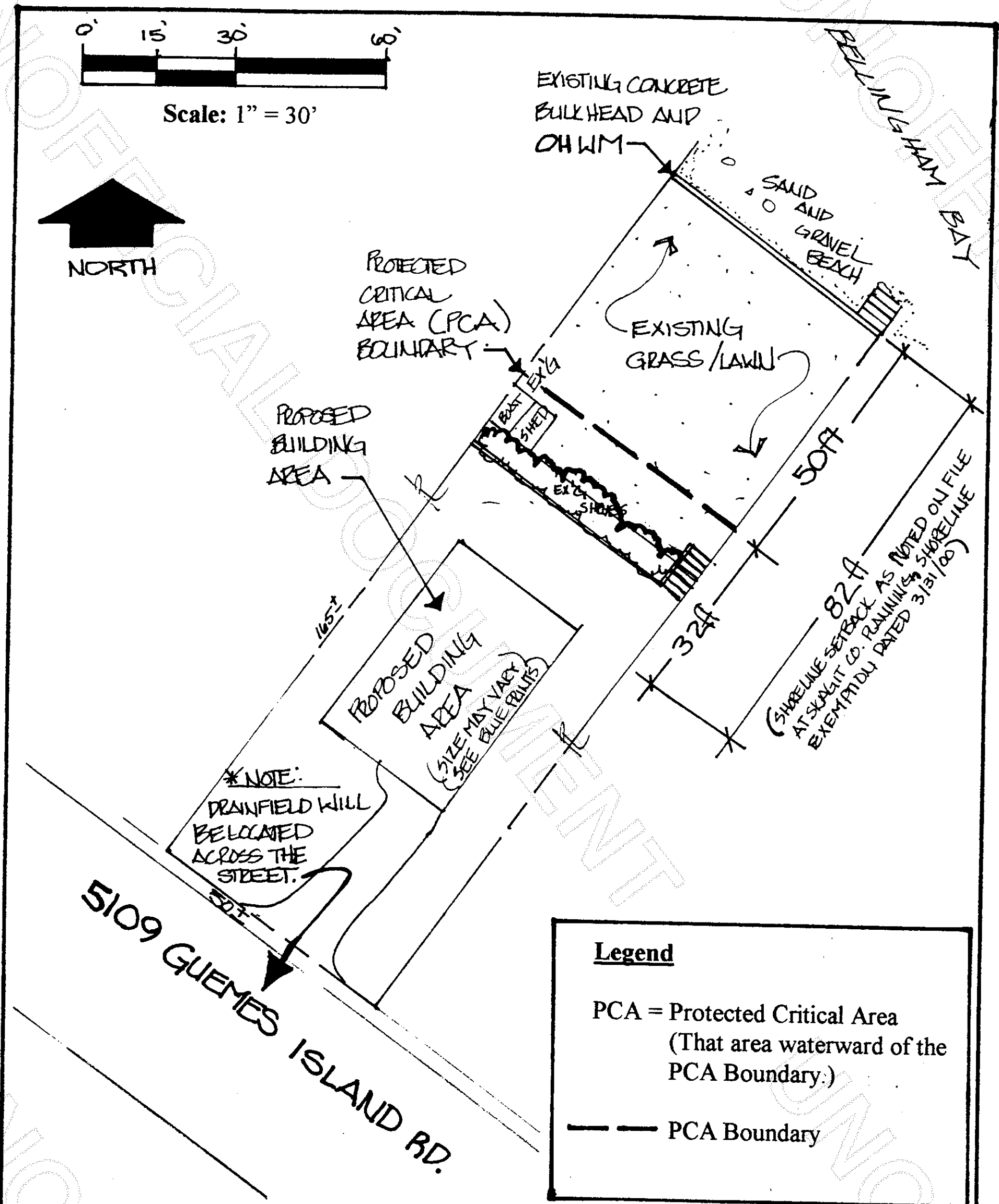

Prepared by:
Graham-Bunting & Associates
Environmental & Land Use Services
5800 Ewing Court
Edison, WA 98232

Applicant: Robert Mount
Property ID: P-61711
Building Permit No.:00-0362

Fish & Wildlife
Site Assessment

Site Plan
May 2000



200006020091

Kathy Hill, Skagit County Auditor
6/2/2000 Page 2 of 2 2:55:33PM

Attachment C