

SURVEY IN THE SW 1/4 SEC. 25, TWP. 35 N., RNG. 1 E., W.M.

LEGAL DESCRIPTIONS AFTER BOUNDARY LINE ADJUSTMENT.

PARCEL A:
A PORTION OF THE WEST 1/2 OF THE S. E. 1/4 OF THE S. W. 1/4 AND THE EAST 1/2 OF THE S. W. 1/4 OF THE S. W. 1/4 OF SECTION 25, TOWNSHIP 35 NORTH, RANGE 1 EAST, W.M., DESCRIBED AS FOLLOWS:

COMMENCING AT THE N.E. CORNER OF THE S. E. 1/4 OF THE S. W. 1/4 OF SAID SECTION; THENCE S 89° 07' 17" W 1460.26 FEET; THENCE S 0° 48' 32" E 290.00 FEET TO THE POINT OF BEGINNING; THENCE S 89° 09' 17" W 192.17 FEET TO THE WEST BOUNDARY OF SHORT PLAT ANA 83-006 AS RECORDED IN VOLUME 6 ON PAGE 94, OF SHORT PLATS RECORDED UNDER AUDITOR'S FILE # 8310260052; THENCE N 0° 22' 02" W 260.00 FEET ALONG SAID SHORT PLAT TO THE SOUTH RIGHT OF WAY OF 41ST STREET; THENCE N 89° 09' 17" E ALONG SAID RIGHT OF WAY 190.17 FEET; THENCE S 0° 48' 32" E 260.00 FEET TO THE POINT OF BEGINNING.

SUBJECT TO AN EASEMENT FOR ROAD OVER THE EAST 25 FEET OF THIS TRACT AS RECORDED UNDER AUDITOR'S FILE # 665998.
SITUATE IN THE COUNTY OF SKAGIT, STATE OF WASHINGTON.

PARCEL B:
A PORTION OF THE WEST 1/2 OF THE S. E. 1/4 OF THE S. W. 1/4 AND THE EAST 1/2 OF THE S. W. 1/4 OF THE S. W. 1/4 OF SECTION 25, TOWNSHIP 35 NORTH, RANGE 1 EAST, W.M., DESCRIBED AS FOLLOWS:

COMMENCING AT THE N.E. CORNER OF THE S. E. 1/4 OF THE S. W. 1/4 OF SAID SECTION; THENCE S 89° 07' 17" W 1460.26 FEET; THENCE S 0° 48' 32" E 575.00 FEET TO THE POINT OF BEGINNING; THENCE S 89° 09' 17" W 194.37 FEET TO THE WEST BOUNDARY OF THE PLAT OF PARKSIDE DIVISION # 2. THENCE N 0° 22' 02" W 285.00 FEET ALONG SAID PLAT, AND THE EAST BOUNDARY OF SHORT PLAT ANA 83-006 AS RECORDED IN VOLUME 6 ON PAGE 94, OF SHORT PLATS RECORDED UNDER AUDITOR'S FILE # 8310260052. THENCE N 89° 09' 17" E 192.17 FEET; THENCE S 0° 48' 32" E 285.00 FEET TO THE POINT OF BEGINNING.

SUBJECT TO AN EASEMENT FOR ROAD OVER THE EAST 25 FEET OF THIS TRACT AS RECORDED UNDER AUDITOR'S FILE # 665998.
SITUATE IN THE COUNTY OF SKAGIT, STATE OF WASHINGTON.

PARCEL C:
BEGINNING AT THE N.E. CORNER OF LOT # 1 OF ANACORTES SHORT PLAT ANA 83-006 AS RECORDED IN BOOK 6 ON PAGE 94, OF SHORT PLATS RECORDED UNDER AUDITOR'S FILE # 8310260052, BEING A PORTION OF THE WEST 1/2 OF S.E. 1/4 OF THE S.W. 1/4 AND THE EAST 1/2 OF THE S.W. 1/4 OF SECTION 25, TOWNSHIP 35 NORTH, RANGE 1, EAST, W.M. THENCE S 0° 48' 32" E 290.00 FEET ALONG THE EAST LINE OF SAID SHORT PLAT TO THE SOUTHEAST CORNER OF SAID LOT 1; THENCE S 89° 09' 17" W 196.61 FEET ALONG THE SOUTH LINE OF SAID LOT 1 EXTENDED, TO THE EAST BOUNDARY OF THE PLAT OF PARKSIDE DIVISION # 2.

THENCE N 0° 22' 02" W 290.00 FEET ALONG SAID PLAT BOUNDARY TO THE NORTH LINE OF SAID LOT 1 EXTENDED; THENCE N 89° 07' 17" E 194.37 FEET TO THE POINT OF BEGINNING.
SUBJECT TO THE EAST 25 FEET FOR ROAD EASEMENT AS SHOWN ON SHORT PLAT ANA 83-006
SITUATE IN THE COUNTY OF SKAGIT, STATE OF WASHINGTON

PARCEL D:
BEGINNING AT THE N.E. CORNER OF LOT # 2 OF ANACORTES SHORT PLAT ANA 83-006 AS RECORDED IN BOOK 6 ON PAGE 94, OF SHORT PLATS RECORDED UNDER AUDITOR'S FILE # 8310260052, BEING A PORTION OF THE WEST 1/2 OF S.E. 1/4 OF THE S.W. 1/4 AND THE EAST 1/2 OF THE S.W. 1/4 OF SECTION 25, TOWNSHIP 35 NORTH, RANGE 1, EAST, W.M. THENCE S 0° 48' 32" E 290.00 FEET ALONG THE EAST LINE OF SAID SHORT PLAT TO THE SOUTHEAST CORNER OF SAID LOT 2; THENCE S 89° 09' 17" W 198.84 FEET ALONG THE SOUTH LINE OF SAID LOT 2 EXTENDED, TO THE EAST BOUNDARY OF THE PLAT OF PARKSIDE DIVISION # 2.

THENCE N 0° 22' 02" W 290.00 FEET ALONG SAID PLAT BOUNDARY TO THE NORTH LINE OF SAID LOT 2 EXTENDED; THENCE N 89° 07' 17" E 196.61 FEET TO THE POINT OF BEGINNING.
SUBJECT TO THE EAST 25 FEET FOR ROAD EASEMENT AS SHOWN ON SHORT PLAT ANA 83-006
SITUATE IN THE COUNTY OF SKAGIT, STATE OF WASHINGTON

RECORDER'S CERTIFICATE

Filed for record this _____ day of _____ 19____ at _____ M
In book _____ of _____ at the request of: _____
CLAIR A. CROSSMAN
SURVEYOR'S NAME
RECORDS OF SKAGIT CO. AUD.

SURVEYORS CERTIFICATE

This map correctly represents a survey made by me or under my direction in conformance with the requirements of the Survey Recording Act at the request of: Richard H. PUTNEY
In Dec. 1999
David L. Putney
Certificate No. 9569

CONSENT

KNOW ALL PERSONS BY THESE PRESENTS THAT WE THE UNDERSIGNED OWNERS HEREBY CERTIFY THAT THIS BOUNDARY LINE ADJUSTMENT IS MADE AS OUR FREE AND VOLUNTARY ACT AND DEED.

Raymond M. Putney
LAVON MERTENS

Richard H. Putney
PAMELA L. PUTNEY

Ronald Carr
SALLYCARR

Donald F. Escher (Trustee)
ESCHER DAUGHTERS TRUST, BY DONALD F. ESCHER (TRUSTEE)

ACKNOWLEDGEMENT

STATE OF WASHINGTON, COUNTY OF SKAGIT
I CERTIFY THAT I KNOW OR HAVE SATISFACTORY EVIDENCE
RODGER MERTENS AND LAVON MERTENS, HUSBAND AND WIFE, SIGNED THIS INSTRUMENT AND ACKNOWLEDGE IT TO BE THEIR VOLUNTARY ACT FOR THE USES AND PURPOSES MENTIONED IN THE INSTRUMENT.

DATED: March 3, 2000
SIGNATURE: _____
TITLE: _____
MY APPOINTMENT EXPIRES: _____

ACKNOWLEDGEMENT

STATE OF WASHINGTON, COUNTY OF SKAGIT
I CERTIFY THAT I KNOW OR HAVE SATISFACTORY EVIDENCE
RICHARD H. PUTNEY AND PAMELA L. PUTNEY, HUSBAND AND WIFE, SIGNED THIS INSTRUMENT AND ACKNOWLEDGE IT TO BE THEIR VOLUNTARY ACT FOR THE USES AND PURPOSES MENTIONED IN THE INSTRUMENT.

DATED: March 3, 2000
SIGNATURE: _____
TITLE: _____
MY APPOINTMENT EXPIRES: _____

ACKNOWLEDGEMENT

STATE OF WASHINGTON, COUNTY OF SKAGIT
I CERTIFY THAT I KNOW OR HAVE SATISFACTORY EVIDENCE
RONALD CARR AND SALLY CARR, HUSBAND AND WIFE, SIGNED THIS INSTRUMENT AND ACKNOWLEDGE IT TO BE THEIR VOLUNTARY ACT FOR THE USES AND PURPOSES MENTIONED IN THE INSTRUMENT.

DATED: March 3, 2000
SIGNATURE: _____
TITLE: _____
MY APPOINTMENT EXPIRES: _____

ACKNOWLEDGEMENT

STATE OF WASHINGTON, COUNTY OF SKAGIT
I CERTIFY THAT I KNOW OR HAVE SATISFACTORY EVIDENCE
DONALD F. ESCHER, TRUSTEE FOR THE ESCHER DAUGHTERS TRUST, SIGNED THIS INSTRUMENT AND ACKNOWLEDGE IT TO BE HIS VOLUNTARY ACT FOR THE USES AND PURPOSES MENTIONED IN THE INSTRUMENT.

DATED: March 3, 2000
SIGNATURE: _____
TITLE: _____
MY APPOINTMENT EXPIRES: _____

ACCEPTANCE

THIS BOUNDARY LINE ADJUSTMENT IS HEREBY EXAMINED AND APPROVED FOR ACCEPTANCE THIS 12 DAY OF APRIL 2000

David L. Putney
DAVID L. PUTNEY CITY ENGINEER
IAN MUNCE SUBDIVISION ADMINISTRATOR

CROSSMAN & ASSOC.

LAND SURVEYORS
16146 MCLEAN RD. MT. VERNON, WA.
PHONE (360) 424-7359

ANACORTES BLA
DATE:

200004190067
Kathy Hill, Skagit County Auditor
4/19/2000 Page 2 of 2 1:49:49PM

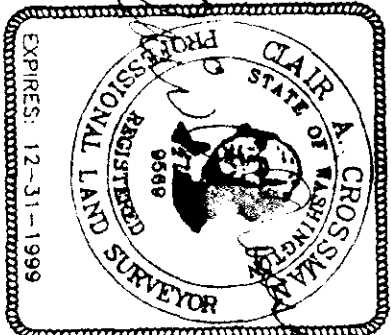

BOUNDARY SURVEY FOR
MERTENS, PUTNEY, CARR & ESCHER

THIS BOUNDARY LINE ADJUSTMENT IS FOR THE PURPOSE OF
CORRECTING A ONE ROD WIDE GAP IN LEGAL DESCRIPTIONS.
SEE QUIET TITLE ACTION RECORDED UNDER AUDITOR'S FILE
9907190122, AND QUIT CLAIM DEED # 199907230052

SCALE	DATE	JOB NO.
1"=100'	12-7-99	99-17
DRAWN BY: Sam	CHECKED BY: C.A.C.	SHEET: 2 OF 2