

NORTH 1/4 COR. SECTION 36
FOUND 3/4" IRON PIPE
12-10-99

S 85°59'05"E
2756.51

Kathy Hill, Skagit County Auditor
200001180043
1/18/2000 Page 1 of 1 10:35:02AM

NE COR. SECTION 36
MON. IN CASE IS OVERLAPED.
FIELD POSITION OF PREVIOUS
SURVEYS.

2903.50

approximate location of
graveled roadbed.

N 00°14'17"E 725.875

1294

S 89°55'09"E 2674.14
S 89°55'09"E 2703.73 (to section line)

S 88°35'27"E 2719.88 (to section line)
S 88°35'27"E 2399.88

FENCE WITHIN 10 FT. OF PROP. LINE

N 01°35'10"E
150.00
EXCEPTION
(A.F. #713951)
S 88°35'27"E
291.61

N 01°43'04"E 513.75'

S.R. #9

N 01°35'10"E
(section line)

N 00°14'17"E 725.875

N 00°14'17"E

N 88°44'15"E
2684.33

N 88°44'15"E
2689.04

EAST 1/4 SECTION 36
FOUND MONUMENT IN CASE
UNDER NEW ASPHALT
DEC.10,1999

311'

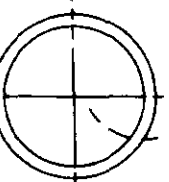

WEST 1/4 SECTION 36
FOUND 1" IRON PIPE
ON NORTH FACE OF
CORNER FENCE POST
12-10-99

CENTER SECTION 36

VICINITY MAP
SECTION 36, T.36N., R.4E., W.M.

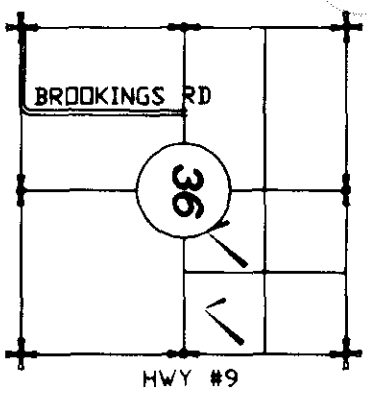

SOUTH 1/4 COR. SECTION 36
FOUND CONC. MON 10" ABOVE GROUND
FEB.1,1991

0 200 400 600

AUDITOR'S CERTIFICATE

Filed for record this 11 day of Jan 2000
at 10:35 AM in book of Surveys at page
at the request of AZIMUTH NORTHWEST, INC.
A.F. NO. 200001180043

Kathy Hill
SKAGIT COUNTY AUDITOR

Deputy
DEPUTY

SURVEYOR'S CERTIFICATE

This map correctly represents a survey made by me
or under my direction in conformance with the
requirements of the SURVEY RECORDING ACT of the
request of MAE GREATHOUSE
IN DEC 1999

Stuart B. VanBuren, Jr., P.L.S.
Certificate No. 21591

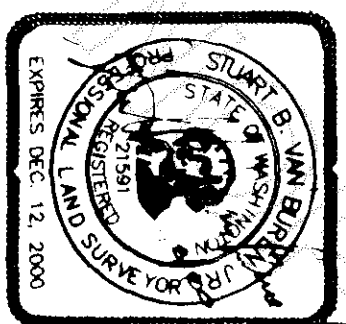

AZIMUTH
NORTHWEST, INC.
17963 WOOD ROAD
BOW, WA. 98232
[360] 724-7320

NOTES:

1. DENOTES REBAR AND CAP IMPRINTED 'AZIMUTH N.W. 21591' SET
THIS SURVEY.

2. DENOTES FENCES.

3. THIS SURVEY PERFORMED BY FIELD TRAVERSE USING A 3 SECOND
ELECTRONIC DISTANCE MEASURING THEODOLITE.

4. BASIS OF BEARING NORTH 1 DEGREE 35'10" EAST ALONG THE
MONUMENTED EAST LINE OF THE NORTHEAST QUARTER OF SECTION 36,
TOWNSHIP 36 NORTH, RANGE 4 EAST, W.M.

5. LEGAL DESCRIPTION OF PROPERTY FROM WARRANTY DEED RECORDED
UNDER AUDITOR'S FILE NO. 529639 IN VOLUME 275 AT PAGE 605, AND
FROM QUIT CLAIM DEED RECORDED MAY 23, 1968 UNDER AUDITOR'S
FILE NO. 713951.

THIS SURVEY DEPICTS EXISTING FENCE AND OTHER OCCUPATIONAL
INDICATORS IN ACCORDANCE WITH WAC 332.130. THESE OCCUPATIONAL
INDICATORS MAY INDICATE A POTENTIAL FOR CLAIMS OF UNWRITTEN
TITLE. LEGAL OWNERSHIP BASED UPON UNWRITTEN TITLE CLAIMS HAVE
NOT BEEN RESOLVED BY THIS SURVEY.

SURVEY IN THE N.E. QUARTER
SECTION 36 T.36N., R.4E., W.M.
SKAGIT COUNTY, WASHINGTON
FOR
MAE GREATHOUSE

DWG: 0529R0S.DWG DATE: DEC.,1999 SHEET 1 OF 1

CHECKED: SVB SCALE: 1" = 200' JOB NO. 99.0529