

**AUDITOR'S CERTIFICATE**  
 FILED FOR RECORD THIS 2 DAY OF June 1999.  
 V. 22 Survey Pg 6  
 AT 10:40 AM, AT THE REQUEST OF LARRY STEELE AND ASSOCIATES, LAND SURVEYORS, RECORDED UNDER AUDITOR'S FILE NUMBER 9906020021.  
 Kathy Hill  
 SKAGIT COUNTY AUDITOR'S OFFICE

**SURVEYOR'S CERTIFICATE**  
 THIS MAP CORRECTLY REPRESENTS A SURVEY MADE BY ME OR UNDER MY DIRECTION AND IN CONFORMANCE WITH THE REQUIREMENTS OF THE SURVEY RECORDING ACT, AT THE REQUEST OF RUTH MORRISON AND M.A. WEBER IN FEBRUARY, 1999.  
 Lawrence W. Steele  
 LAURENCE W. STEELE, P.L.S., CERTIFICATE NO. 13138

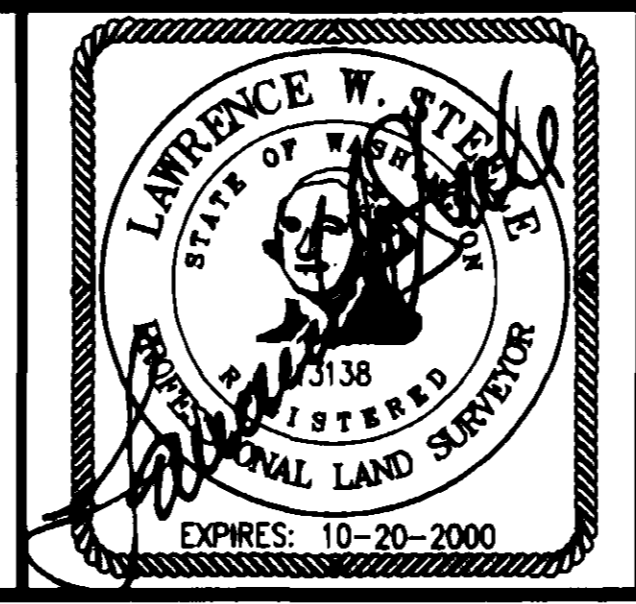

**LARRY STEELE & ASSOCIATES**  
 LAND SURVEYORS

SUITE 104  
 1323 LINCOLN ST.  
 BELLINGHAM, WA 98226  
 360-616-5380

BEING A PORTION OF THE NE 1/4 OF THE SW 1/4 AND THE SW 1/4 OF THE SW 1/4 AND THE SE 1/4 OF THE SW 1/4 OF SEC. 20, T.36N., R.4E., W.M., SKAGIT COUNTY, WASH.

**RECORD OF SURVEY**  
 FOR  
 RUTH MORRISON/M.A. WEBER

DRWN BY BRS	DATE 4/22/99	JOB NO. 14098 & 100699
CHKD BY LWS	SCALE 1" = 200'	SHEET 1 OF 1