

9712300093

Survey in the SE1/4 of the NE1/4 of Section 20, Twp. 33 N., Rng. 4 E., W.M.

Short Plat No. 97-0042

97 DEC 30 P2:43

Legal Description

The South 1/2 of the South 1/2 of the Southeast 1/4 of the Northeast 1/4 of Section 20, Township 33 North, Range 4 East, W.M., EXCEPT logging railroad right of way now owned by Georgia Pacific Corporation AND EXCEPT roads.

Notes

- Short plat number and date of approval shall be included in all deeds and contracts.
- All maintenance and construction of roads shall be the responsibility of the homeowners association with the lot owners as members.
- Basis-of-bearings - Assumed S02°34'48"W on the East line of the Northeast Quarter of Section 20.
- Zoning - Rural (RU)
- Sewer - Lot 1 = Lot 1 of this short plat has an existing alternative system in place at this time and is located approximately as shown on sheet 2 of this short plat.
Lot 2 = An alternative system is proposed for Lot 2 of this short plat which may have special design, construction, and maintenance requirements, see Health Officer for details.
- This survey was accomplished by field traverse using: 2 second digital electronic Total Station.
- No building permit shall be issued for any residential and/or commercial structures which are not, at the time of application, determined to be within an official designated boundary of a Skagit County Fire District.
- Change in location of access, may necessitate a change of address, contact Skagit County Public Works.
- Water - Public Utility District No. 1 of Skagit County.
- This Property may be subject to instruments recorded as follows: AF#563800; AF#646781; AF#778401.
- Potential buyers should recognize that a creek meanders through this short subdivision and may be subject to periodic channel changes and intermittent flooding. Building sites may be limited based on creek channel migration.

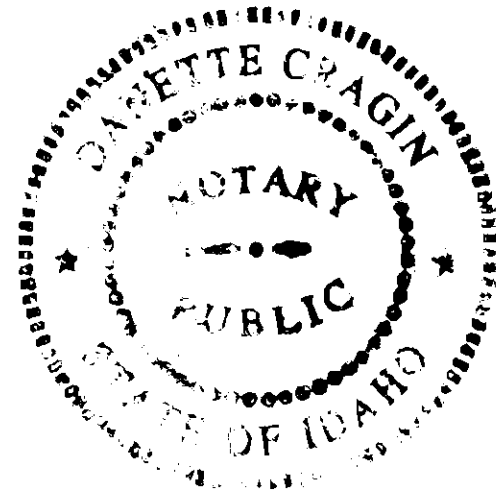

State of Idaho, County of ADA
I certify that I know or have satisfactory evidence that Marty Thomason
signed this instrument, on oath stated that he/she was authorized
to execute the instrument and acknowledged it as the Vice President
of U.S. Bancorp Home Loans
to be the free and voluntary act of such party for the uses and purposes mentioned in the instrument.
Notary signature Darlette Cragin
Title Dept. Specialist Date 9/25/97
My appointment expires 1/8/02

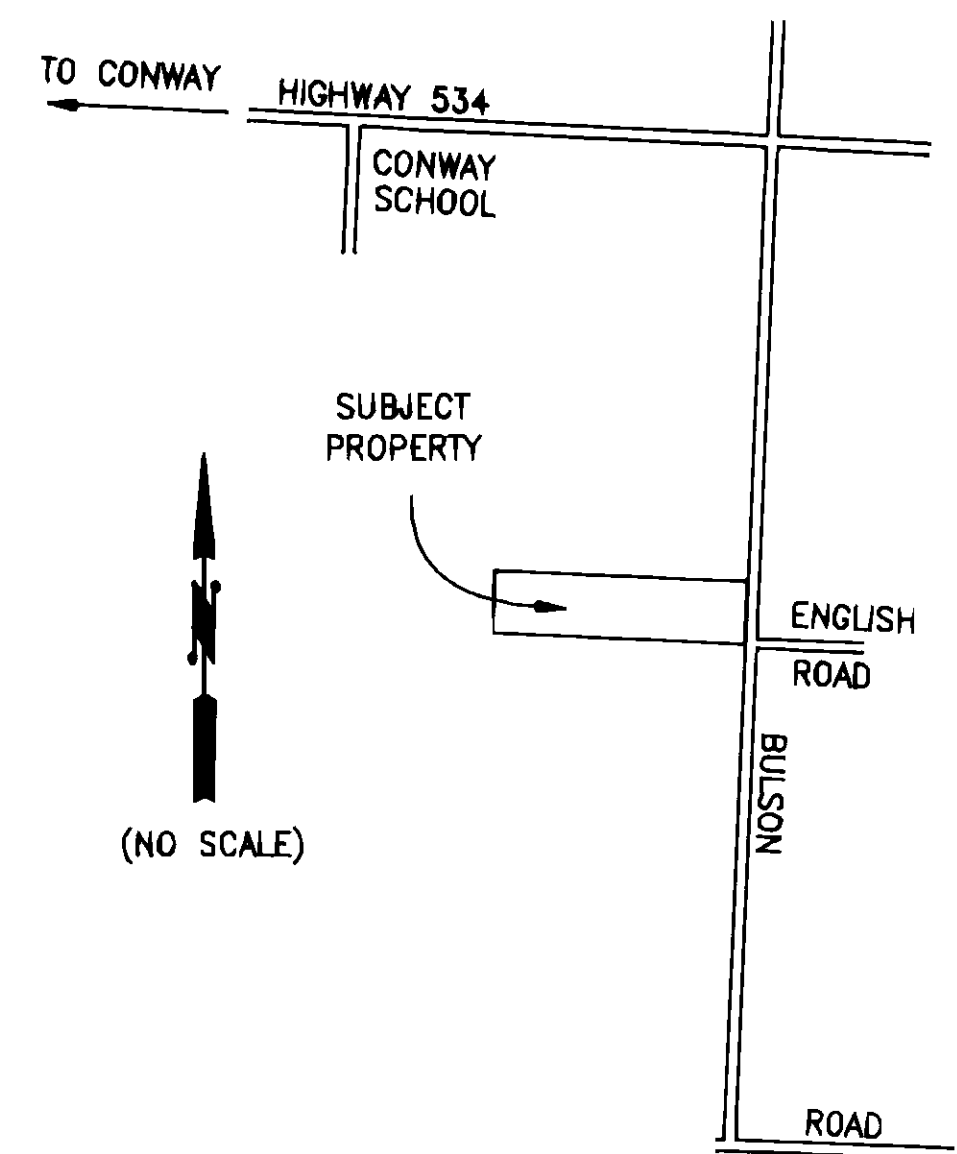

Consent

Know all men by these presents that we the undersigned subdividers hereby certify that this short plat is made as our free and voluntary act and deed.

Guilford Herschel Traylor
GUILFORD H. TRAYLOR
Anne Marie Traylor
ANNE MARIE TRAYLOR
Marty Thomason Vice President
U.S. BANCORP HOME LOANS
Frank Brown Vice President
U.S. BANK OF WASHINGTON, NATIONAL ASSOCIATION

Acknowledgements

State of Washington, County of SKAGIT I certify that I know or have satisfactory evidence that Guilford H. Traylor & Anne M. Traylor H.W. signed this instrument and acknowledged it to be his/her free and voluntary act for the uses and purposes mentioned in the instrument.

Notary signature [Signature] Title Notary
Date Sept. 12, 1997 My appointment expires Nov. 1, 1999

State of Washington, County of _____ I certify that I know or have satisfactory evidence that _____ signed this instrument and acknowledged it to be his/her free and voluntary act for the uses and purposes mentioned in the instrument.

Notary signature _____ Title _____
Date _____ My appointment expires _____

State of Idaho, County of Whitman
I certify that I know or have satisfactory evidence that Bene R. Horn
signed this instrument, on oath stated that he/she was authorized
to execute the instrument and acknowledged it as the Vice President
of U.S. Bank of Washington, National Association
to be the free and voluntary act of such party for the uses and purposes mentioned in the instrument.

Notary signature [Signature] Title Vice President Date 9-19-97
My appointment expires 9-19-00

Treasurer's Certificate

This is to certify that all taxes heretofore levied and which have become a lien on the lands herein described have been fully paid and discharged according to the records of my office up to and including the year 1997.

[Signature]
Skagit County Treasurer

Approvals

The within and foregoing short plat is approved in accordance with the provisions of the Skagit County Short Plat Ordinance this 24 day of December 1997.

[Signature]
Short Plat Administrator

James P. Kauba 12-19-97
County Engineer

Short Plat for
Guilford & Anne Traylor

AUDITOR'S CERTIFICATE
Filed for record this 30 day of Dec 1997 at 2:43 minutes past 2 o'clock P.m. and recorded in Volume 13 of Short Plats at page 97-0042 records of Skagit County, Wa.
[Signature]
County Auditor or Deputy Auditor
A.F. # 9712300093

SURVEYOR'S CERTIFICATE
This map correctly represents a survey made by me or under my direction in conformance with the Survey Recording Act in May 1997 at the request of Guilford and Anne Traylor
John L. Abernath CERT#17651
Date 5/12/97



Skagit Surveyors & Engineers LLC
806 Metcalf St., Sedro-Woolley, WA 98284 Phone: (360) 855-2121 FAX: (360) 855-1658

DATE	REVISION	BY	JOB#	DRAWN	CHECKED	DATE	SCALE	SHEET
			97076	fm	LHR/JLA	01MAY97		1 OF 2

u113 SP pg 82

Survey in the SE1/4 of the NE1/4 of Section 20, Twp. 33 N., Rng. 4 E., W.M.

Short Plat No. 97-0042

Addresses

LOT 1 = 2150 BULSON ROAD
LOT 2 = 2146 BULSON ROAD

7/25/86
FOUND 2" IRON PIPE, LEAD AND
COPPER TACK IN CASE
AND COVER

FOUND 1" IRON PIPE LEAD AND
TACK IN CASE AND COVER
7/25/86

S8703'26"E 2753.49'

1376.74

1376.74

S8716'24"E

1366.61

S8726'18"E 1329.02'

1366.61

S8726'18"E 1329.02'

1366.61

S8726'18"E 1329.02'

1366.61

S8726'18"E 1329.02'

1366.61

S8726'18"E 1329.02'

1366.61

S8726'18"E 1329.02'

1366.61

S8726'18"E 1329.02'

1366.61

S8726'18"E 1329.02'

1366.61

S8726'18"E 1329.02'

1366.61

S8726'18"E 1329.02'

1366.61

S8726'18"E 1329.02'

1366.61

S8726'18"E 1329.02'

1366.61

S8726'18"E 1329.02'

1366.61

S8726'18"E 1329.02'

1366.61

S8726'18"E 1329.02'

1366.61

S8726'18"E 1329.02'

1366.61

S8726'18"E 1329.02'

1366.61

S8726'18"E 1329.02'

1366.61

1333.04'

1333.04'

1333.04'

1333.04'

1333.04'

1333.04'

1333.04'

1333.04'

1333.04'

1333.04'

1333.04'

1333.04'

1333.04'

1333.04'

1333.04'

1333.04'

1333.04'

1333.04'

1333.04'

1333.04'

1333.04'

1333.04'

1333.04'

1333.04'

1333.04'

1333.04'

1333.04'

1333.04'

1333.04'

1333.04'

1333.04'

1333.04'

1333.04'

1333.04'

1333.04'

1333.04'

1333.04'

1333.04'

1333.04'

1333.04'

1333.04'

1333.04'

1333.04'

1333.04'

1333.04'

1333.04'

1333.04'

1333.04'

1333.04'

1333.04'

1333.04'

1333.04'

1333.04'

1333.04'

1333.04'

1333.04'

1333.04'

1333.04'

1333.04'

1333.04'

1333.04'

1333.04'

1333.04'

1333.04'

1333.04'

1333.04'

1333.04'

1333.04'

1333.04'

1333.04'

1333.04'

1333.04'

1333.04'

1333.04'

1333.04'

1333.04'

1333.04'

1333.04'

1333.04'

1333.04'

1333.04'

1333.04'

1333.04'

1333.04'

1333.04'

1333.04'

1333.04'

1333.04'

1333.04'

1333.04'

1333.04'

1333.04'

1333.04'

1333.04'

1333.04'

1333.04'

1333.04'

1333.04'

1333.04'

1333.04'

1333.04'

1333.04'

1333.04'

1333.04'

1333.04'

1333.04'

1333.04'

1333.04'

1333.04'

1333.04'

1333.04'

1333.04'

1333.04'

1333.04'

1333.04'

1333.04'

1333.04'

1333.04'

1333.04'

1333.04'

1333.04'

1333.04'

1333.04'

1333.04'

1333.04'

1333.04'

1333.04'

1333.04'

1333.04'

1333.04'

1333.04'

1333.04'

1333.04'

1333.04'

1333.04'

1333.04'

1333.04'

1333.04'

1333.04'

1333.04'

1333.04'

1333.04'

1333.04'

1333.04'

1333.04'

1333.04'

1333.04'

1333.04'

1333.04'

1333.04'

1333.04'

1333.04'

1333.04'

1333.04'

1333.04'

1333.04'

1333.04'

1333.04'

1333.04'

1333.04'

1333.04'

1333.04'

1333.04'

1333.04'

1333.04'

1333.04'

1333.04'

1333.04'

1333.04'

1333.04'

1333.04'

1333.04'

1333.04'

1333.04'

1333.04'

1333.04'

1333.04'

1333.04'

1333.04'

1333.04'

1333.04'

1333.04'

1333.04'

1333.04'

1333.04'

1333.04'

1333.04'

1333.04'

1333.04'

1333.04'

1333.04'

1333.04'

1333.04'

1333.04'

1333.04'

1333.04'

1333.04'

1333.04'

1333.04'

1333.04'

1333.04'

1333.04'

1333.04'

1333.04'

1333.04'

1333.04'

1333.04'

1333.04'

1333.04'

1333.04'

1333.04'

1333.04'

1333.04'

1333.04'

1333.04'

1333.04'

1333.04'

1333.04'

1333.04'

1333.04'

1333.04'

1333.04'

1333.04'

1333.04'

1333.04'

1333.04'

1333.04'

1333.04'

1333.04'

1333.04'

1333.04'

1333.04'

1333.04'

1333.04'

1333.04'

1333.04'

1333.04'

1333.04'

1333.04'

1333.04'

1333.04'

1333.04'

1333.04'

1333.04'

1333.04'

1333.04'

1333.04'

1333.04'

1333.04'

1333.04'

1333.04'

1333.04'

1333.04'

1333.04'

1333.04'

1333.04'

1333.04'

1333.04'

1333.04'

1333.04'

1333.04'