

**ACKNOWLEDGEMENT**

State of Washington, County of Skagit, ss.

On This 30 day of June, 1993

personally appeared before me LEROY SHELTON AND DOLORES SHELTON, to me known to be the individuals described in and executed within and foregoing instrument and acknowledged to me they signed the same as their free voluntary act and deed, for the uses and purposes therein mentioned.

Betty J. Smith  
Notary Public in and for the State of Washington,  
residing at Bellingham, wa

Commission Expires: 10/22/95

**APPROVALS**

Examined and approved this 29th day of December, 1993  
by the Planning Department of Skagit County, Washington

Examined and approved this 17th day of December, 1993  
by the County Engineer of Skagit County, Washington

**TREASURER'S CERTIFICATE**

This is to certify that all taxes here-to-fore levied and which have become a lien upon the lands herein described have been fully paid and discharged according to records of my office up to and including the year of 1993

This 21 day of Dec., 1993

**NOTES:**

- 1) SHORT PLAT NUMBER AND DATE OF APPROVAL SHALL BE INCLUDED IN ALL DEEDS AND CONTRACTS
- 2) ALL MAINTENANCE AND CONSTRUCTION OF PRIVATE ROADS SHALL BE THE RESPONSIBILITY OF THE LOT OWNERS
- 3) SEWER - INDIVIDUAL ON-SITE SYSTEMS
- 4) NO BUILDING PERMIT SHALL BE ISSUED FOR ANY RESIDENTIAL AND/OR COMMERCIAL STRUCTURES WHICH ARE NOT, AT THE TIME OF APPLICATION, DETERMINED TO BE WITHIN AN OFFICIAL DESIGNATED BOUNDARY OF A SKAGIT COUNTY FIRE DISTRICT. AS PER SKAGIT COUNTY CODE 14.08.080 1 (c).

**OWNER'S CERTIFICATE**

Know all men by these presents, that we, the undersigned, owners of the land included within this SHORT PLAT do hereby CERTIFY that the decision to make this SHORT PLAT was our free act and deed, and in witness whereof we have caused our names to be hereunto subscribed this

\_\_\_\_\_ day of \_\_\_\_\_, 19\_\_\_\_

Leroy Shelton  
LEROY SHELTON

Dolores Shelton  
DOLORES SHELTON

**OWNER - DEVELOPER**

LeRoy Shelton  
910 N. Lk. Samish Dr. #48  
Bellingham, WA 98226  
Phone: (206) 733-5879

CURVE	DELTA	ANGLE	RADIUS	ARC	TANGENT	CHORD	CHORD BEARING
C 3	09° 48'	26"	543.00'	92.94'	46.59'	92.83'	S 13° 51' 10" W
C 4	16° 00'	00"	603.00'	168.39'	84.75'	167.84'	N 10° 45' 23" E

**AUDITOR'S CERTIFICATE**

Filed for the record this 29 day of Dec, 1993, at 15 minutes past 9 O'clock A.M. in Volume 11 of Short Plats at page 35 and recorded under Auditors File Number 93/2290015 at the request of Conrad Koehn.

Jerry McInturff  
Auditor, Skagit County  
by: Cynthia J. August

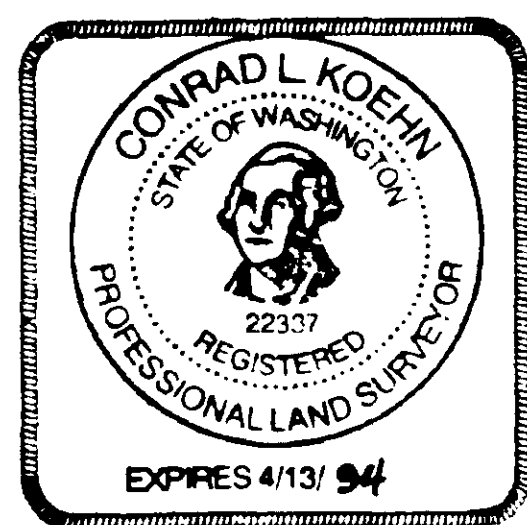

**SURVEYOR'S CERTIFICATE**

This map correctly represents a survey made by me or under my direction in conformance with the requirements of Skagit County Code 14.08 Short Subdivision Ordinance, at the request of Leroy Shelton.

Conrad Koehn  
Conrad Koehn P.L.S.  
License No. 22337

SHORT PLAT NO. 93-063

**LEROY SHELTON SHORT PLAT**  
PORTION OF THE E 1/2 OF THE NW 1/4 OF THE NE 1/4 OF SEC. 25, TWN. 36N., RNG. 4E., W.M. SKAGIT COUNTY, WASHINGTON

