

9010020054

Survey in the NW1/4 of the NE1/4 (Gov't Lot 2) of Section 1, Twp. 34 N., Rng. 4 E., W.M. Short Plat No. 90-47
Date 10/2/90

AUDITOR'S CERTIFICATE
Filed for record this 24 day of October 1990 at 4:44 minutes past 2 o'clock, p.m., and recorded in Volume 9 of Short Plats at page 2682, records of Skagit County, Wa.
County Auditor of Skagit County
A.F.#

Legal Description

That part of Government Lot 2, Section 1, Township 34 North, Range 4 East, W.M., lying east of the Northern Pacific Railway right of way; EXCEPT the east 214.5 feet thereof; AND EXCEPT all railroad and county road rights of way; AND EXCEPT that portion of the premises conveyed to the county of Skagit by deed recorded under Auditor's File No. 673770.

Consent

Know all men by these presents that we the undersigned subd-
viders hereby certify that this short plat is made as our free
and voluntary act and deed.

Lawrence Petersma
Lawrence Petersma

Acknowledgements

State of Washington County of SKAGIT I certify that I know or
have satisfactory evidence that Lawrence Petersma signed
this instrument and acknowledged it to be his/her free and
voluntary act for the uses and purposes mentioned in the
instrument.

Notary signature John L. Abernethy Title _____
Date 7/5/90 My appointment expires Nov. 1, 1991

Treasurer's Certificate

This is to certify that all taxes heretofore levied and which
have become a lien on the lands herein described have been
fully paid and discharged according to the records of my
office up to and including the year 1990.

Judith M. Menich Oct. 1, 1990
Skagit County Treasurer Date

Approvals

The within and foregoing short plat is approved in accordance
with the provisions of the Skagit County Short Plat Ordinance
this 1 day of Oct 1990.

Short Plat Administrator
Mark D. Spahr
Public Works Director

LINE #	TABLE BEARING	DISTANCE
L1	N89°21'35"W	60.00'
L2	N89°21'35"W	10.06'

Legend

- Set 1/2" X 18" reinf. rod with yellow plastic cap marked "SKA SURV 17651" and white 2" X 2" witness stake, except as noted.

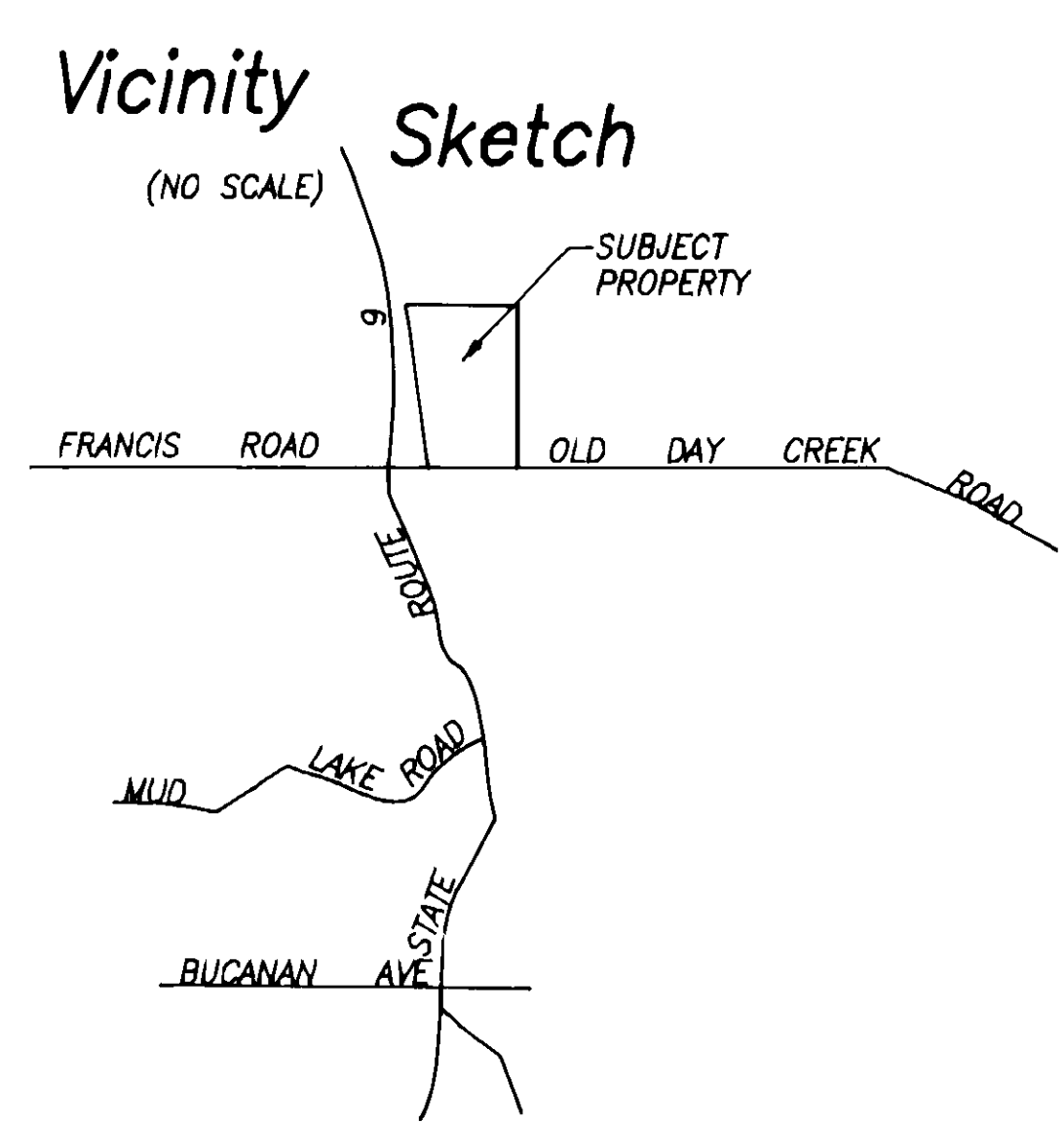

Short Plat for
Lawrence Petersma



INC. 330 Metcalf St., Sedro-Woolley, WA 98284, (206) 855-2121

ABANDONED BNRR. LOCATION CALCULATED FROM SHORT PLAT 98-75, RECORDED IN VOL. 1, PAGE 77.

E-W CENTERLINE BEARING DETERMINED FROM WEIGHED MEAN BEARING OF SOUTH LINE OF SECTION

CALCULATED FROM 1916 SURVEY BY SKAGIT COUNTY RECORDED IN FIELD BOOK 70 PAGE 35. THIS POSITION CHECKS GOOD WITH THE POSITION SHOWN ON THE PLAT OF WEST ADDITION TO CLEARLAKE IN VOL. 4 PAGE 32 AND ALSO CHECKS GOOD WITH A 1909 SURVEY BY JOHN MEEHAN IN SECTION 3. NOTHING FOUND, POSITION FALLS IN FIELD.

FOUND CONC. MON. W/ BRASS CAP IN CASE & COVER ON 4/29/81

FOUND IRON PIPE W/ BRASS CAP ON 11/5/90

Notes

- Short plat number and date of approval shall be included in all deeds and contracts.
- All maintenance and construction of private roads shall be the responsibility of the lot owners.
- Zoning - Rural Intermediate (RI)
- Water - Skagit County Public Utility District No. 1
- Sewer - Individual on-site sewage systems.
- Basis-of-bearings - S 88°53'55"E on the north line of the Northeast quarter of Section 1.
- This survey is based on a description contained in Titor Title Company of Skagit County, Certificate for Short Plat, Order No. H-78481, dated June 27, 1989 together with Quitclaim Deed filed in A.F.# 8805200003.
- This survey was accomplished by field traverse using:
2 second digital electronic Total Station, and/or
6 second optical micrometer Total Station, and/or
6 second scale reading Theodolite with top-mount EDM
- Leanto portion of the existing shed to be removed.

Vol 9 Short Plats Pg 268