

Survey in the NE $\frac{1}{4}$ of Section 13, Twp. 35 N., Rng. 4 E., W.M.

Short Plat No. SW-01-89
Date 1-31-1989

Legal Description

The East 15 rods of the South 15 rods of the Southeast quarter of the Northeast quarter of Section 13, Township 35 North, Range 4 East W.M. EXCEPT the South 141 $\frac{1}{2}$ feet of the East 157 $\frac{1}{2}$ feet thereof, AND EXCEPT State Highway right of way.

Consent

Know all men by these presents that we the undersigned subdividers hereby certify that this short plat is made as our free and voluntary act and deed.

John R. Norbeck Phyllis L. Norbeck
John R. Norbeck Phyllis L. Norbeck
Pamela S. Barnes
Washington Mutual Savings Bank

Acknowledgements

State of Washington County of SKAGIT
I certify that I know or have satisfactory evidence that John R. & Phyllis L. Norbeck signed this instrument and acknowledged it to be his/her free and voluntary act for the uses and purposes mentioned in the instrument.
Notary signature John H. Regan
Title Notary Public Date 1-19-89
My appointment expires July 1, 1990

State of Washington County of Skagit
I certify that I know or have satisfactory evidence that Pamela S. Barnes signed this instrument, on oath stated that he/she was authorized to execute the instrument and acknowledged it as the officer of Washington Mutual to be the free and voluntary act of such party for the uses and purposes mentioned in the instrument.
Notary signature John H. Regan
Title Notary Public Date 1-9-89
My appointment expires 10-4-92

Treasurer's Certificate

This is to certify that all taxes heretofore levied and which have become a lien on the lands herein described have been fully paid and discharged according to the records of my office up to and including the year 1988.

Don Whinnel 1-31-89
Skagit County Treasurer Date

Approvals

The within and foregoing short plat is approved in accordance with the provisions of the Sedro-Woolley Subdivision Ordinance.

David L. Smith 2/1/89
Planning Commission Chairman Date

Legend

- Set $\frac{1}{2}$ " ϕ X 18" reinf. rod with yellow plastic cap marked "SKA SURV 17651" and white 2" X 2" witness stake, except as noted.

Short Plat for
John Norbeck

AUDITOR'S CERTIFICATE

Filed for record this 1st day of Feb 1989 at 24 minutes past 12 o'clock, and recorded in Volume 8 of SP at page 104 records of Skagit County, Wa.
Janet J. Thompson
County Auditor or Deputy Auditor



SURVEYOR'S CERTIFICATE
This map correctly represents a survey made by me or under my direction in conformance with the Surveying Act in January, 1989 at the request of John Norbeck
John Norbeck 1/16/89
CERT # 17651 Date

Skagit Surveyors INC.
330 Metcalf St., Sedro-Woolley, WA 98284, (206) 855-1882
2/21

FOUND 2" IRON PIPE ON PRIOR SURVEY SEE S.P. # SW 2-86

FOUND CONC. MON. ON PRIOR SURVEY SEE S.P. # SW 2-86

FOUND 1" X 1" STEEL ROD ON PRIOR SURVEY SEE S.P. # SW 2-86

FOUND 1" X 1" STEEL ROD ON PRIOR SURVEY SEE S.P. # SW 2-86

FOUND BRASS CAP ON PRIOR SURVEY SEE S.P. # SW 2-86

Notes

- Short plat number and date of approval shall be included in all deeds and contracts.
- All maintenance and construction of private roads shall be the responsibility of the lot owners.
- Zoning - Residential R-8.4
- Water - Public Utility District No. 1 of Skagit County.
- Sewer - City of Sedro-Woolley Sewer System.
- Basis of bearings - Short Plat filed in Vol. 7 of Short Plats on page 133.
- The nearest fire hydrant is at the corner of Marie Pl. and Highway 9 which is approximately 550 feet from this proposal.
- A 20' access & utility easement is hereby provided to lot 1 over, under and through the existing 20' access easement shown hereon. No other access to SR 9 from lot 1 will be allowed.
- A 7' easement is hereby dedicated along the east property line, adjoining Highway 9, for future utility, storm drainage and/or sidewalk improvements.

Vicinity

Map

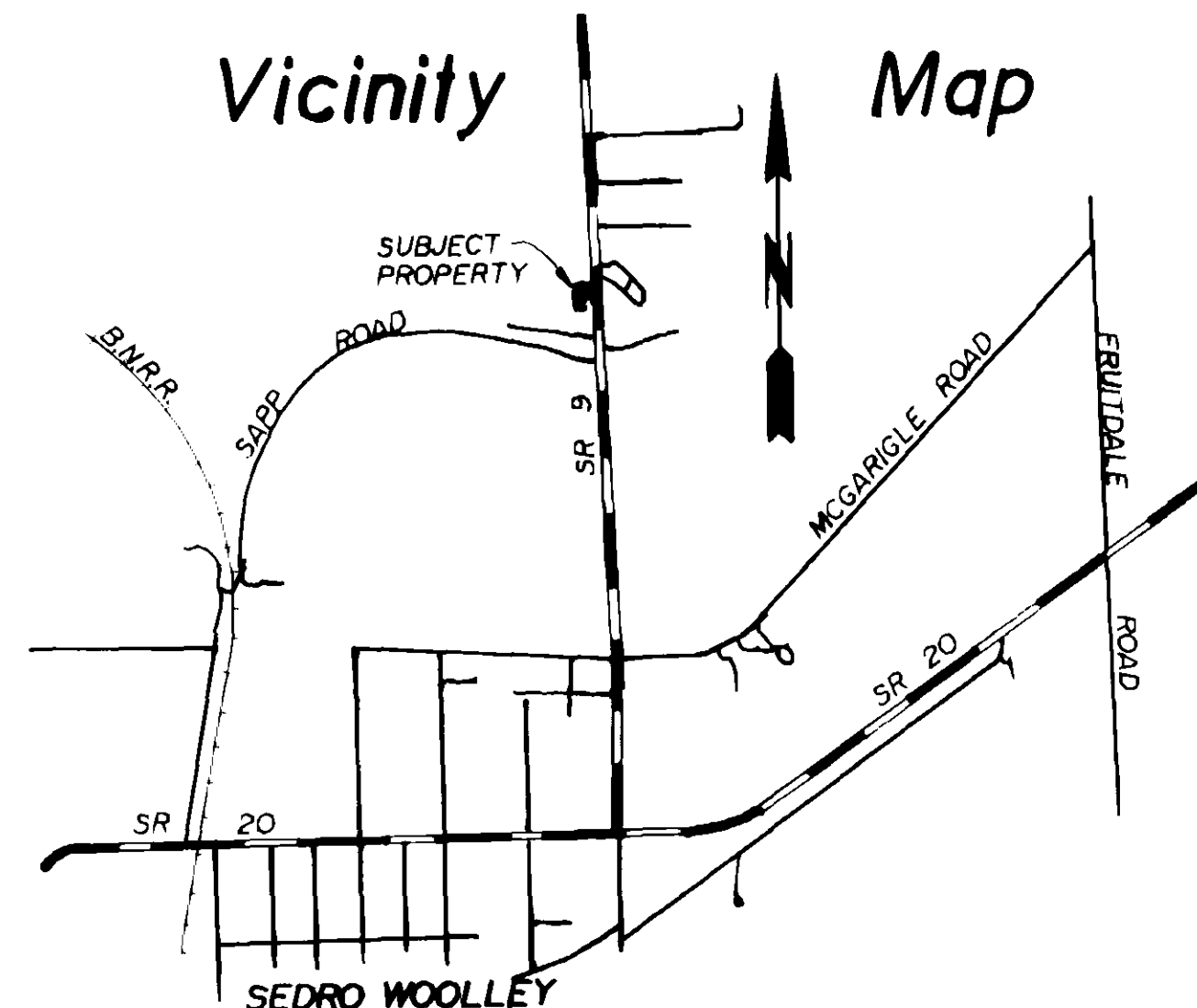

DATE	REVISION	BY	JOB #	DRAWN	CHECKED	DATE	SCALE	SHEET
			784-88	DCB	MWM	02JAN89	1" = 50'	1 of 1